

F.A.S. RTE.	SECTION	COUNTY	TOTAL SHEETS	SHEET NO.
601	(*)	PIKE	51	12
STA.		TO STA.		
FED. ROAD DIST. NO.		ILLINOIS FED. AID PROJECT		

(* 02-00077-00-RS

<p>PNT #44 9+06.38 23.09' LT</p> <p>"A" PP 54.8' "B" CMP 53.5' "C" EOP 5.6'</p>	<p>PNT #43 23+28.05 19.17' RT</p> <p>"A" LIGHT POLE 94.6' "B" PP 43.1' "C" EOP 7.4'</p>	<p>PNT #42 37+16.36 19.40' LT</p> <p>"A" CMP 126.0' "B" SIGN 101.6' "C" EOP 8.9'</p>	<p>PNT #41 49+95.51 33.11' RT</p> <p>"A" ROW MRKR 53.8' "B" PP 27.7' "C" CMP 9.2'</p>	<p>PNT #40 61+12.34 18.05' RT</p> <p>"A" WATER METER 106.7' "B" TELEPHONE PEDESTAL 76.5' "C" CMP 11.8'</p>	<p>PNT #39 74+11.15 23.02' RT</p> <p>"A" SIGN 106.7' "B" PP 76.5' "C" EOP 11.8'</p>	<p>PNT #38 83+08.48 35.47' RT</p> <p>"A" PP 110.4' "B" BACK OF GUTTER 95.8' "C" EOP 6.5'</p>
<p>PNT #37 90+05.34 19.22' RT</p> <p>"A" GUARDRAIL 110.4' "B" GUARDRAIL 95.8' "C" EOP 6.5'</p>	<p>PNT #36 99+53.78 20.26' LT</p> <p>"A" EOP 10.5' "B" ROW MRKR 33.9' "C" ROW MRKR 104.8'</p>	<p>PNT #35 107+00.80 16.64' LT</p> <p>"A" EOP 6.5' "B" WARNING SIGN 41.4' "C" ROW MRKR 72.5'</p>	<p>PNT #34 116+97.52 45.39' LT</p> <p>"A" EOP 34.2' "B" FENCE 3.2' "C" ROW MRKR 51.9'</p>	<p>PNT #33 125+00.00 18.44' RT</p> <p>"A" EOP 7.3' "B" SIGN 63.5' "C" ROW MRKR 73.9'</p>	<p>PNT #32 135+20.94 19.74' RT</p> <p>"A" BRIDGE RAIL 73.4' "B" END GUARDRAIL 41.3' "C" END GUARDRAIL 52.3'</p>	<p>PNT #31 146+98.53 39.24' LT</p> <p>"A" CMP 178.9' "B" EOP 27.9' "C" EDGE OF FIELD 2.9'</p>
<p>PNT #30 159+93.61 24.24' LT</p> <p>"A" CMP 177.6' "B" EOP 12.9' "C" EDGE OF FIELD 10.0'</p>	<p>PNT #29 173+93.36 36.27' RT</p> <p>"A" SIGN 103.7' "B" EOP 25.3' "C" EDGE OF FIELD 2.7'</p>	<p>PNT #27 187+48.60 22.75' RT</p> <p>"A" EOP 11.7' "B" PP 60.4' "C" SIGN POST 29.0'</p>	<p>PNT #26 199+91.69 21.54' RT</p> <p>"A" PP 120.5' "B" FENCE 29.3' "C" TELE PED 171.7'</p>	<p>PNT #25 213+16.68 19.27' LT</p> <p>"A" CMP 31.4' "B" CMP 13.7' "C" CMP 50.7'</p>	<p>PNT #24 243+18.75 24.48' RT</p> <p>"A" ROW MRKR 62.2' "B" CMP 12.5' "C" CMP 69.0'</p>	<p>PNT #22 243+18.75 24.48' RT</p> <p>"A" RCP FES 57.7' "B" RCP FES 19.4' "C" RCP FES 31.5'</p>

3R RESURFACING PROJECT ENDS STA. 243 + 51.14

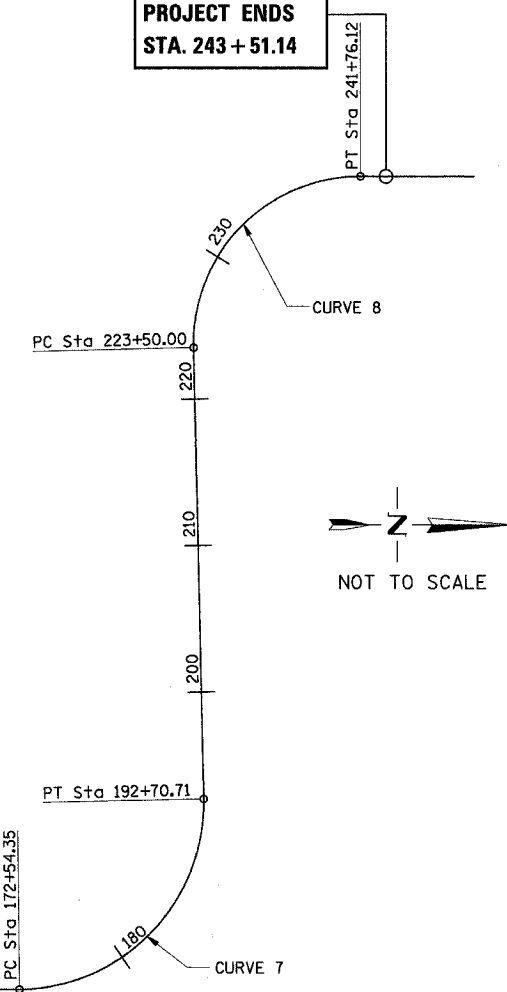

RESURFACING OMISSION STA. 31 + 62.86 TO STA. 33 + 17.94

RESURFACING OMISSION STA. 132 + 87.90 TO STA. 134 + 51.44

3R RESURFACING PROJECT BEGINS STA. 4 + 90.00

CONTROL POINTS						
PNT #	DESC.	STATION	OFFSET	ELEVATION	NORTHING	EASTING
44	IPIN	9+06.38	23.09' LT	306.65	91,005.188	118,167.725
43	IPIN	23+28.05	19.17' RT	285.71	92,426.767	118,213.790
42	IPIN	37+16.36	19.40' LT	257.75	93,815.039	118,172.876
41	IPIN	49+95.51	33.11' RT	293.05	95,094.296	118,222.909
40	IPIN	61+12.34	18.05' RT	298.48	96,211.246	118,192.092
39	IPIN	74+11.15	23.02' RT	292.85	97,509.958	118,175.094
38	IPIN	83+08.48	35.47' RT	284.56	98,396.568	118,019.584
37	IPIN	90+05.34	19.22' RT	279.32	98,856.359	117,488.164
36	IPIN	99+53.78	20.26' LT	291.03	98,942.291	116,544.735
35	IPIN	107+00.80	16.64' LT	288.28	99,276.215	115,877.990
34	IPIN	116+97.52	45.39' LT	309.86	100,197.166	115,512.327
33	IPIN	125+00.00	18.44' RT	301.92	100,995.678	115,614.376
32	IPIN	135+20.94	19.74' RT	264.82	102,017.646	115,621.752
31	IPIN	146+98.53	39.24' LT	266.09	103,193.904	115,536.855
30	IPIN	159+93.61	24.24' LT	268.54	104,489.193	115,539.476
29	IPIN	173+93.36	36.27' RT	276.29	105,893.052	115,579.089
27	IPIN	187+48.60	22.75' RT	281.63	106,937.940	114,768.940
26	IPIN	199+91.69	21.54' RT	274.01	107,016.689	113,529.244
25	IPIN	213+16.68	19.27' LT	274.19	106,946.497	112,205.481
24	IPIN	227+89.76	34.34' LT	279.10	106,984.540	110,729.051
22	IPIN	243+18.75	24.48' RT	283.36	108,231.790	110,025.215

ie consultants
INTERNATIONAL ENGINEERING CONSULTANTS, INC.
8420 SOUTH SIXTH STREET
SPRINGFIELD, ILLINOIS 62707
TEL: (217) 529-8027
FAX: (217) 529-4543
IESPRINGFIELD@IE-CONSULTANTS.COM
WWW.IE-CONSULTANTS.COM

CONTROL POINTS AND TIES			
DRAWN BY:	CHECKED BY:	DATE:	PROJECT:
RG	CMS	12-10-03	S03012

FILE: G:\S03012\CAD\3012A12A102.DGN 12/10/03 12:16:05 PM