

F.A.S. RTE.	SECTION	COUNTY	TOTAL SHEETS	SHEET NO.
601	(*)	PIKE	51	15
STA. 18+50		TO STA. 32+00		
FED. ROAD DIST. NO.		ILLINOIS	FED. AID PROJECT	

(\*) 02-00077-00-RS

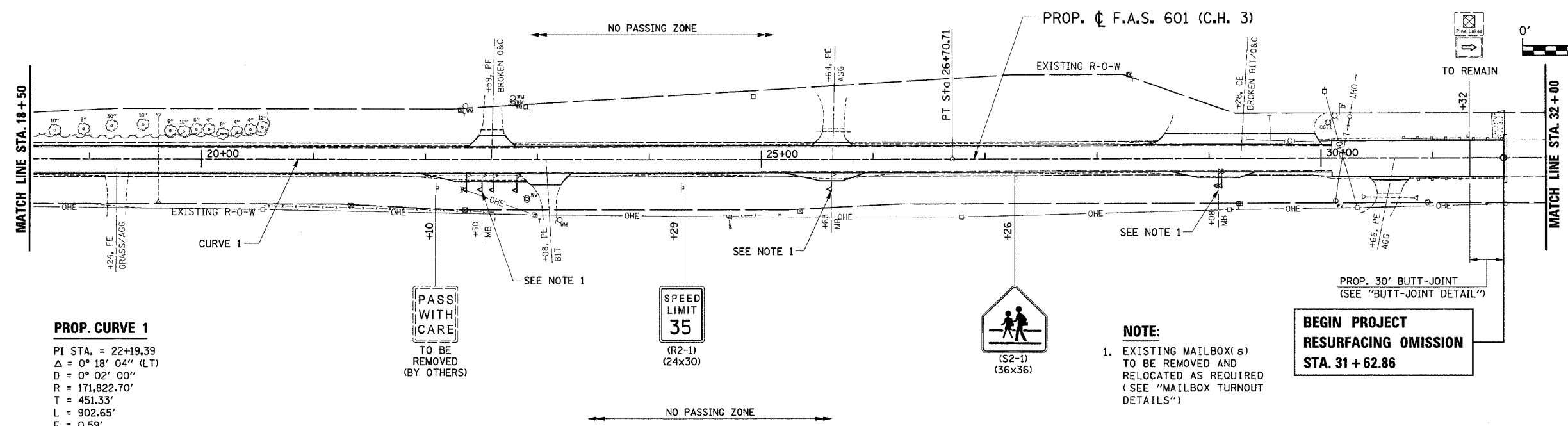
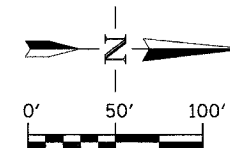

**PROP. CURVE 1**  
 PI STA. = 22+19.39  
 $\Delta = 0^\circ 18' 04''$  (LT)  
 $D = 0^\circ 02' 00''$   
 $R = 171,822.70'$   
 $T = 451.33'$   
 $L = 902.65'$   
 $E = 0.59'$   
 P.C. STA. = 17+68.06  
 P.T. STA. = 26+70.71  
 NORMAL CROWN

**NOTE:**  
 1. EXISTING MAILBOX(S) TO BE REMOVED AND RELOCATED AS REQUIRED (SEE "MAILBOX TURNOUT DETAILS")

**BEGIN PROJECT RESURFACING OMISSION STA. 31 + 62.86**

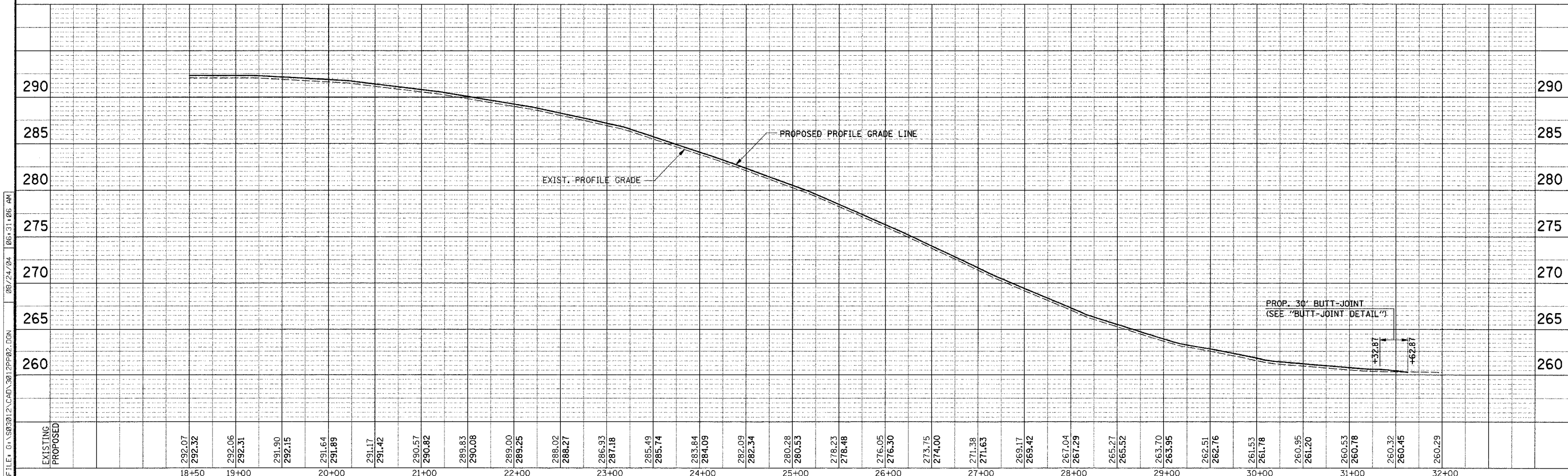

PLAN AND PROFILE - STA. 18+50 TO STA. 32+00

FILE: G:\903012\CAD\3012PP02.DGN 08/24/04 06:31:06 AM