

F.A.S. RTE.	SECTION	COUNTY	TOTAL SHEETS	SHEET NO.
601	(*)	PIKE	51	32
STA. 231+00		TO STA. 243+51.14		
FED. ROAD DIST. NO.		ILLINOIS FED. AID PROJECT		

(*) 02-00077-00-RS

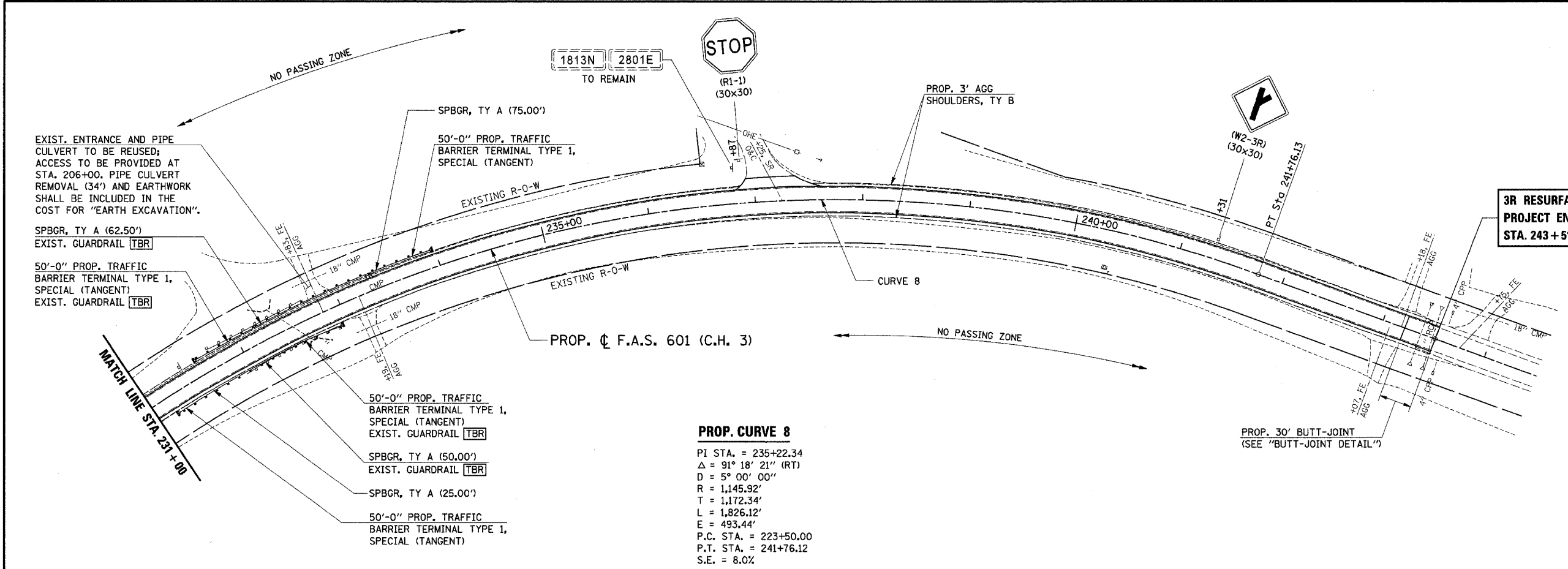
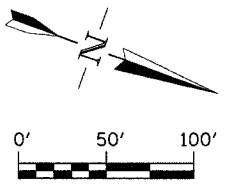

PROP. CURVE 8

PI STA. = 235+22.34
 $\Delta = 91^\circ 18' 21''$ (RT)
 $D = 5^\circ 00' 00''$
 $R = 1,145.92'$
 $T = 1,172.34'$
 $L = 1,826.12'$
 $E = 493.44'$
 P.C. STA. = 223+50.00
 P.T. STA. = 241+76.12
 S.E. = 8.0%

3R RESURFACING PROJECT ENDS STA. 243 + 51.14

NOTE:
 1. SEE "SCHEDULE OF QUANTITIES" FOR GUARDRAIL LOCATIONS.

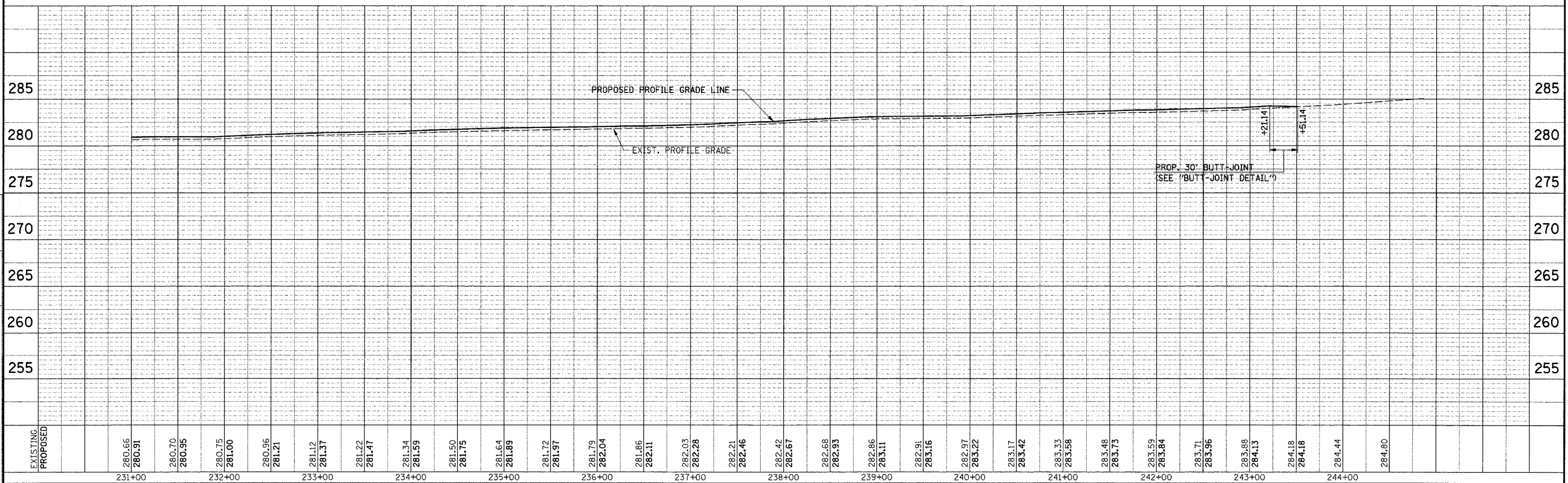

FILE: G:\S03012\CAD\3012PP18.DGN 12/10/03 11:08:20 AM

PLAN AND PROFILE - STA. 231+00 TO STA. 243+51.14