

REVISIONS

Sheppard Morgan & Schwaab, Inc.
CONSULTING ENGINEERS & LAND SURVEYORS
10 Central Industrial Dr
Northlake Center
Granite City, IL 60040
618/977-8700

SMS ENGINEERS

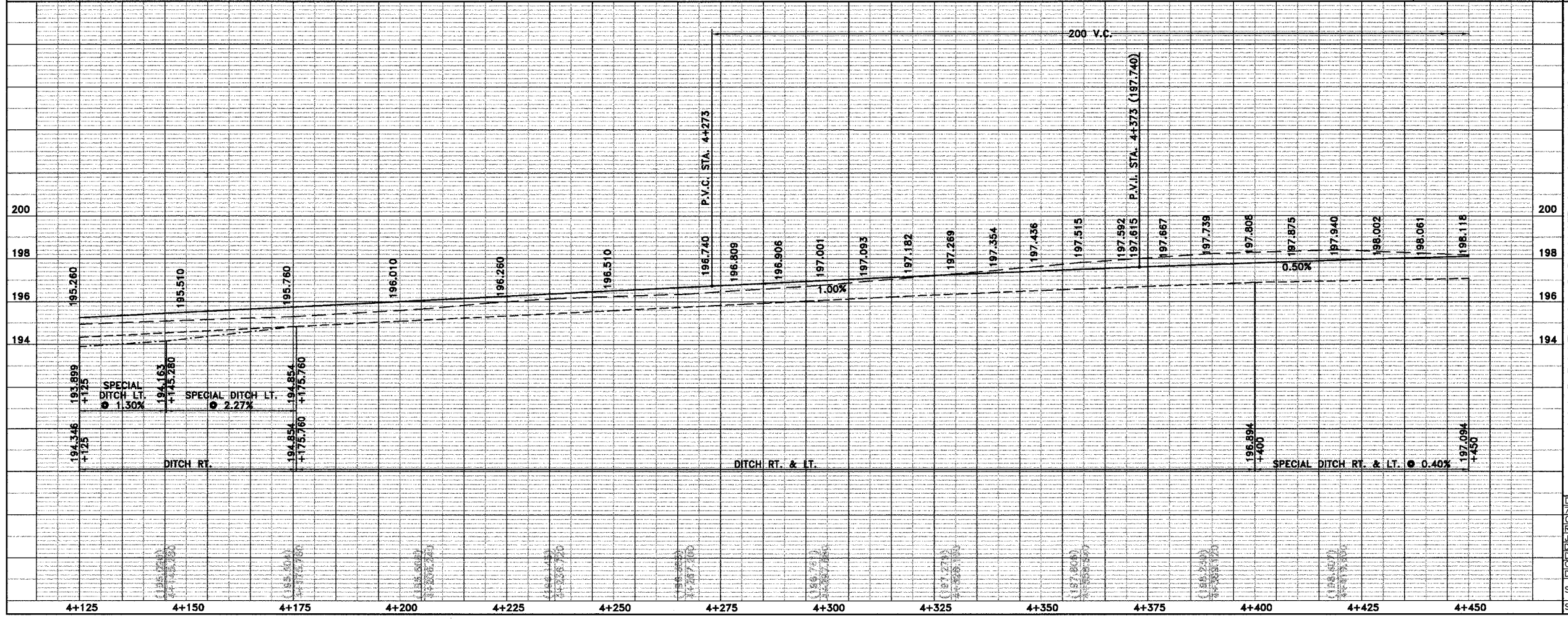

B.M.: R.R. SPIKE IN P.P. @ INTER.
STA. 4+218.737 - 7.925 RT.
ELEV. 198.386

MACOUPIN COUNTY, ILLINOIS
SECTION 92-00068-01-FP
FAS ROUTE 735 (SHIPMAN ROAD)
PLAN & PROFILE

DWG. NO. 735-PP14 DWG ACAD
REF. BY: FAS RTE, 735
JOB NO. 455048
DSN. BY: D.E.G.
DWN. BY: CAD
CHK. BY: D.E.G.
DATE: OCTOBER, 2004
SCALE: 1 : 500
SHEET 14 OF 58