

N.W. 1/4 SEC. 36-8-9

ALICE J. MATLOCK  
BK. 523 - PG. 93

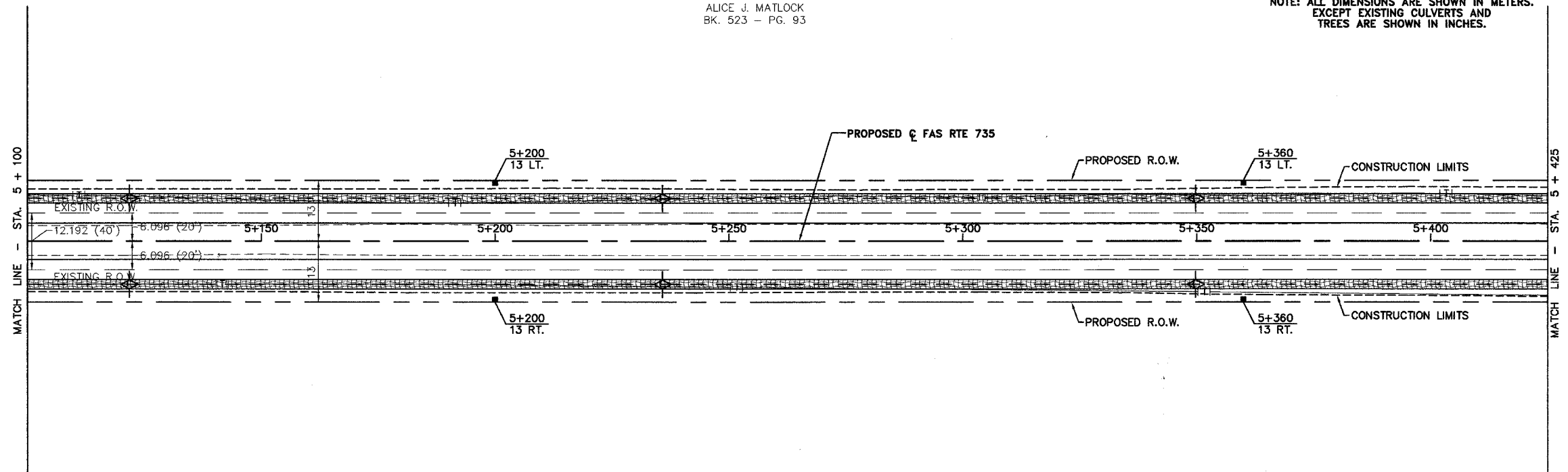
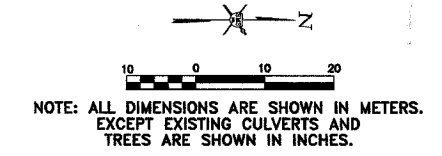

CHARLES W. SCHOENEMAN, TRUSTEE  
BK. 535 - PG. 251

N.E. 1/4 SEC. 36-8-9

B.M.: R.R. SPIKE, N.W. ROOT,  
24" TREE  
STA. 5+851.550 - 6.706 LT.  
ELEV. 195.124

REVISIONS

Sheppard Morgan & Schwaab, Inc.  
CONSULTING ENGINEERS & LAND SURVEYORS  
10 Central Industrial Dr  
Northgate Center  
Grenada City, IL 62040  
618/677-8700

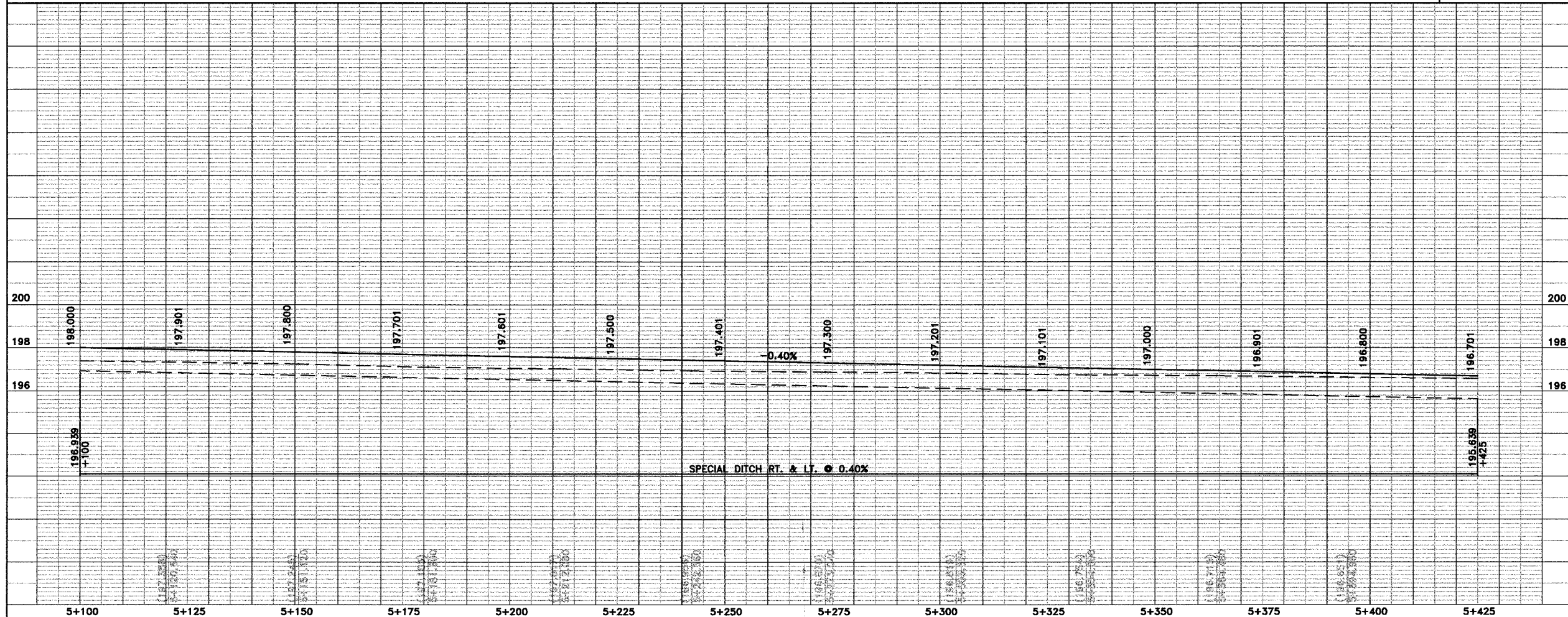

MACOUPIN COUNTY, ILLINOIS  
SECTION 92-00068-01-FP  
FAS ROUTE 735 (SHIPMAN ROAD)  
PLAN & PROFILE

DWG. NO.  
735-PP17 .DWG ACAD  
COGO FILE -  
REF. BK. FAS RTE. 735  
JOB NO. 455048  
DSN. BY: D.E.G.  
DWN. BY: CAD  
CHK. BY: D.E.G.  
DATE: OCTOBER, 2004  
SCALE: 1 : 500  
SHEET 17 OF 58