

NOTE: ALL DIMENSIONS ARE SHOWN IN METERS.  
EXCEPT EXISTING CULVERTS AND  
TREES ARE SHOWN IN INCHES.

N.E. 1/4 SEC. 36-8-9

S.E. 1/4 SEC. 25-8-9

B.M.: R.R. SPIKE, N.W. ROOT,  
24" TREE  
STA. 5+851.550 - 6.706 LT.  
ELEV. 195.124

WATERWAY INFORMATION - STA. 5+841.507

DRAINAGE AREA =	55.847 HA.
EXISTING OPENING =	0.584 M <sup>2</sup>
PROPOSED OPENING =	3.520 M <sup>2</sup>
30 YEAR DESIGN DISCHARGE =	3.34 CMS
PROPOSED 30 YEAR HEAD WATER ELEV. =	194.450 M
100 YEAR DISCHARGE =	4.36 CMS
PROPOSED 100 YEAR HEAD WATER ELEV. =	194.620 M

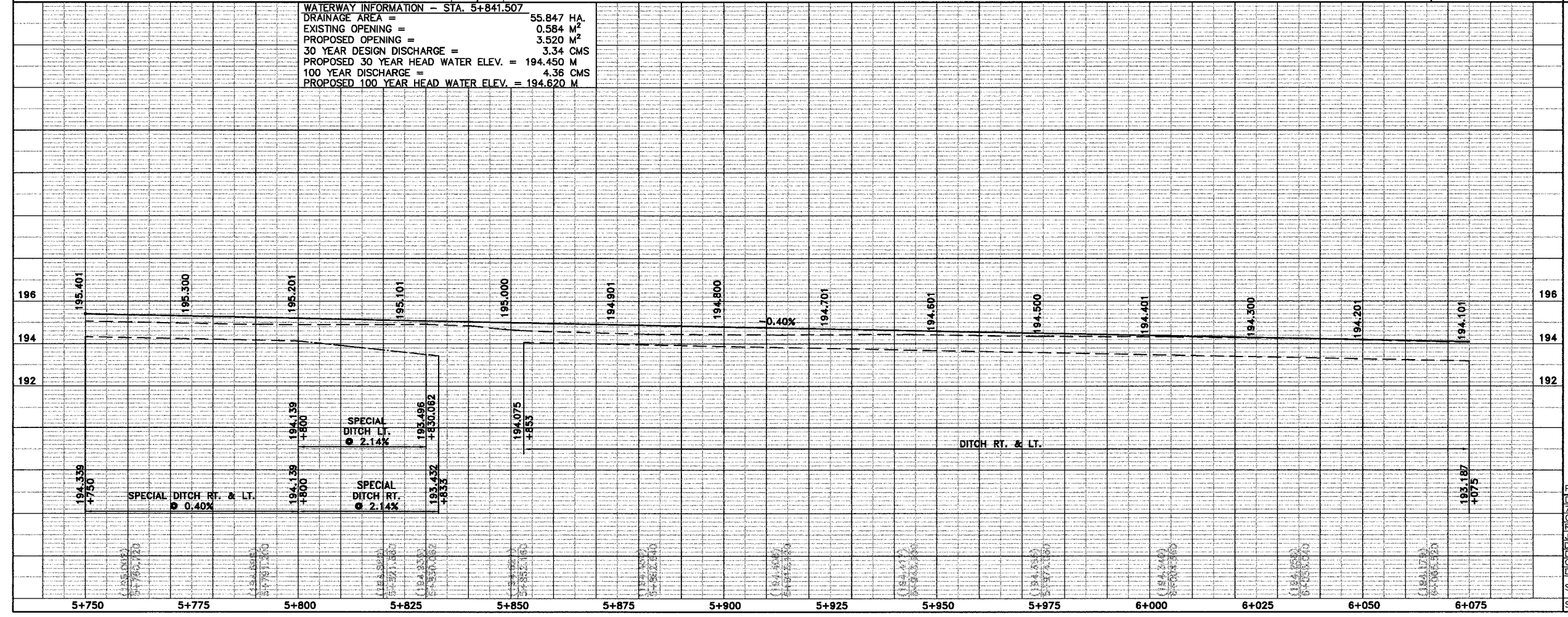

REVISIONS

Sheppard Morgan & Schwaab, Inc.  
CONSULTING ENGINEERS & LAND SURVEYORS  
10 Central Industrial Dr  
Northgate Center  
Granite City, IL 62040  
618/677-8765



MACOUPIN COUNTY, ILLINOIS  
SECTION 92-00068-01-FP  
FAS ROUTE 735 (SHIPMAN ROAD)  
PLAN & PROFILE

PHASE II  
DWG. NO. 735-PP19 DWG ACAD  
COGO FILE  
REF. BK. FAS RTE. 735  
JOB NO. 455048  
DSM. BY: D.E.G.  
DWN. BY: CAD  
CHK. BY: D.E.G.  
DATE: OCTOBER, 2004  
SCALE: 1:500  
SHEET 19 OF 58