

ROUTE NO.	SECTION	COUNTY	TOTAL SHEETS	SHEET NO.
F.A.S. 1870	03-00136-00-BR	JACKSON	20	3
FED. ROAD DIST. NO.	ILLINOIS	FED. AID PROJECT		

CONTRACT NO. 99203

LEGEND

- ① BITUMINOUS CONCRETE SURFACE COURSE, SUPERPAVE, MIX "C", N70 (1 1/2")
- ② BITUMINOUS CONCRETE BINDER COURSE, SUPERPAVE, IL-19.0, N70 (VARIABLE DEPTH)
- ③ AGGREGATE SHOULDERS, TYPE B, 6"
- ④ STEEL PLATE BEAM GUARD RAIL
- ⑤ EXISTING BITUMINOUS PAVEMENT ON AGGREGATE BASE
- ⑥ BITUMINOUS SURFACE REMOVAL - BUTT JOINT
- ⑦ BITUMINOUS MATERIALS TACK COAT
- ⑧ 4" PAINT PAVEMENT MARKING
- ⑨ LEVELING BINDER (MACHINE METHOD), SUPERPAVE, N70 (3/4")

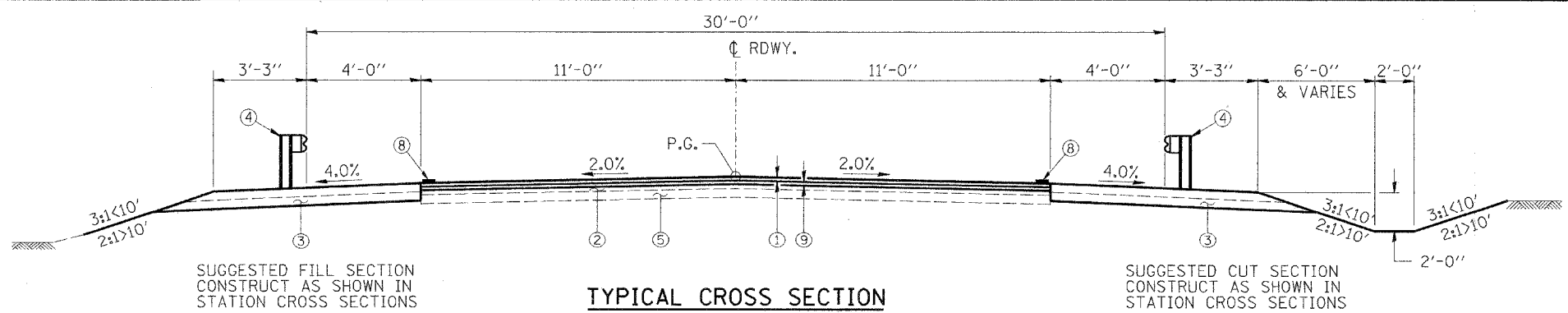

TYPICAL CROSS SECTION

STA. 7+00 TO STA. 9+56.54
 STA. 10+51.46 TO STA. 12+41.90
 TRANSITION FROM PROPOSED ROADWAY TO THE EXISTING ROADWAY IS TO BE CONSTRUCTED FROM STA. 7+00 TO STA. 7+50 AND FROM STA. 12+50 TO STA. 13+00. SEE SHEET 12 FOR TRANSITION AT BRIDGE.

NOTES

THE CONTRACTOR SHALL SAW CUT THE EXISTING SURFACE PRIOR TO BITUMINOUS SURFACE REMOVAL AT THE PAVEMENT TRANSITIONS. THE COST OF SAWCUTTING SHALL BE INCLUDED IN THE BID PRICE FOR BITUMINOUS SURFACE REMOVAL - BUTT JOINT.

PAVEMENT DESIGN DATA

DESIGN PERIOD: 20 YEARS 1270 (2014)
 STRUCTURAL DESIGN TRAFFIC (S.D.T.) =
 P.V. = 93% S.U. = 5% M.U. = 2%
 ROAD/STREET CLASSIFICATION: CLASS III
 PERCENT OF S.D.T. IN DESIGN LANE:
 P=50% S=50% M=50%
 TRAFFIC FACTOR: ACTUAL T.F. = 0.14
 MINIMUM T.F. = 0
 P.G. GRADE BINDER = PG 64-22
 P.G. GRADE SURFACE = PG 64-22
 SUBGRADE SUPPORT RATING = POOR

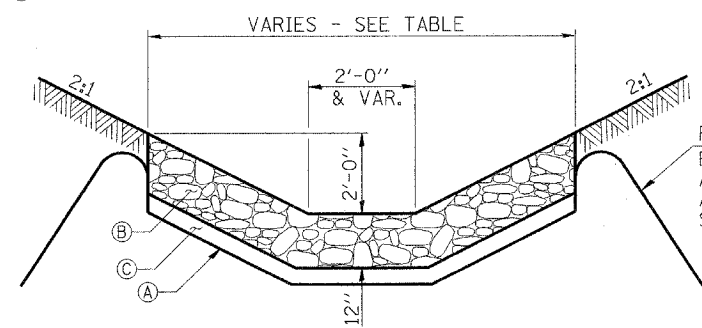

AGGREGATE DITCH - LINING DETAIL

LEGEND

- (A) FILTER FABRIC FOR RIPRAP
- (B) STONE RIPRAP CLASS A4
- (C) BEDDING MATERIAL

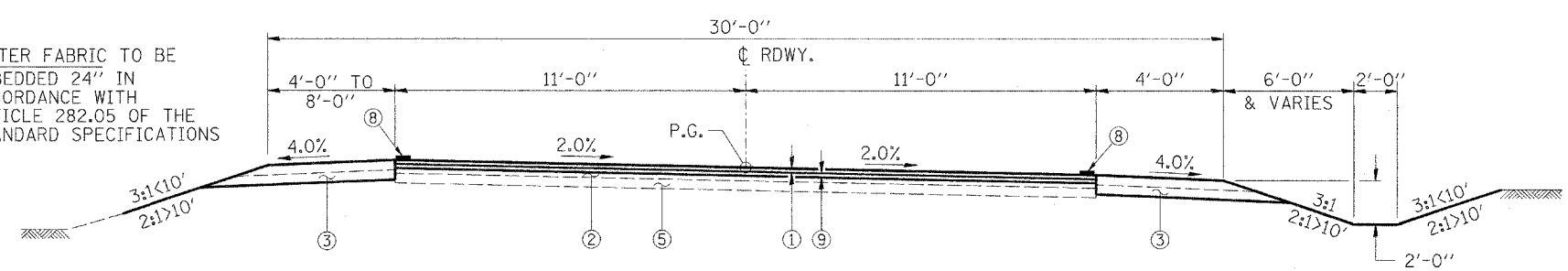

TYPICAL CROSS SECTION

STA. 12+41.90 TO STA. 13+00

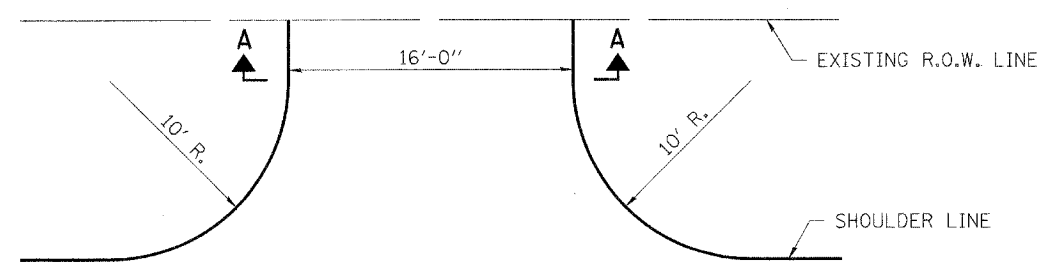

FIELD ENTRANCE DETAIL

STA. 12+77 - 23 TONS AGG. SURF. CSE., TYPE B, 6"

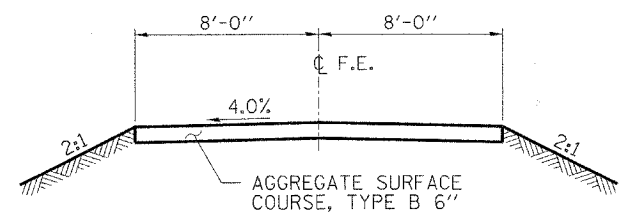

SECTION A-A

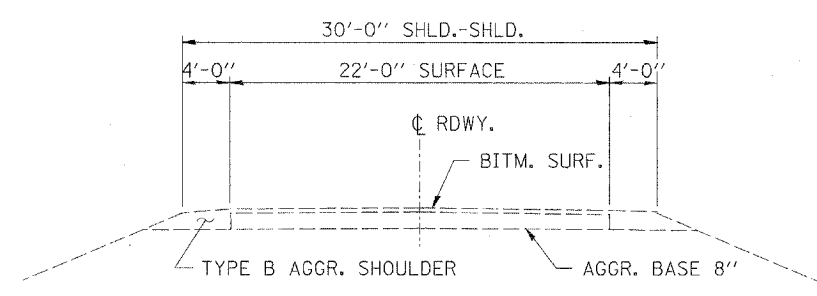

EXISTING CROSS SECTION

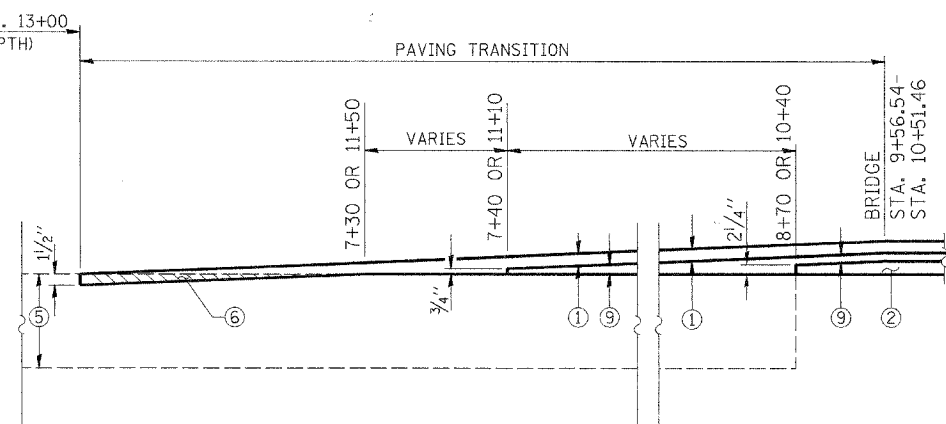

PAVEMENT TRANSITION DETAIL

MIXTURE REQUIREMENTS	
LOCATION(S):	FAS 1870 / C.H. 7 STA. 7+00 TO 13+00
MIXTURE USE(S):	SURFACE COURSE
AC/PG:	PG 64-22
RAP % (MAX):	15
DESIGN AIR VOIDS:	4.0%, 70 GYRATION SUPERPAVE DESIGN
MIXTURE COMPOSITION: (GRADATION MIXTURE):	IL-9.5 mm OR IL-12.5 mm
FRICTION AGGREGATE:	MIXTURE C
MIXTURE WEIGHT:	112 LBS./SQ. YD./INCH

MIXTURE REQUIREMENTS	
LOCATION(S):	FAS 1870 / C.H. 7 STA. 7+00 TO 13+00
MIXTURE USE(S):	LEVELING BINDER MM
AC/PG:	PG 64-22
RAP % (MAX):	15
DESIGN AIR VOIDS:	4.2%, 70 GYRATION SUPERPAVE DESIGN
MIXTURE COMPOSITION: (GRADATION MIXTURE):	IL-9.5L
FRICTION AGGREGATE:	NONE
MIXTURE WEIGHT:	112 LBS./SQ. YD./INCH

MIXTURE REQUIREMENTS	
LOCATION(S):	FAS 1870 / C.H. 7 STA. 7+00 TO 13+00
MIXTURE USE(S):	BINDER COURSE
AC/PG:	PG 64-22
RAP % (MAX):	15
DESIGN AIR VOIDS:	4.0%, 70 GYRATION SUPERPAVE DESIGN
MIXTURE COMPOSITION: (GRADATION MIXTURE):	IL-19.0
FRICTION AGGREGATE:	NONE
MIXTURE WEIGHT:	112 LBS./SQ. YD./INCH

HLR
 Rice, Berry and Associates
 A Division of Hampton, Lenzini and Renwick, Inc.
 Civil & Structural Engineers
 801 S. Durkin Drive
 Springfield, Illinois 62704
 217-546-3400
 P.O. Box 1036
 DuQuoin, Illinois 62832
 618-790-4637
 Account Number 12-47-0016-1
 Date: 10-27-04
 DESIGNED: L.F.S. CHECKED: S.W.M. DRAWN: D.B.

TYPICAL CROSS SECTIONS

F.A.S. 1870 / C.H. 7
 SECTION 03-00136-00-BR
 JACKSON COUNTY