

DATE	
BY	
REVISIONS	
PLANNING	
DESIGN	
CONSTRUCTION	
NO.	

DATE	
BY	
REVISIONS	
PROFILING	
DESIGN	
CONSTRUCTION	
NO.	

PAVEMENT REMOVAL

BANNOCKBURN CORPORATE CENTER

WETLAND #1

EXIST. CL IL. RTE. 22

PROPOSED R.O.W.

EXISTING CL FROM ILLINOIS TOLLWAY CONTRACT # I-07-5223

EXISTING R.O.W.

MATCHLINE STA. 52+00

PROPOSED R.O.W.

IL. ROUTE 22 IMPROVEMENT BEGINS STA. 45+50.89

COMB. CONC. CURB & GUTTER REMOVAL (TYPE B-6.24) (TYP.)

EXISTING R.O.W.

TRINITY COLLEGE ACCESS DR.

PAID AS COMB. CONC. CURB & GUTTER REMOVAL (TYPE B-6.24) (TYP.)

NOTE: ALL PROPOSED DRIVEWAYS SHALL BE BITUMINOUS UNLESS OTHERWISE SPECIFIED AS PORTLAND CEMENT CONCRETE ON THE PLAN SHEETS.

LAKESIDE DR.

EXISTING IL. ROUTE 22

PROPOSED P.C.C. SIDEWALK 7' WIDE, 5" THICK

PROP. COMB. CONC. CURB & GUTTER TYPE B-6.24 (TYP.)

PROPOSED CORRUGATED MEDIAN (TYP.)

BANNOCKBURN CORPORATE CENTER

PROP. SB-6.24 CONC. CURB & GUTTER BARRIER MEDIAN (TYP.)

PROPOSED R.O.W.

PROP. CL IL. RTE. 22

47+35.00 9.00' LT

49+00.00 9.00' LT

49+22.57 52.49' LT

49+69.51 52.49' LT

50+01.10 33.00' LT

50+07.21 5.00' RT

51+07.21 5.00' RT

51+57.21 5.00' RT

EXISTING CL FROM ILLINOIS TOLLWAY CONTRACT # I-07-5223

PROPOSED R.O.W.

45+50.89 33.00' LT

45+50.89 33.00' RT

47+35.00 3.00' LT

48+00.00 3.00' LT

48+91.19 33.00' LT

49+00.00 5.00' LT

48+98.82 33.00' RT

49+34.26 74.24' RT

49+21.92 56.24' RT

49+21.92 75.46' RT

49+21.92 98.43' RT

49+34.26 74.24' RT

49+21.92 98.43' RT

49+21.92 98.43' RT

49+21.92 98.43' RT

49+21.92 98.43' RT

49+21.92 98.43' RT

49+21.92 98.43' RT

49+21.92 98.43' RT

49+21.92 98.43' RT

49+00.00 5.00' LT

48+98.82 33.00' RT

50+07.21 9.00' RT

50+02.48 33.00' RT

49+80.78 56.01' RT

49+80.78 75.46' RT

49+67.48 68.00' RT

49+67.58 74.03' RT

49+67.58 74.03' RT

49+67.58 74.03' RT

49+67.58 74.03' RT

49+67.58 74.03' RT

49+67.58 74.03' RT

49+67.58 74.03' RT

49+67.58 74.03' RT

49+67.58 74.03' RT

49+67.58 74.03' RT

49+67.58 74.03' RT

DETECTABLE WARNINGS

LAKESIDE DR.

PROPOSED IL. ROUTE 22

MATCHLINE STA. 52+00

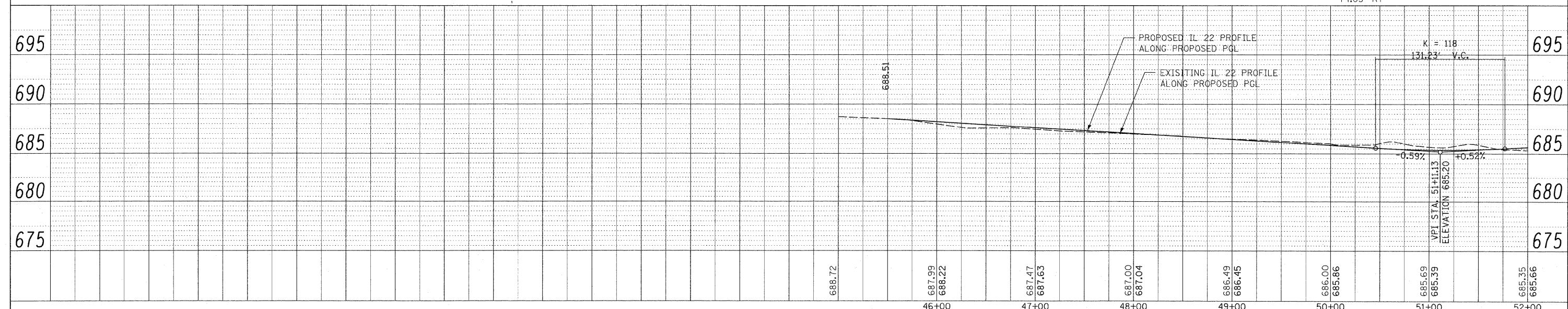

FILE NAME =	USER NAME = #USER#	DESIGNED - LP	REVISED -	<p align="center">STATE OF ILLINOIS DEPARTMENT OF TRANSPORTATION</p> <p align="center">IL. ROUTE 22 ROADWAY PLAN AND PROFILE</p>	F.A.P. R.T.E. =	SECTION	COUNTY	TOTAL SHEETS	SHEET NO.
W:\ILRTE22\2009 REVISIONS\CADD Sheets\DI	08860-shr-plnpr.f.dgn	DRAWN - DC	REVISED -		337	20R-4	LAKE	232	20
	PLOT SCALE = #SCALE#	CHECKED - JP	REVISED -		CONTRACT NO. 60860				
	PLOT DATE = 5/15/2010	DATE - 05/14/2010	REVISED -		ILLINOIS FED. AID PROJECT				