

* VARIES TO MAINTAIN MINIMUM LANE WIDTH AND CLEAR ZONE REQUIREMENTS

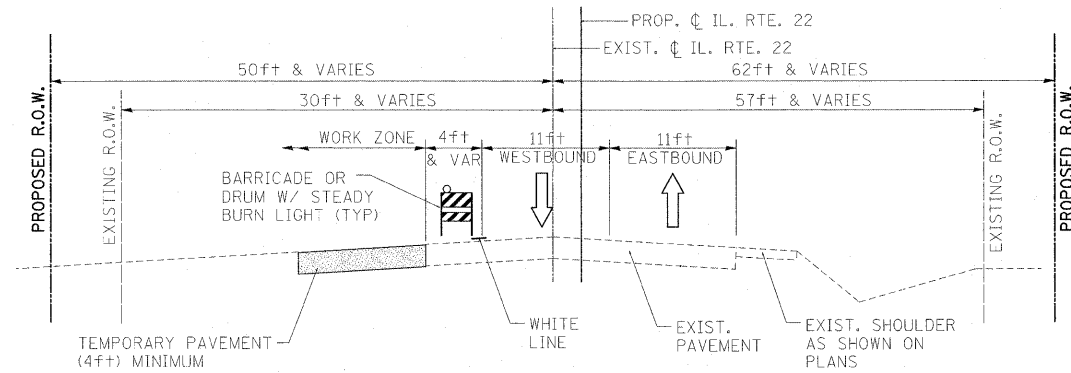

NOTE: CONSTRUCT TEMPORARY PAVEMENT FROM STA. ±56+32 TO STA. ±57+64 PRIOR TO STAGE I

STAGE 1
STA. ±46+48 TO STA. ±57+70

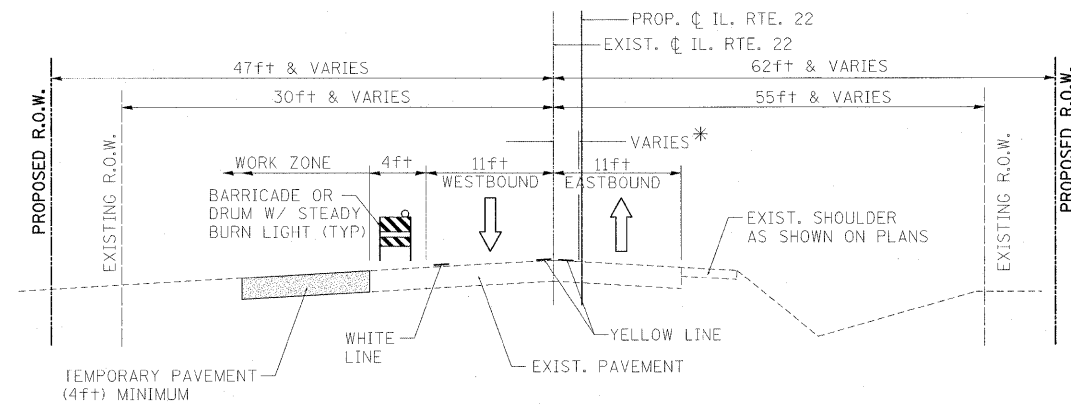

NOTE: 11ft LANES & A 3ft CLEAR ZONE ARE PROVIDED FROM STA. ±57+14 TO STA. ±70+28

STAGE 1
STA. ±57+64 TO STA. ±83+40

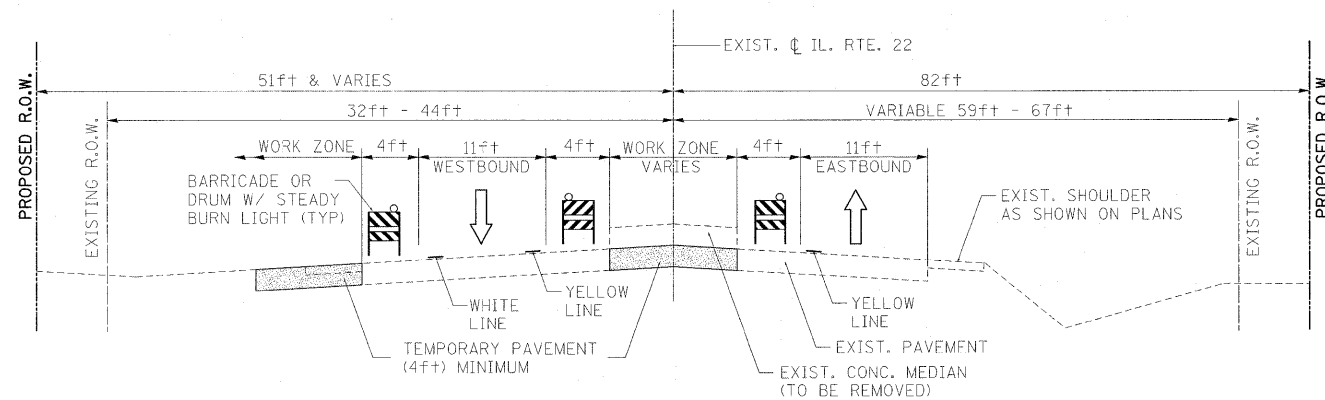

NOTE: 11ft LANES & A 3ft CLEAR ZONE ARE PROVIDED FROM STA. ±83+39+ TO STA. ±86+68

STAGE 1
STA. ±83+39 TO STA. ±88+32

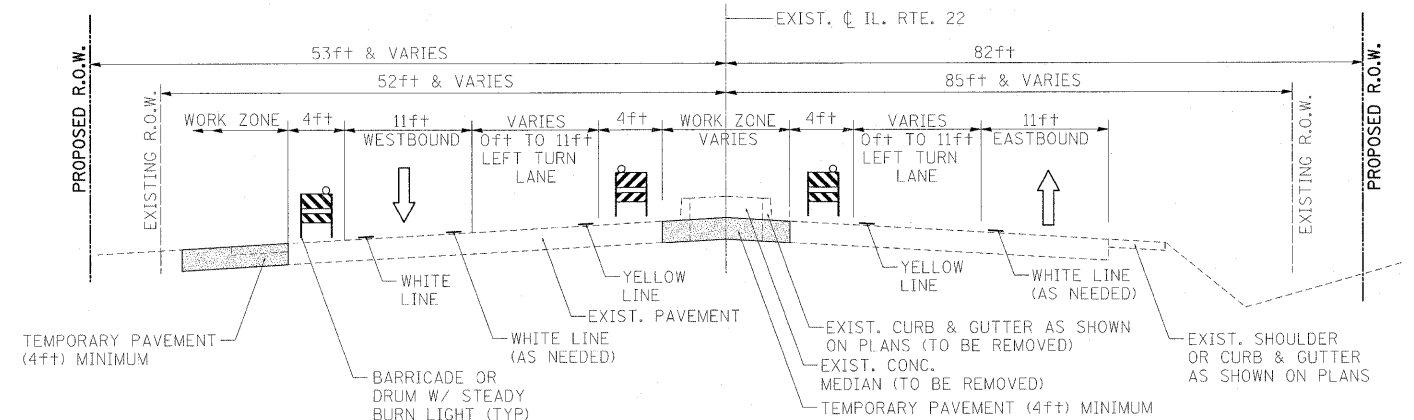

STAGE 1
STA. ±88+31 TO STA. ±115+13

PROJECT OMISSION: STA. 115+12.03 TO
STA. 139+09.88

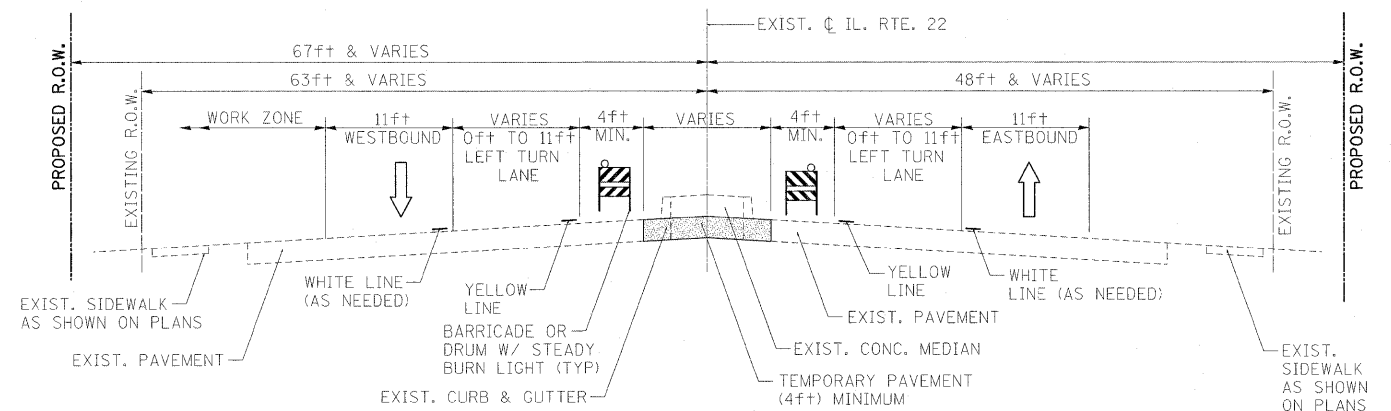

NOTE: BEYOND STA. ±149+01 NO WORK ZONE IS REQUIRED WESTBOUND LANES

STAGE 1
STA. ±149+01 TO STA. ±173+95

FILE NAME =	USER NAME = #USER#	DESIGNED - LP	REVISED -
W:\ILRTE22\2009\RFV\VISIONS\CADD Sheets	D160860-sh1-staging-typical.dgn	DRAWN - DC	REVISED -
	PLOT SCALE = #SCALE#	CHECKED - JP	REVISED -
	PLOT DATE = 5/15/2010	DATE - 05/14/2010	REVISED -

**STATE OF ILLINOIS
DEPARTMENT OF TRANSPORTATION**

**IL. ROUTE 22
MAINTENANCE OF TRAFFIC TYPICAL SECTIONS, STAGE 1**

SCALE: NTS SHEET NO. 35 OF 232 SHEETS STA. TO STA.

F.A.P. RTE.	SECTION	COUNTY	TOTAL SHEETS	SHEET NO.
337	20R-4	LAKE	232	35
CONTRACT NO. 60860				
[ILLINOIS] FED. AID PROJECT				