

LEGEND:

- PROPOSED MANHOLE
- PROPOSED CATCH BASIN
- PROPOSED STORM SEWER
- ▶ PROPOSED FLARED END SECTION
- EXISTING MANHOLE
- EXISTING CATCH BASIN
- ▽ EXISTING INLET
- ▶ EXISTING FLARED END SECTION
- EXISTING STORM SEWER
- - - EXISTING PIPE CULVERT



DATE	
BY	
PLAN	
SURVEYED	
PLOTTED	
NOTE BOOK	
NO.	
NO.	
NO.	
NO.	

DATE	
BY	
PROFILE	
SURVEYED	
PLOTTED	
NOTE BOOK	
NO.	
NO.	
NO.	
NO.	

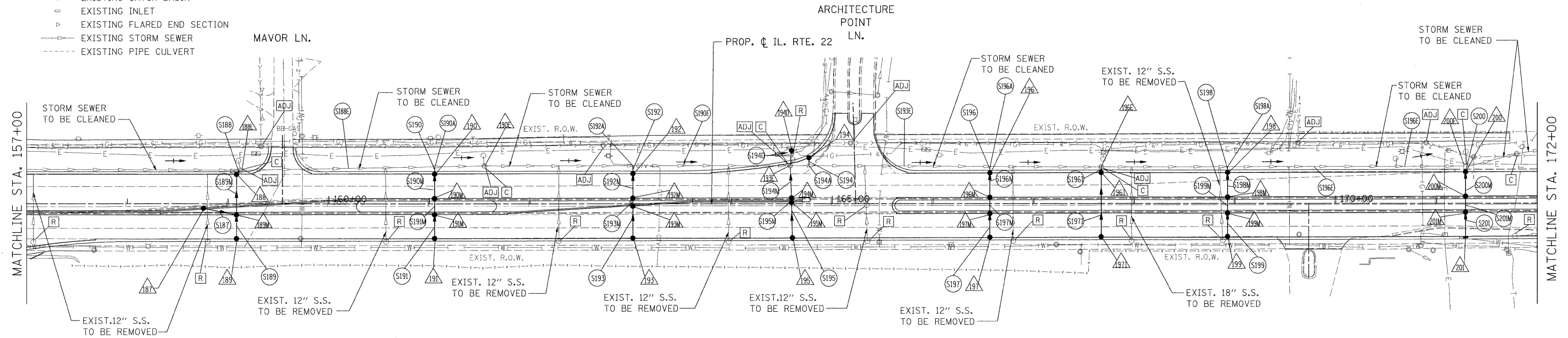

- ▲ PROPOSED STORM STRUCTURE
- PROPOSED STORM SEWER
- R EXISTING STRUCTURE TO BE REMOVED
- AB EXISTING STORM SEWER TO BE ABANDONED
- ADJ EXISTING STRUCTURE TO BE ADJUSTED
- C EXISTING STRUCTURE TO BE CLEANED

NOTE:
STORM WATER STRUCTURE OFFSET LOCATIONS GIVEN ON THE DETAILED PLANS ARE TO THE FOLLOWING POINTS: A) FOR STRUCTURES FALLING IN THE CURB LINE - TO THE EDGE OF PAVEMENT; B) FOR ALL OTHER STRUCTURE LOCATIONS - TO THE CENTER OF THE STRUCTURE.

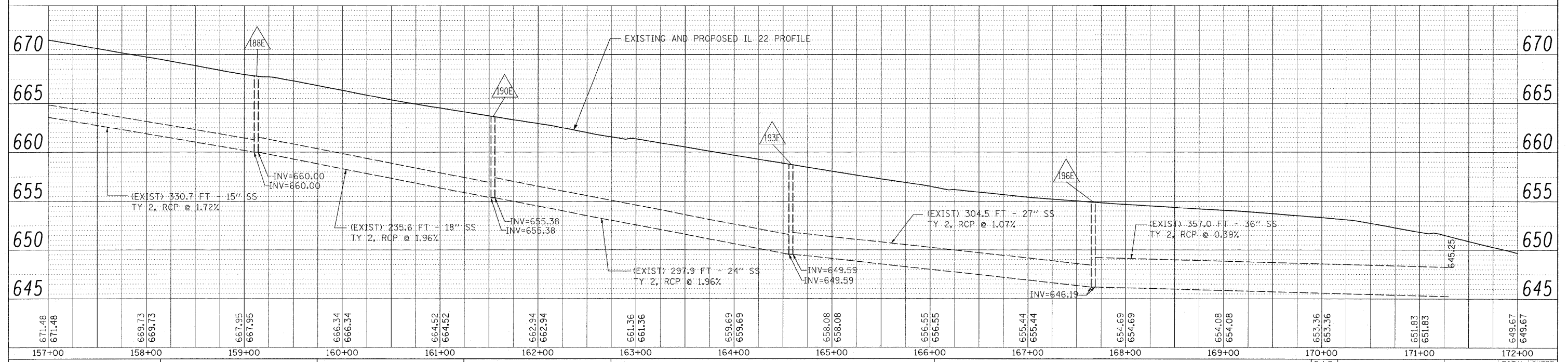

FILE NAME =	USER NAME = #USER#	DESIGNED - LP	REVISED -	STATE OF ILLINOIS DEPARTMENT OF TRANSPORTATION	IL. ROUTE 22 DRAINAGE PLAN AND PROFILE	F.A.P. RTE.	SECTION	COUNTY	TOTAL SHEETS	SHEET NO.	
W:\IL\ROUTE22\2009 REVISIONS\CADD Sheets\010000-01.dwg	09960-01.dwg	DRAWN - MC	REVISED -			337	20R-4	LAKE	232	100	
PLOT SCALE = #SCALE#		CHECKED - JP	REVISED -			CONTRACT NO. 60860					
PLOT DATE = 5/15/2010		DATE - 05/14/2010	REVISED -			[ILLINOIS] FED. AID PROJECT					