

F.A.P. RTE.	SECTION	COUNTY	TOTAL SHEETS	SHEET NO.
337	20R-4	LAKE	232	109A
STA.	TO STA.			
FED. ROAD DIST. NO.	ILLINOIS	FED. AID PROJECT		

CONTRACT NO. 60860

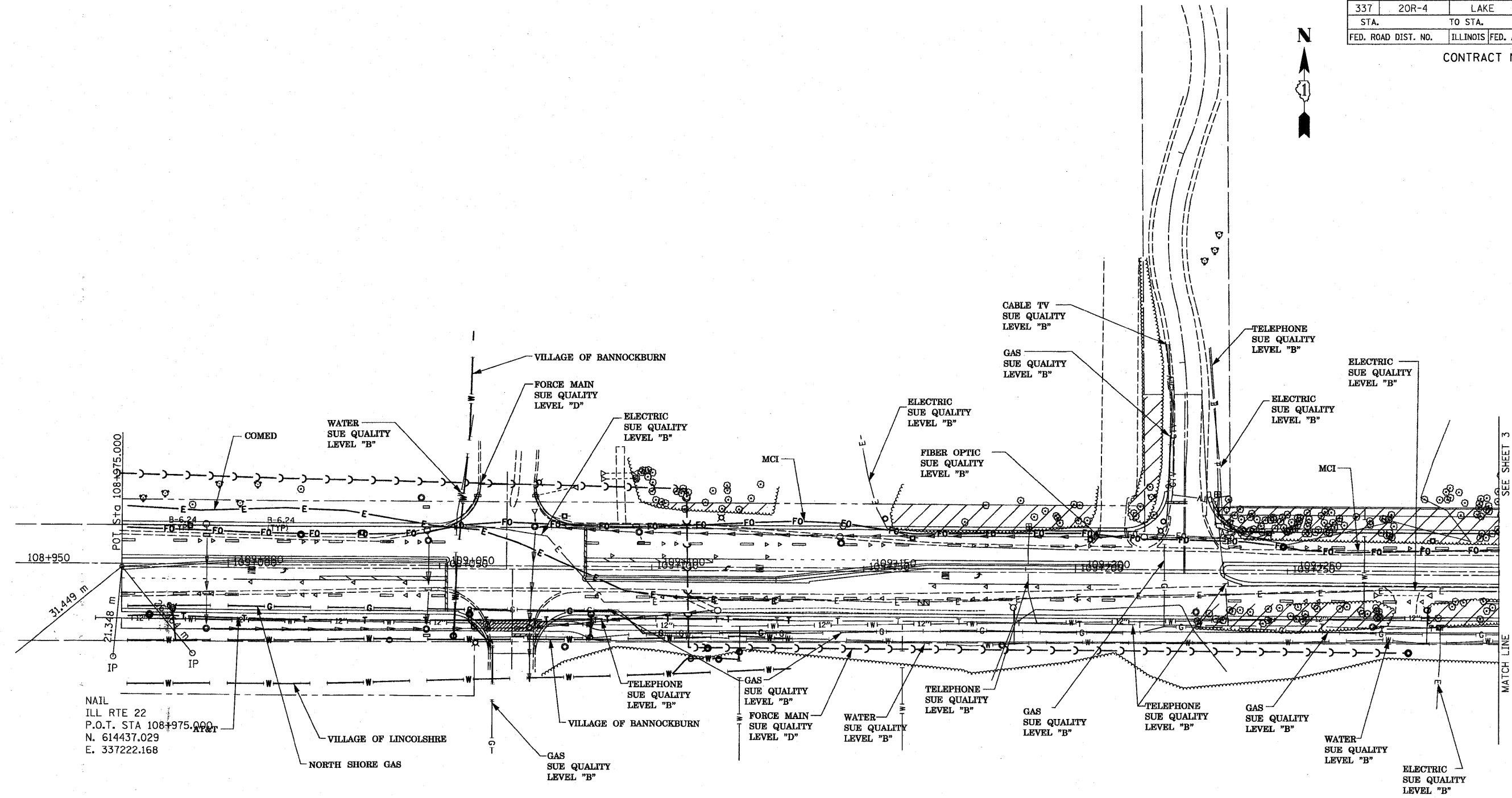

NAIL
ILL RTE 22
P.O.T. STA 108+975.000
N. 614437.029
E. 337222.168

— T — T —	TELEPHONE
— W — W —	WATER
— G — G —	GAS
— CTV — CTV — CTV	CABLE TELEVISION
— FO — FO — FO	FIBER OPTIC
— E — E —	ELECTRIC

FOR SUE INFORMATION ONLY

ILLINOIS PROFESSIONAL ENGINEERING
KENNETH F. SLANINKA, Jr.
062-055488
STATE OF ILLINOIS
7/29/10
license expires 11-30-11

TBE GROUP, INC.
CIVIL ENGINEERING * TRANSPORTATION * ENVIRONMENTAL
* PLANNING * UTILITY ENGINEERING/LOCATING
SOUTHERN REGION: FL, GA, SC, NC
NORTHERN REGION: IL, IN, MI, OH, MD, NJ, NY
PA, VA, CANADA
WESTERN REGION: AZ, NV, NM, TX, CA, OR, UT, WA
SUE Quality Level "B" Completed On: 3/20/02
Prepared By: JAC QA/QC By: RLC Final QA/QC By: KRC
TBE Project No: IL09500117, IL09510404, IL09510418



205 W. WACKER DRIVE
SUITE 1020
CHICAGO, IL 60606
(312) 704-1970

REVISIONS	
NAME	DATE
NEW UTILITIES IN COLOR	7/28/10

ILLINOIS DEPARTMENT OF TRANSPORTATION
IL RTE. 22
FROM EAST OF I-94 TO
WEST OF US-41
SCALE 1:500 (METRIC UNIT) DRAWN BY
DATE CHECKED BY