

THE TRAFFIC SIGNAL CONTROL EQUIPMENT FOR THIS PROJECT SHALL BE "ECONOLITE" TO MATCH THE EXISTING ADJACENT SYSTEM.

RESTORATION OF WORK AREA. RESTORATION OF THE TRAFFIC SIGNAL WORK AREA SHALL BE INCIDENTAL TO THE RELATED PAY ITEM SUCH AS FOUNDATION, CONDUIT, HANDHOLE, TRENCH AND BACKFILL, ETC., AND NO EXTRA COMPENSATION SHALL BE ALLOWED. ALL ROADWAY SURFACES SUCH AS SHOULDERS, MEDIANS, SIDEWALKS, PAVEMENT, ETC. SHALL BE REPLACED IN KIND. ALL DAMAGE TO MOWED LAWNS SHALL BE REPLACED WITH AN APPROVED SOD, AND ALL DAMAGE TO UNMOWED FIELDS SHALL BE SEEDED IN ACCORDANCE WITH STANDARD SPECIFICATIONS 252 AND 250 RESPECTIVELY.

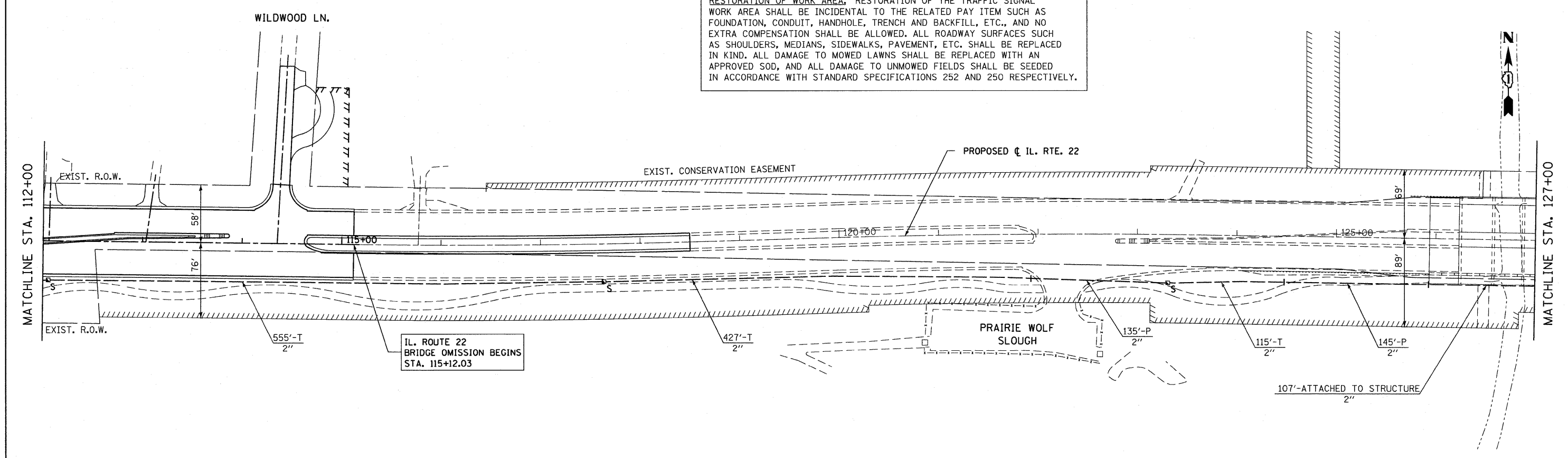

FILE NAME =	USER NAME = pccieoha	DESIGNED - LP	REVISED - 07/26/2010
W:\ILRTE22\2009 REVISIONS\CADD Sheets\	revised sheets\DI60860-sht-ts-INTER.dgn	DRAWN - DC	REVISED -
	PLOT SCALE = 50.000' / IN.	CHECKED - JP	REVISED -
	PLOT DATE = 7/28/2010	DATE - 05/14/2010	REVISED -

**STATE OF ILLINOIS  
DEPARTMENT OF TRANSPORTATION**

**IL. ROUTE 22  
INTERCONNECT PLAN (3 OF 6)**  
SCALE: 1"=50' SHEET NO. 166 OF 232 SHEETS STA. 97+00.00 TO STA. 127+00.00

F.A.P. RTE.	SECTION	COUNTY	TOTAL SHEETS	SHEET NO.
337	20R-4	LAKE	232	166
CONTRACT NO. 60860				
ILLINOIS FED. AID PROJECT				