

CONTRACTOR SHALL PROVIDE AN EROSION AND SEDIMENT CONTROL PLAN FOR CULVERT CLEANING. THE PLAN SHALL BE REVIEW AND RECEIVE WRITTEN APPROVAL BY THE RESIDENT ENGINEER, PRIOR TO STARTING ANY WORK WITHIN THIS AREA. THE COST OF ALL STORM SEWER CLEANING WORK ITEMS IN THIS AREA WILL NOT BE PAID FOR SEPARATELY, BUT SHALL BE CONSIDERED AS INCLUDED IN THE UNIT BID PRICES OF THE CONTRACT, AND NO ADDITIONAL COMPENSATION WILL BE ALLOWED. LACK OF APPROVED PLAN OR FAILURE TO COMPLY WILL RESULT IN AN ESC DEFICIENCY DEDUCTION.

- LEGEND**
- PERIMETER EROSION BARRIER
 - OUTLET FLOW
 - INLET PROTECTION
 - TEMPORARY DITCH CHECK
 - TEMPORARY EROSION CONTROL SEEDING
 - TEMPORARY MULCH
 - STONE RIP RAP WITH FILTER FABRIC

NOTE:
CONTRACTOR SHALL PROVIDE INLET PROTECTION TO ALL PROPOSED INLETS LOCATED WITHIN THE PROJECT LIMITS.

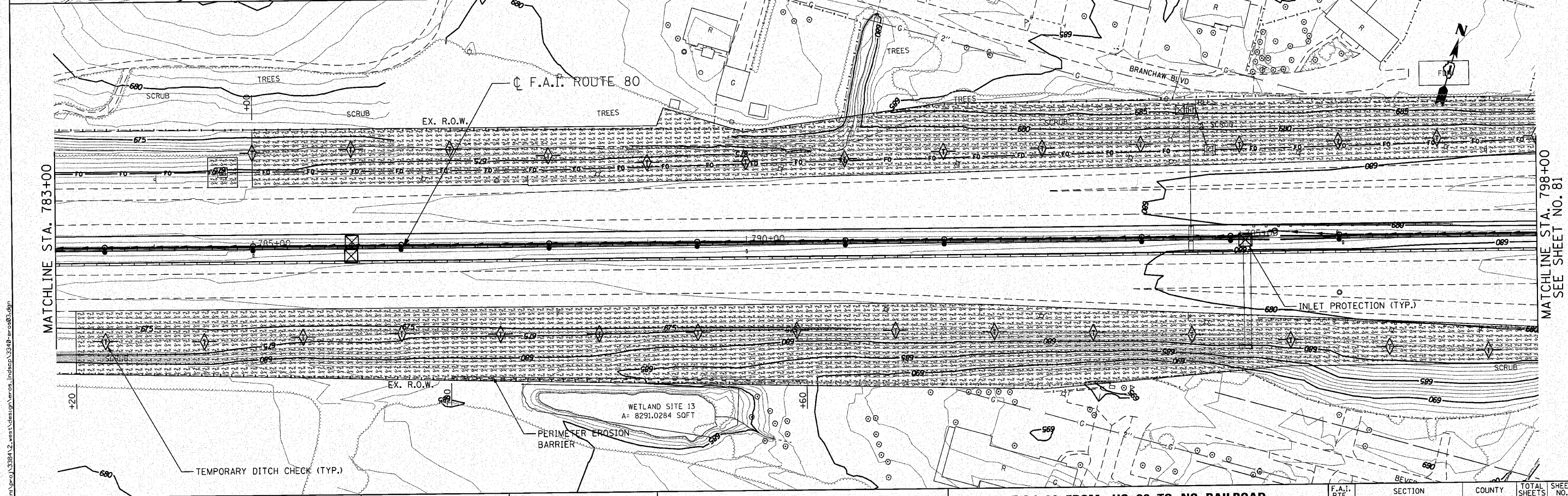

ENGINEERING CONSULTANT

Clorba Group, Inc.
 CONSULTING ENGINEERS
 2007 North Cass Street, Suite 402
 Chicago, Illinois 60658
 Tel: 773.778.6000 Fax: 773.778.4814
 Email: clorba@clorba.com

USER NAME = dmorr18
 PLOT SCALE = 50.0000' / IN.
 PLOT DATE = 12/6/2010

DESIGNED - CRC
 DRAWN - JMK
 CHECKED - MRJ
 DATE - 10/21/2010
 REVISED -
 REVISED -
 REVISED -
 REVISED -

**STATE OF ILLINOIS
 DEPARTMENT OF TRANSPORTATION**

**F.A.I. 80 FROM US 30 TO NS RAILROAD
 EROSION AND SEDIMENT CONTROL PLAN**
 SCALE: 1" = 50' SHEET NO. OF SHEETS STA. 768+00 TO STA. 798+00

F.A.I. RTE.	SECTION	COUNTY	TOTAL SHEETS	SHEET NO.
80	99-5-Y	WILL	276	80
			CONTRACT NO. 60147	
ILLINOIS FED. AID PROJECT				