

166-MH STA. 768+50/1.5' LT MANHOLES, TYPE A, 4'-DIA WITH TYPE 20 FRAME AND GRATE $\bar{r}=674.87$ INV.=668.44 (E)(W)(S)

168-MH STA. 770+00/1.5' LT MANHOLES, TYPE A, 4'-DIA WITH TYPE 20 FRAME AND GRATE $\bar{r}=675.11$ INV.=668.89 (W)(S)

170-MH STA. 771+50/1.5' LT MANHOLES, TYPE A, 6'-DIA WITH TYPE 20 FRAME AND GRATE $\bar{r}=675.34$ INV.=666.44 (E)(S)

172-MH STA. 773+00/1.5' LT MANHOLES, TYPE A, 6'-DIA WITH TYPE 20 FRAME AND GRATE $\bar{r}=675.54$ INV.=666.74 (E)(W)(S)

173-CB STA. 773+00/1.6' RT CATCH BASINS, TYPE A, 4'-DIA WITH TYPE 20 FRAME AND GRATE $\bar{r}=675.01$ INV.=666.79 (N)

174-MH STA. 774+50/1.5' LT MANHOLES, TYPE A, 6'-DIA WITH TYPE 20 FRAME AND GRATE $\bar{r}=676.07$ INV.=667.04 (E)(W)(S)

175-CB STA. 774+50/1.6' RT CATCH BASINS, TYPE A, 4'-DIA WITH TYPE 20 FRAME AND GRATE $\bar{r}=675.56$ INV.=667.09 (N)

176-MH STA. 776+00/1.5' LT MANHOLES, TYPE A, 6'-DIA WITH TYPE 20 FRAME AND GRATE $\bar{r}=676.19$ INV.=667.34 (E)(W)(S)

170A-MH STA. 771+00/1.5' LT MANHOLES, TYPE A, 6'-DIA WITH TYPE 20 FRAME AND GRATE $\bar{r}=675.52$ INV.=666.34 (E)(S)

167-CB STA. 768+50/1.6' RT CATCH BASINS, TYPE A, 4'-DIA WITH TYPE 20 FRAME AND GRATE $\bar{r}=674.26$ INV.=668.49 (N)

169-CB STA. 770+00/1.6' RT CATCH BASINS, TYPE A, 4'-DIA WITH TYPE 20 FRAME AND GRATE $\bar{r}=674.57$ INV.=668.94 (N)

171-CB STA. 771+50/1.6' RT CATCH BASINS, TYPE A, 4'-DIA WITH TYPE 20 FRAME AND GRATE $\bar{r}=674.84$ INV.=666.49 (N)

177-CB STA. 776+00/1.6' RT CATCH BASINS, TYPE A, 4'-DIA WITH TYPE 20 FRAME AND GRATE $\bar{r}=675.75$ INV.=667.39 (N)

170B-MH STA. 771+00/1.5' RT MANHOLES, TYPE A, 6'-DIA WITH TYPE 20 FRAME AND GRATE, RESTRICTOR PLATE ORIFICE SIZE =24" OVERFLOW= 669.44 $\bar{r}=675.02$ INV.=666.29 (N)(S)

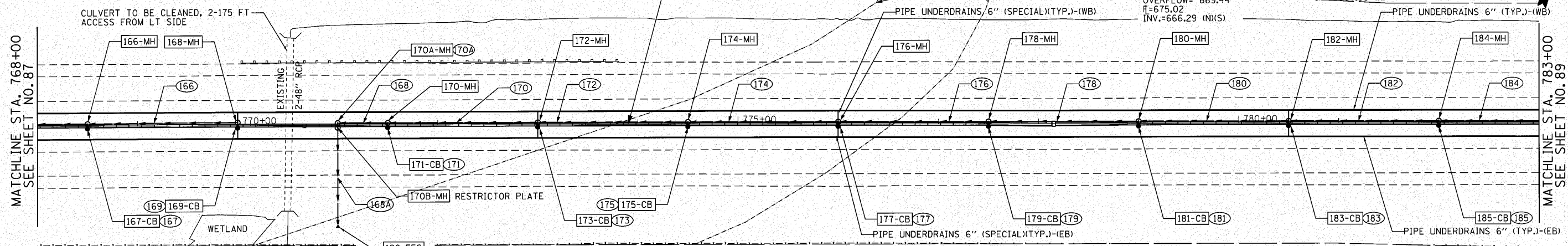

166 STORM SEWERS, CLASS A, TYPE 2, 15" 150' @ 0.30% TBF=52 CY

168 STORM SEWERS, CLASS A, TYPE 2, 48" 50' @ 0.00% TBF=54 CY

172 STORM SEWERS, CLASS A, TYPE 2, 48" 150' @ 0.20% TBF=148 CY

176 STORM SEWERS, CLASS A, TYPE 2, 48" 150' @ 0.20% TBF=144 CY

180 STORM SEWERS, CLASS A, TYPE 2, 48" 150' @ 0.20% TBF=142 CY

184 STORM SEWERS, CLASS A, TYPE 2, 36" 150' @ 0.33% TBF=146 CY

170A STORM SEWERS, CLASS A, TYPE 2, 48" 5' @ 1.00% TBF=1 CY

178-MH STA. 777+50/1.5' LT MANHOLES, TYPE A, 6'-DIA WITH TYPE 20 FRAME AND GRATE $\bar{r}=676.46$ INV.=667.64 (E)(W)(S)

180-MH STA. 779+00/1.5' LT MANHOLES, TYPE A, 6'-DIA WITH TYPE 20 FRAME AND GRATE $\bar{r}=676.74$ INV.=667.94 (E)(W)(S)

182-MH STA. 780+50/1.5' LT MANHOLES, TYPE A, 6'-DIA WITH TYPE 20 FRAME AND GRATE $\bar{r}=677.02$ INV.=668.24 (E)(W)(S)

184-MH STA. 782+00/1.5' LT MANHOLES, TYPE A, 5'-DIA WITH TYPE 20 FRAME AND GRATE $\bar{r}=677.23$ INV.=668.54 (E)(W)(S)

167, 169, 171, 173, 175, 177, 179, 181, 183, 185 STORM SEWERS, CLASS A, TYPE 2, 12" 5' @ 1.00%

170 STORM SEWERS, CLASS A, TYPE 2, 48" 150' @ 0.20% TBF=145 CY

174 STORM SEWERS, CLASS A, TYPE 2, 48" 150' @ 0.20% TBF=149 CY

178 STORM SEWERS, CLASS A, TYPE 2, 48" 150' @ 0.20% TBF=143 CY

182 STORM SEWERS, CLASS A, TYPE 2, 36" 150' @ 0.20% TBF=151 CY

168A STORM SEWERS JACKED IN PLACE, 42" 96' @ 0.29%

120-FES STA. 771+00/98.7' RT PRECAST REINFORCED CONCRETE FLARED END SECTIONS, 42" INV.=666.00

179-CB STA. 777+50/1.6' RT CATCH BASINS, TYPE A, 4'-DIA WITH TYPE 20 FRAME AND GRATE $\bar{r}=676.06$ INV.=667.69 (N)

181-CB STA. 779+00/1.6' RT CATCH BASINS, TYPE A, 4'-DIA WITH TYPE 20 FRAME AND GRATE $\bar{r}=676.32$ INV.=667.99 (N)

183-CB STA. 780+50/1.6' RT CATCH BASINS, TYPE A, 4'-DIA WITH TYPE 20 FRAME AND GRATE $\bar{r}=676.60$ INV.=668.29 (N)

185-CB STA. 782+00/1.6' RT CATCH BASINS, TYPE A, 4'-DIA WITH TYPE 20 FRAME AND GRATE $\bar{r}=676.84$ INV.=668.59 (N)

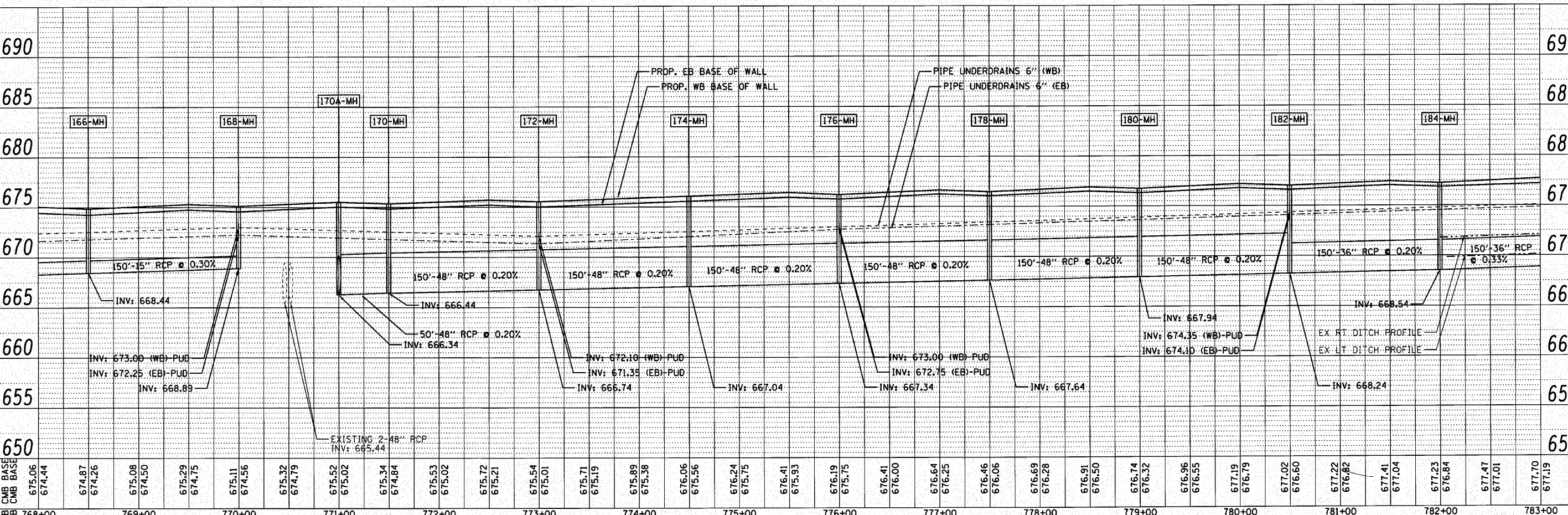

ENGINEERING CONSULTANT	USER NAME = dmorr1s	DESIGNED - CRC	REVISED -	STATE OF ILLINOIS DEPARTMENT OF TRANSPORTATION	F.A.I. 80 FROM US 30 TO NS RAILROAD PROPOSED DRAINAGE PLAN AND PROFILE	SCALE: 1" = 50'	SHEET NO. 88 OF SHEETS	STA. 768+00 TO STA. 783+00	F.A.I. SECTION	COUNTY	TOTAL SHEETS	SHEET NO.	
Giorga Group, Inc. CONSULTING ENGINEERS	PLOT SCALE = 5/8" = 1' / IN.	DRAWN - JMK	REVISED -						80	99-5-Y	WILL	276	88
5507 North Cumberland Avenue, Suite 402 Chicago, Illinois 60630 Tel: 773.778.4000 Fax: 773.778.4014 Email: cengr@giorgagroup.com	PLOT DATE = 12/6/2010	CHECKED - MRJ	REVISED -						CONTRACT NO. 60147				
	DATE = 10/27/2010	DATE	REVISED -						ILLINOIS FED. AID PROJECT				