

243-MH STA. 828+75/3.2' LT MANHOLES, TYPE A, 5'-DIA WITH TYPE 20 FRAME AND GRATE \bar{H} =695.69 INV.=686.47 (E)(W)(S)

244-CB STA. 828+75/2.8' RT CATCH BASINS, TYPE A, 4'-DIA WITH TYPE 20 FRAME AND GRATE \bar{H} =695.61 INV.=686.55 (N)

245-MH STA. 830+50/1.7' LT MANHOLES, TYPE A, 5'-DIA WITH TYPE 20 FRAME AND GRATE \bar{H} =697.65 INV.=690.00 (E)(S) INV.=687.00 (W)

246-CB STA. 830+50/1.7' RT CATCH BASINS, TYPE A, 4'-DIA WITH TYPE 20 FRAME AND GRATE \bar{H} =697.66 INV.=690.05 (N)

247-MH STA. 833+00/1.5' LT MANHOLES, TYPE A, 5'-DIA WITH TYPE 20 FRAME AND GRATE \bar{H} =700.85 INV.=693.75 (E)(S) INV.=690.75 (W)

248-CB STA. 833+00/1.5' RT CATCH BASINS, TYPE A, 4'-DIA WITH TYPE 20 FRAME AND GRATE \bar{H} =700.90 INV.=693.80 (N)

249-MH STA. 835+50/1.5' LT MANHOLES, TYPE A, 5'-DIA WITH TYPE 20 FRAME AND GRATE \bar{H} =704.06 INV.=697.00 (E)(S) INV.=694.50 (W)

250-CB STA. 835+50/1.5' RT CATCH BASINS, TYPE A, 4'-DIA WITH TYPE 20 FRAME AND GRATE \bar{H} =704.03 INV.=700.05 (N)

251-MH STA. 838+00/1.5' LT MANHOLES, TYPE A, 5'-DIA WITH TYPE 20 FRAME AND GRATE \bar{H} =707.27 INV.=700.25 (E)(S) INV.=697.75 (W)

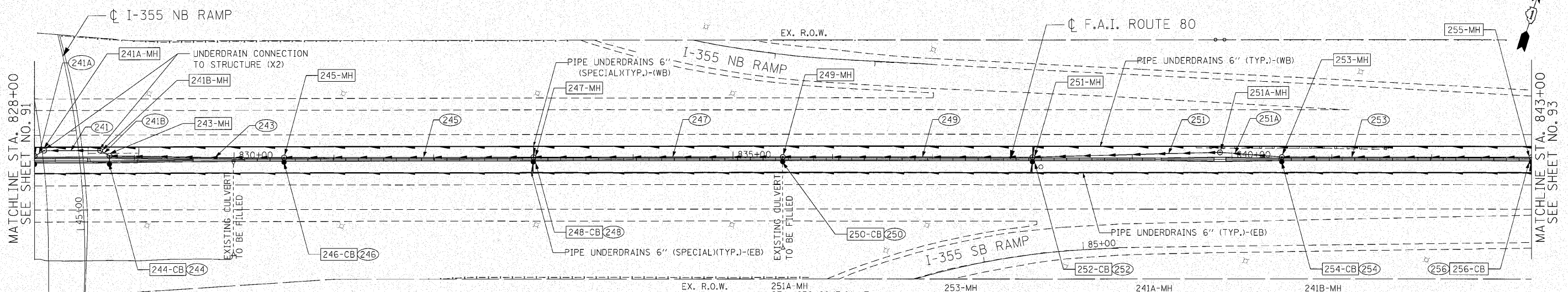

241 STORM SEWERS, CLASS A, TYPE 2, 42" 56' @ 0.32% TBF=63 CY

243 STORM SEWERS, CLASS A, TYPE 2, 42" 175' @ 0.30% TBF=228 CY

244 STORM SEWERS, CLASS A, TYPE 2, 12" 8' @ 1.00% TBF=8 CY

246, 248, 250, 252, 254, 256 STORM SEWERS, CLASS A, TYPE 2, 12" 5' @ 1.00% TBF=5 CY

245 STORM SEWERS, CLASS A, TYPE 2, 36" 250' @ 0.30% TBF=261 CY

247 STORM SEWERS, CLASS A, TYPE 2, 30" 250' @ 0.30% TBF=232 CY

249 STORM SEWERS, CLASS A, TYPE 2, 30" 188' @ 0.30% TBF=162 CY

251 STORM SEWERS, CLASS A, TYPE 2, 30" 250' @ 0.30% TBF=224 CY

253 STORM SEWERS, CLASS A, TYPE 2, 30" 250' @ 0.30% TBF=224 CY

241A STORM SEWERS, CLASS A, TYPE 2, 42" 11' @ 0.27% TBF=11 CY

241B STORM SEWERS, CLASS A, TYPE 2, 42" 11' @ 0.18% TBF=13 CY

251A-MH STA. 839+88/7.0' LT MANHOLES, TYPE A, 5'-DIA WITH TYPE 1 FRAME, CLOSED LID \bar{H} =709.89 INV.=700.81 (E)(W)

252-CB STA. 838+00/1.5' RT CATCH BASINS, TYPE A, 4'-DIA WITH TYPE 20 FRAME AND GRATE \bar{H} =707.25 INV.=700.30 (N)

253-MH STA. 840+50/1.5' LT MANHOLES, TYPE A, 5'-DIA WITH TYPE 20 FRAME AND GRATE \bar{H} =710.47 INV.=703.50 (E)(S) INV.=701.00 (W)

254-CB STA. 840+50/1.5' RT CATCH BASINS, TYPE A, 4'-DIA WITH TYPE 20 FRAME AND GRATE \bar{H} =710.43 INV.=703.55 (N)

241A-MH STA. 828+10/9.8' LT MANHOLES, TYPE A, 5'-DIA WITH TYPE 1 FRAME, CLOSED LID \bar{H} =695.40 INV.=686.27 (E)(W)

241B-MH STA. 828+66/9.8' LT MANHOLES, TYPE A, 5'-DIA WITH TYPE 1 FRAME, CLOSED LID \bar{H} =695.87 INV.=686.45 (E)(W)

255-MH STA. 843+00/1.5' LT MANHOLES, TYPE A, 5'-DIA WITH TYPE 20 FRAME AND GRATE \bar{H} =713.66 INV.=706.75 (E)(S) INV.=704.25 (W)

256-CB STA. 843+00/1.5' RT CATCH BASINS, TYPE A, 4'-DIA WITH TYPE 20 FRAME AND GRATE \bar{H} =713.63 INV.=706.80 (N)

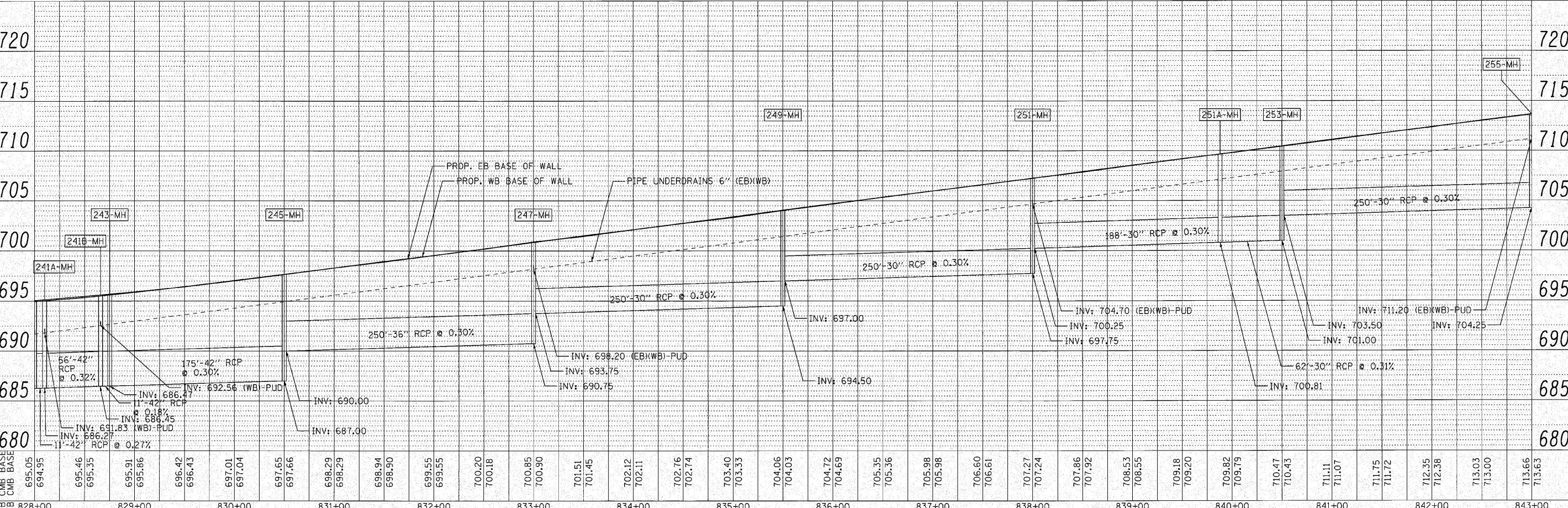

STATION	EB	WB	MANHOLE/CATCH BASIN	INVERT ELEVATION
828+00	695.05	694.95	241A-MH	695.69
829+00	695.46	695.35	241B-MH	695.61
830+00	695.91	695.86	243-MH	697.65
831+00	696.42	696.43	245-MH	690.00
832+00	697.01	697.04	247-MH	690.05
833+00	697.65	697.66	249-MH	700.85
834+00	698.29	698.29	251-MH	700.90
835+00	698.94	698.90	253-MH	700.85
836+00	699.55	699.55	255-MH	707.27
837+00	700.20	700.18	256-CB	700.30
838+00	700.85	700.90	254-CB	703.55
839+00	701.51	701.45	241A-MH	695.40
840+00	702.12	702.11	241B-MH	695.87
841+00	702.76	702.74	255-MH	713.66
842+00	703.40	703.33	256-CB	706.80
843+00	704.06	704.03	256-CB	706.80

DATE	
BY	
REVISION	
NO.	

DATE	
BY	
REVISION	
NO.	

ENGINEERING CONSULTANT
Clorba Group, Inc.
 CONSULTING ENGINEERS
 6607 North Cumberland Avenue, Suite 402
 Chicago, Illinois 60630
 Tel: 773.775.4009 Fax: 773.775.4014
 Email: clorba@clorba.com

USER NAME = coorwell	DESIGNED - CRC	REVISED -
PLOT SCALE = 50.0000' / IN.	DRAWN - JMK	REVISED -
PLOT DATE = 10/27/2010	CHECKED - MRJ	REVISED -
	DATE - 10/27/2010	REVISED -

STATE OF ILLINOIS
 DEPARTMENT OF TRANSPORTATION

F.A.I. 80 FROM US 30 TO NS RAILROAD
 PROPOSED DRAINAGE PLAN AND PROFILE
 SCALE: 1" = 50' SHEET NO. 92 OF SHEETS STA. 828+00 TO STA. 843+00

F.A.I. RTE.	SECTION	COUNTY	TOTAL SHEETS	SHEET NO.
80	99-5-Y	WILL	276	92
CONTRACT NO. 60147			ILLINOIS FED. AID PROJECT	