

ROUTE	SECTION	COUNTY	TOTAL SHEETS	SHEET NUMBER
FAI 94	2010-128-I	COOK	27	9

CONTRACT NO. 60N02



LOCATION 15: SN 016-2807
I-94 EB OVER THORN CREEK
IN THE VILLAGE OF LANSING

LOCATION 12: SN 016-2802
IL 394 NB OVER I-94 EB AND THORN CREEK
IN THE VILLAGE OF LANSING

LOCATION 10: SN 016-2800
IL 394 AND RAMP FOR I-80 WB
OVER THORN CREEK IN THE
VILLAGE OF LANSING

LOCATION 14: SN 016-2805
I-80, 294 EB TO NB OVER I-80 & 394 & THORN
CREEK IN THE VILLAGE OF LANSING

LOCATION 11: SN 016-2801
I-94 (KINGERY EXPWY) NB OVER THORN CREEK
IN THE VILLAGE OF LANSING

LOCATION 13: SN 016-2804
I-94 WB TO IL. 394 SB OVER I-80, I-94
IN THE VILLAGE OF LANSING

LOCATION 5: SN 016-2794
I-94 SB TO I-80 EB OVER I-80 WB
IN THE VILLAGE OF LANSING

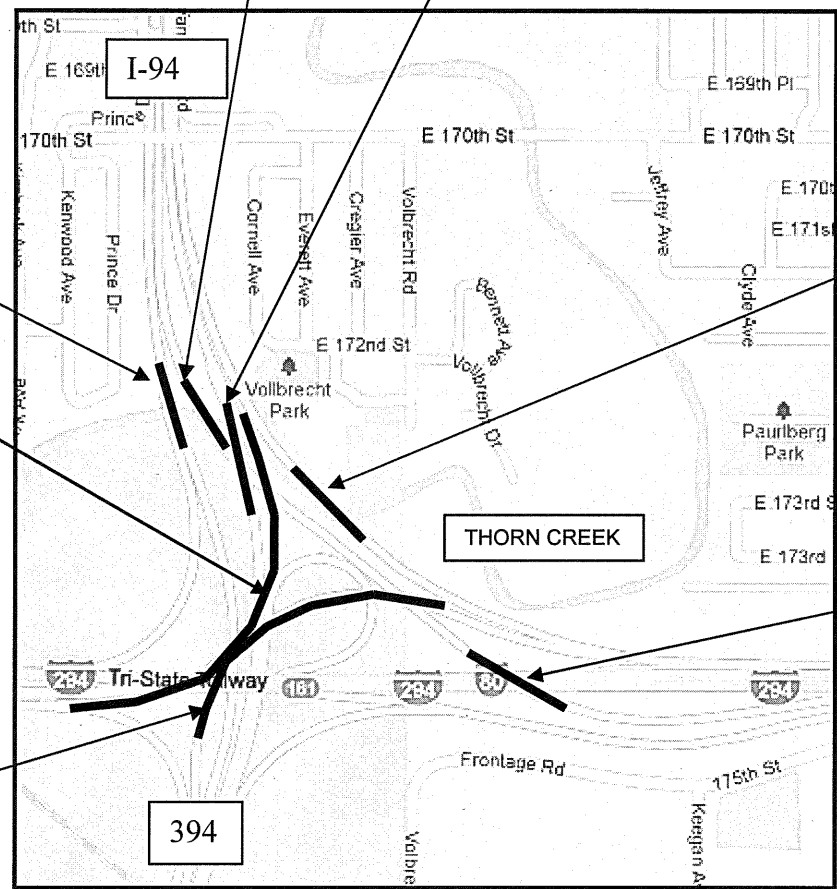

TRAFFIC DATA

I-94

LOCATION 5:
2008 ADT = 46150
POSTED SPEED LIMIT = 55 MPH

LOCATION 11:
2008 ADT = 109400
POSTED SPEED LIMIT = 55 MPH

LOCATION 13:
2007 ADT = 10009
POSTED SPEED LIMIT = 55 MPH

LOCATION 15:
2008 ADT = 109400
POSTED SPEED LIMIT = 55 MPH

I-80, 294

LOCATION 14:
2007 ADT = 10009
POSTED SPEED LIMIT = 55 MPH

IL 394

LOCATION 10:
2008 ADT = 8300
POSTED SPEED LIMIT = 55 MPH

LOCATION 12:
2009 ADT = 32450
POSTED SPEED LIMIT = 55 MPH

THORNTON TOWNSHIP

**ILLINOIS DEPARTMENT OF
TRANSPORTATION**

**LOCATION MAP
LOCATION 5 &
LOCATION 10 - 15**