

PLAN	DATE	BY
REVISION		
NOTE BOOK		
REL. OF MAP CHECKED		
FILE NO.		

PROFILE	DATE	BY
REVISION		
NOTE BOOK		
REL. OF MAP CHECKED		
FILE NO.		

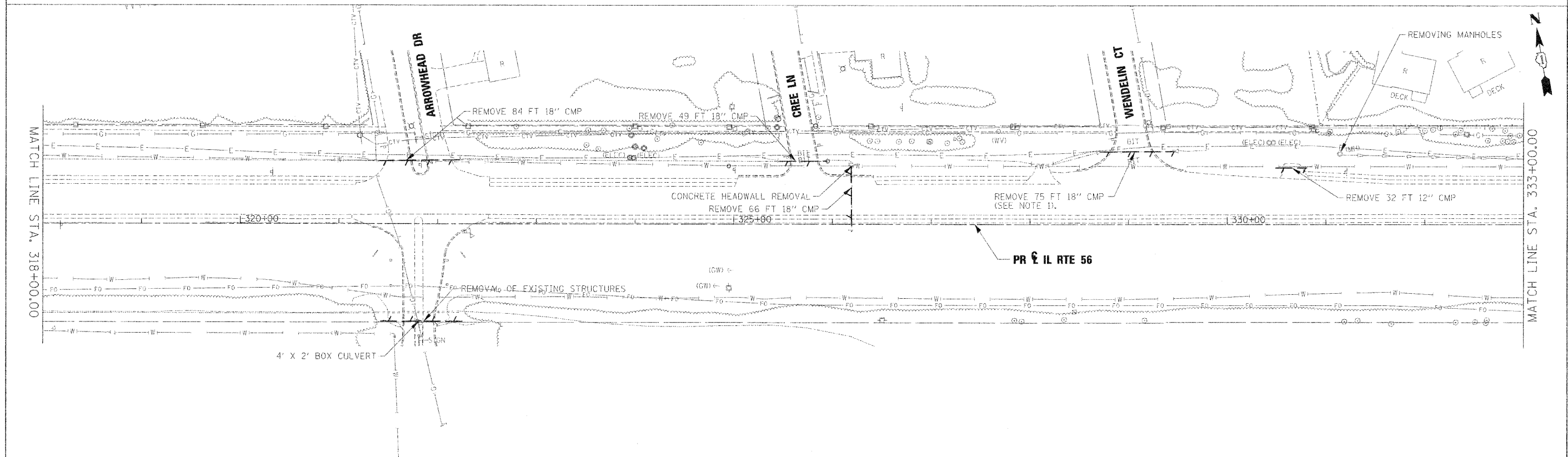
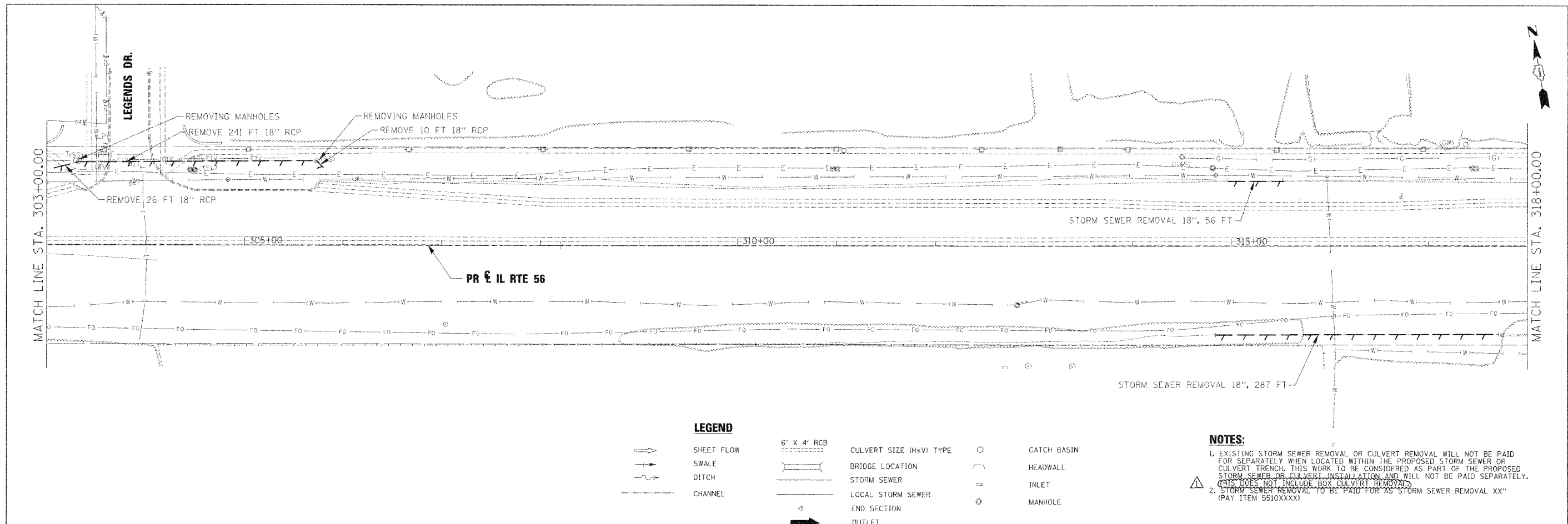

**NOTES:**

- EXISTING STORM SEWER REMOVAL OR CULVERT REMOVAL WILL NOT BE PAID FOR SEPARATELY WHEN LOCATED WITHIN THE PROPOSED STORM SEWER OR CULVERT TRENCH. THIS WORK TO BE CONSIDERED AS PART OF THE PROPOSED STORM SEWER OR CULVERT INSTALLATION AND WILL NOT BE PAID SEPARATELY. (CRS DOES NOT INCLUDE BOX CULVERT REMOVAL)
- STORM SEWER REMOVAL TO BE PAID FOR AS STORM SEWER REMOVAL "XX" (PAY ITEM 5510XXXX)

USER NAME	DESIGNED - KEM	REVISED - ADDENDUM 1- 1/4/2011
PLAT SCALE = 1" = 50'	DRAWN - KEM	REVISED -
PLAT DATE	CHECKED - LSM	REVISED -
	DATE - 12/6/10	REVISED -



STATE OF ILLINOIS  
DEPARTMENT OF TRANSPORTATION

DRAINAGE REMOVAL PLAN  
IL RTE 56  
SCALE: 1"=50' SHEET NO. 3 OF 9 SHEETS STA. 303+00.00 TO STA. 333+00.00

F.A.P. R.T.E.	SECTION	COUNTY	TOTAL SHEETS	SHEET NO.
365	157 & 581WRS-2	DUPAGE	681	254
CONTRACT NO. 62419			ILLINOIS FED. AID PROJECT	