

F.A.P. RTE.	SECTION	COUNTY	TOTAL SHEETS	SHEET NO.
353	12&13WRS-4	WILL	608	65
STA. 569+00		TO STA. 584+00		
FED. ROAD DIST. NO. 1		ILLINOIS		
		FED. AID PROJECT		

PAVEMENT CORE NO. 11
15" BITUMINOUS
6" PCC

PAVEMENT CORE NO. 12
4.25" BITUMINOUS
2.75" BITUMINOUS

MATCH LINE STATION 1002+00
SEE SHEET NO. 76
HARLEM AVENUE

SPEEDWAY
GAS STATION

FARMLAND

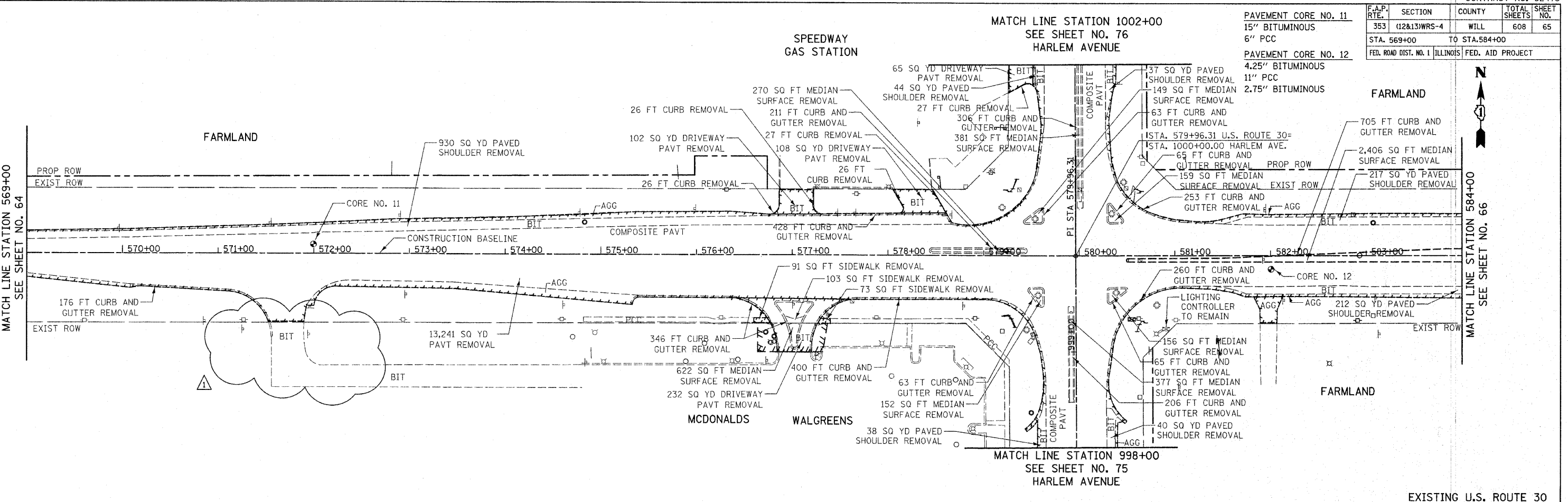

EXISTING U.S. ROUTE 30

NOTE:
THE GENERAL CONTRACTOR IS REQUIRED TO HIRE AN ENVIRONMENTAL FIRM WITH AT LEAST FIVE (5) DOCUMENTED LEAKING UNDERGROUND STORAGE TANK (LUST) CLEANUPS OR THAT IS PRE-QUALIFIED IN HAZARDOUS WASTE BY THE DEPARTMENT TO REMEDIATE THE SOIL CONTAMINATION AND MONITOR FOR WORKER PROTECTION.

MATCH LINE STATION 1002+00
SEE SHEET NO. 76
HARLEM AVENUE

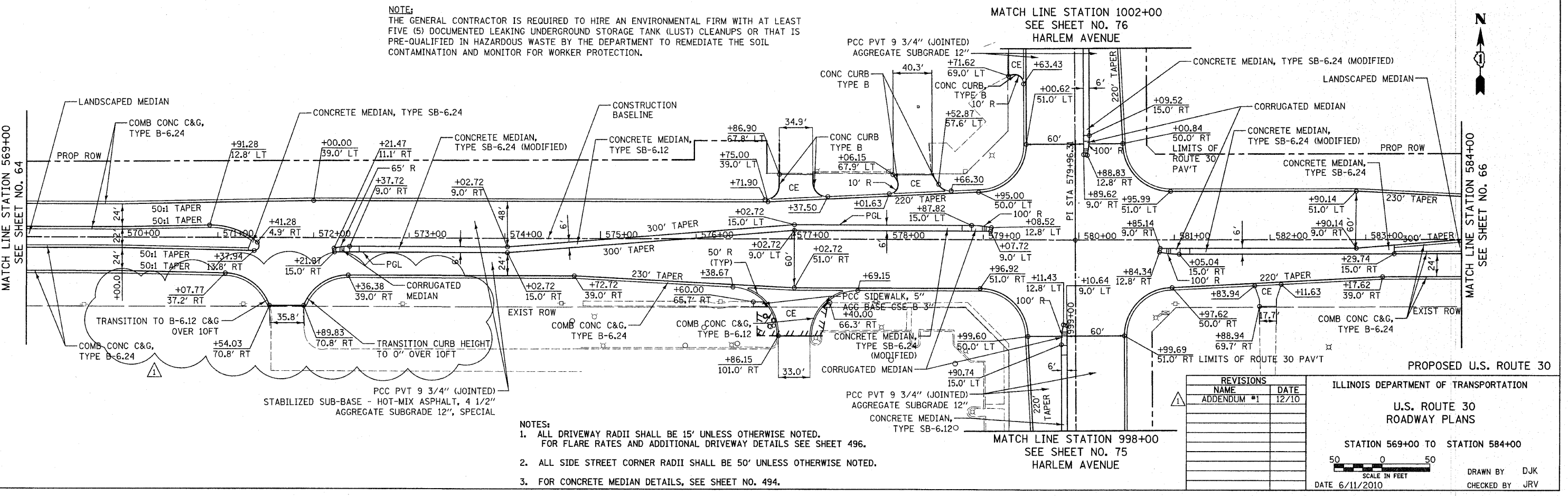

PROPOSED U.S. ROUTE 30

- NOTES:**
- ALL DRIVEWAY RADII SHALL BE 15' UNLESS OTHERWISE NOTED. FOR FLARE RATES AND ADDITIONAL DRIVEWAY DETAILS SEE SHEET 496.
 - ALL SIDE STREET CORNER RADII SHALL BE 50' UNLESS OTHERWISE NOTED.
 - FOR CONCRETE MEDIAN DETAILS, SEE SHEET NO. 494.

REVISIONS	
NAME	DATE
ADDENDUM #1	12/10

ILLINOIS DEPARTMENT OF TRANSPORTATION

**U.S. ROUTE 30
ROADWAY PLANS**

STATION 569+00 TO STATION 584+00

SCALE IN FEET
50 0 50

DATE 6/11/2010

DRAWN BY DJK
CHECKED BY JRV