

TYPICAL CROSS SECTION
 STAGE I - 175TH STREET
 STA 50+94.84 TO STA 56+17.70

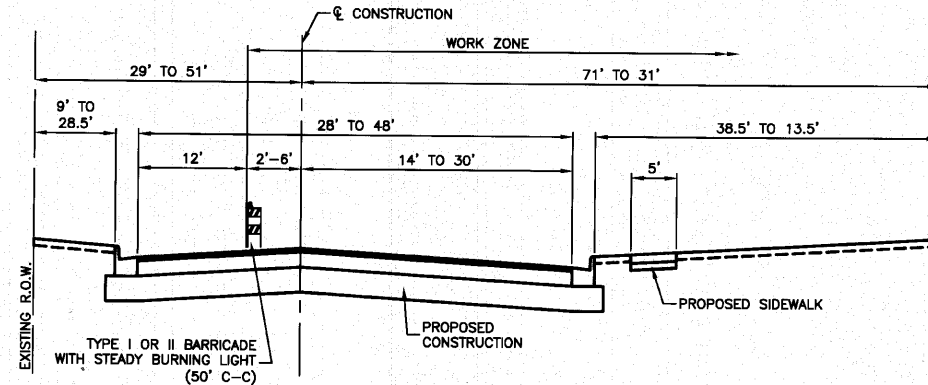

TYPICAL CROSS SECTION
 STAGE 2 - 175TH STREET
 STA 50+94.84 TO STA 56+17.70

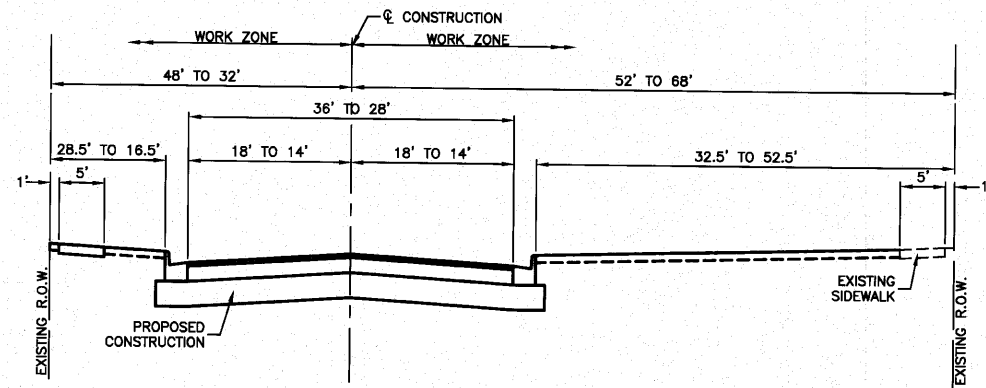

TYPICAL CROSS SECTION
 STAGE I - 175TH ST
 STA 56+82.32 TO STA 62+21.59

SUGGESTED STAGING

Pre-Stage Construction

- Install temporary signals at 175th Street and Harlem Avenue.
- Remove curb and gutter and construct temporary pavement along the south side of 175th Street from approximate Station 54+00 to Station 56+17.70 as shown on the Suggested Construction Staging - Stage I plan sheet.
- Change out any drainage structure frame and grates located in the removed curb and gutter that conflict with the temporary pavement.

Pre-Stage Traffic Control

- The work to be performed in the Pre-Stage shall be completed using Highway Standard 701701.

Stage 1 Construction

- Construct proposed drainage and pavement for 175th Street east of Harlem Avenue.
- Construct proposed drainage and pavement for the north half of 175th Street west of Harlem Avenue.
- Construct the proposed median and pavement widening for the northbound left turn lane along Harlem Avenue.

Stage 1 Traffic Control

- Establish and maintain the detour route for westbound 175th Street traffic west of Harlem Avenue utilizing 171st Street, 183rd Street and 80th Avenue.
- Establish and maintain the local detour route for the east leg of 175th Street utilizing 173rd Street east of Harlem Avenue. Driveway entrances through closure must be maintained at all times. Contractor to provide access to driveways from 71st Avenue.
- The work to be performed along Harlem Avenue shall be completed using Highway Standard 701701.
- 175th Street west of Harlem Avenue - Maintain 1-12' westbound lane utilizing the existing and temporary pavement on the south side of the street.

Stage 2 Construction

- Construct the remaining drainage improvements and proposed pavement for the south half of 175th Street west of Harlem Avenue.

Stage 2 Traffic Control

- Eliminate the local detour route and open 175th Street east of Harlem Avenue. Place temporary markings as shown on the Stage 2 Staging Plans.
- Continue to maintain the detour route for westbound 175th Street traffic west of Harlem Avenue utilizing 171st Street, 183rd Street and 80th Avenue.
- 175th Street west of Harlem Avenue - Maintain 1-12' westbound lane on the north half of newly constructed pavement.

Stage 3 Construction

- Place final pavement markings.
- Install street lighting.
- Install permanent traffic signals and remove temporary traffic signals.
- Perform final grading operations and place sod.
- Post final signing.

Stage 3 Traffic Control

- The work to be performed in this stage will be completed using Highway Standards 701101, 701606 and 701701.

FILE NAME = 06508-TYPX-02

USER NAME =	DESIGNED - WPD	REVISED -
PLOT SCALE =	CHECKED - WPD	REVISED -
PLOT DATE = 10-14-10	DRAWN - AG	REVISED -
	CHECKED - ACAD	REVISED -

STATE OF ILLINOIS
 DEPARTMENT OF TRANSPORTATION

CONSTRUCTION STAGING
 TYPICAL CROSS SECTION

SCALE: NA SHEET NO. 16 OF 60 SHEETS STA. TO STA.

F.A.P. RTE.	SECTION	COUNTY	TOTAL SHEETS	SHEET NO.
348	06-00104-00-CH	COOK	60	16
CONTRACT NO. 63453				
FED. ROAD DIST. NO. 1 ILLINOIS FED. AID PROJECT#HSIP-8003 (851)				