

SECTION 36, TOWNSHIP 36, RANGE 12
 SECTION 25, TOWNSHIP 36, RANGE 12
 SECTION 31, TOWNSHIP 36, RANGE 13
 SECTION 30, TOWNSHIP 36, RANGE 13

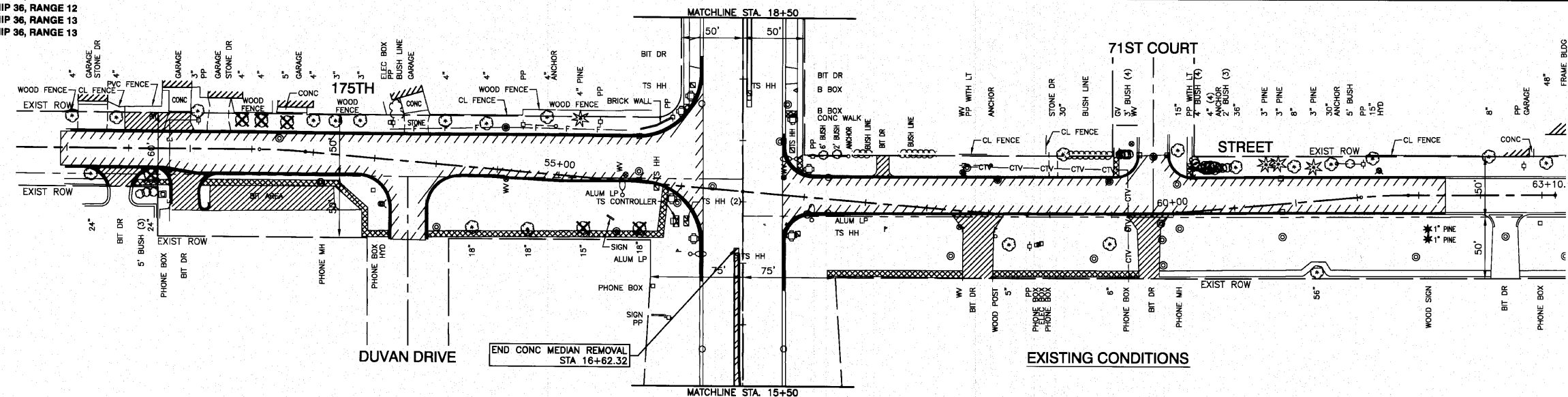

- LEGEND**
- ☒ TREE TO BE REMOVED
 - ▬ CONC CURB AND GUTTER REMOVAL
 - ▬ PAVEMENT REMOVAL
 - ▬ CONC SIDEWALK REMOVAL
 - ▬ DRIVEWAY REMOVAL
 - ▬ MEDIAN REMOVAL
 - SW P.C.C. SIDEWALK, 5"
 - CG1 C & G TYPE B-6.24
 - CG2 C & G TYPE B-6.12
 - CG3 TYPE B CURB, 6"
 - CG4 C & G TYPE B-6.18
 - CM CONCRETE MEDIAN SURFACE, 4"
 - TI 10' CURB TRANSITION
 - CE COMMERCIAL DRIVEWAY
HMA SURFACE COURSE, MIX "C", N50, 2"
HMA BASE COURSE, 6"
 - PE PRIVATE DRIVEWAY
HMA SURFACE COURSE, MIX "C", N50, 2"
HMA BASE COURSE, 4"
 - ▬ PAVEMENT WIDENING

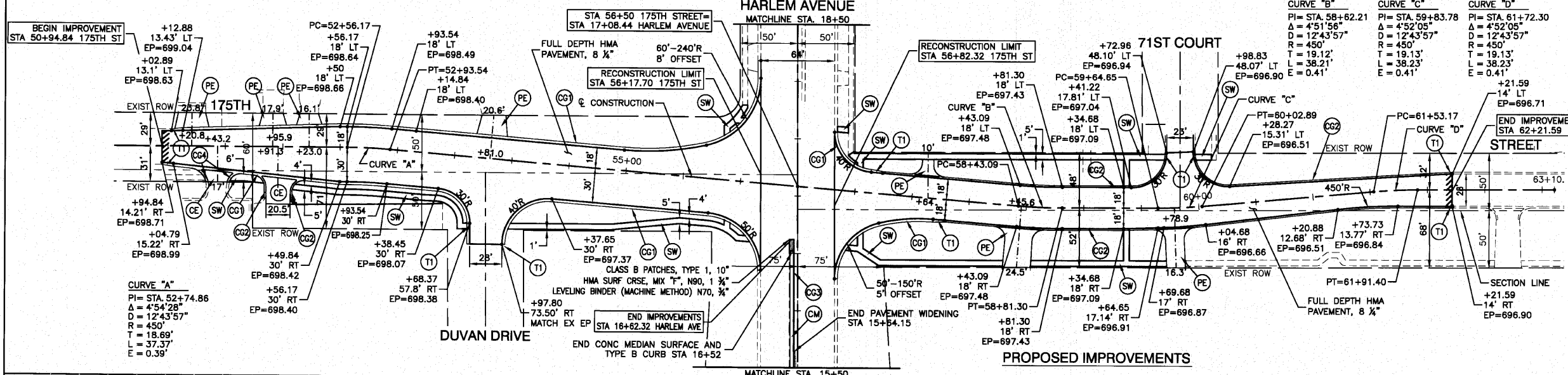
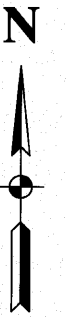

- NOTES**
- SEE INTERSECTION GRADING PLAN FOR EDGE OF PAVEMENT STATION, OFFSET AND ELEVATIONS NEAR HARLEM AVENUE.
 - THE 10" PCC BASE COURSE SHALL BE TIED TO THE EXISTING PCC BASE COURSE WITH EPOXY COATED DEFORMED STEEL TIE BAR NO. 8, 24" LONG AT 24" CENTERS, DRILLED AND GROUTED.
 - THE COST FOR ALL THE BARS SHALL BE CONSIDERED INCLUDED IN THE COST OF THE 10" PCC BASE COURSE.

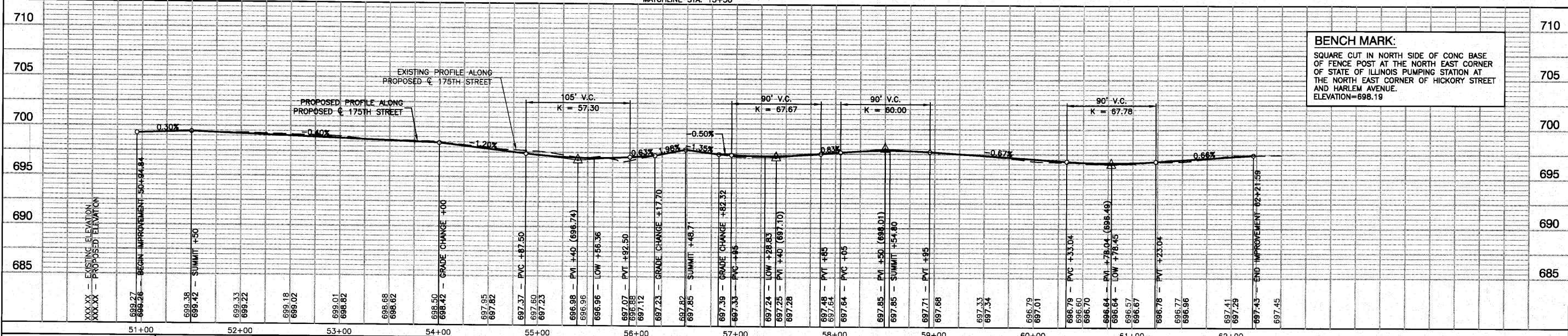

BENCH MARK:
 SQUARE CUT IN NORTH SIDE OF CONC BASE OF FENCE POST AT THE NORTH EAST CORNER OF STATE OF ILLINOIS PUMPING STATION AT THE NORTH EAST CORNER OF HICKORY STREET AND HARLEM AVENUE.
 ELEVATION=698.19

FILE NAME = 06509-PLR01-01	USER NAME =	DESIGNED = WPD	REVISED =	STATE OF ILLINOIS DEPARTMENT OF TRANSPORTATION	175TH STREET AT HARLEM AVENUE INTERSECTION IMPROVEMENTS PLAN AND PROFILE 175TH STREET	F.A.P. RITE = 348	SECTION = 06-00104-00-CH	COUNTY = COOK	TOTAL SHEETS = 80	SHEET NO. = 19		
PLOT SCALE = 1"=50'	DRAWN = AG	CHECKED = WPD	REVISED =			SCALE: H 1"=50' V 1"=5'	SHEET NO. 19 OF 80 SHEETS	STA 50+94.84	TO STA. 62+21.59	CONTRACT NO. 63453		
PLOT DATE = 10-14-10	CHECKED = AG	REVISED =	REVISED =			FED. ROAD DIST. NO. 1			ILLINOIS	FED. AID PROJECT NHSIP-8003 (851)		