

SECTION 36, TOWNSHIP 36, RANGE 12  
 SECTION 25, TOWNSHIP 36, RANGE 12  
 SECTION 31, TOWNSHIP 36, RANGE 13  
 SECTION 30, TOWNSHIP 36, RANGE 13

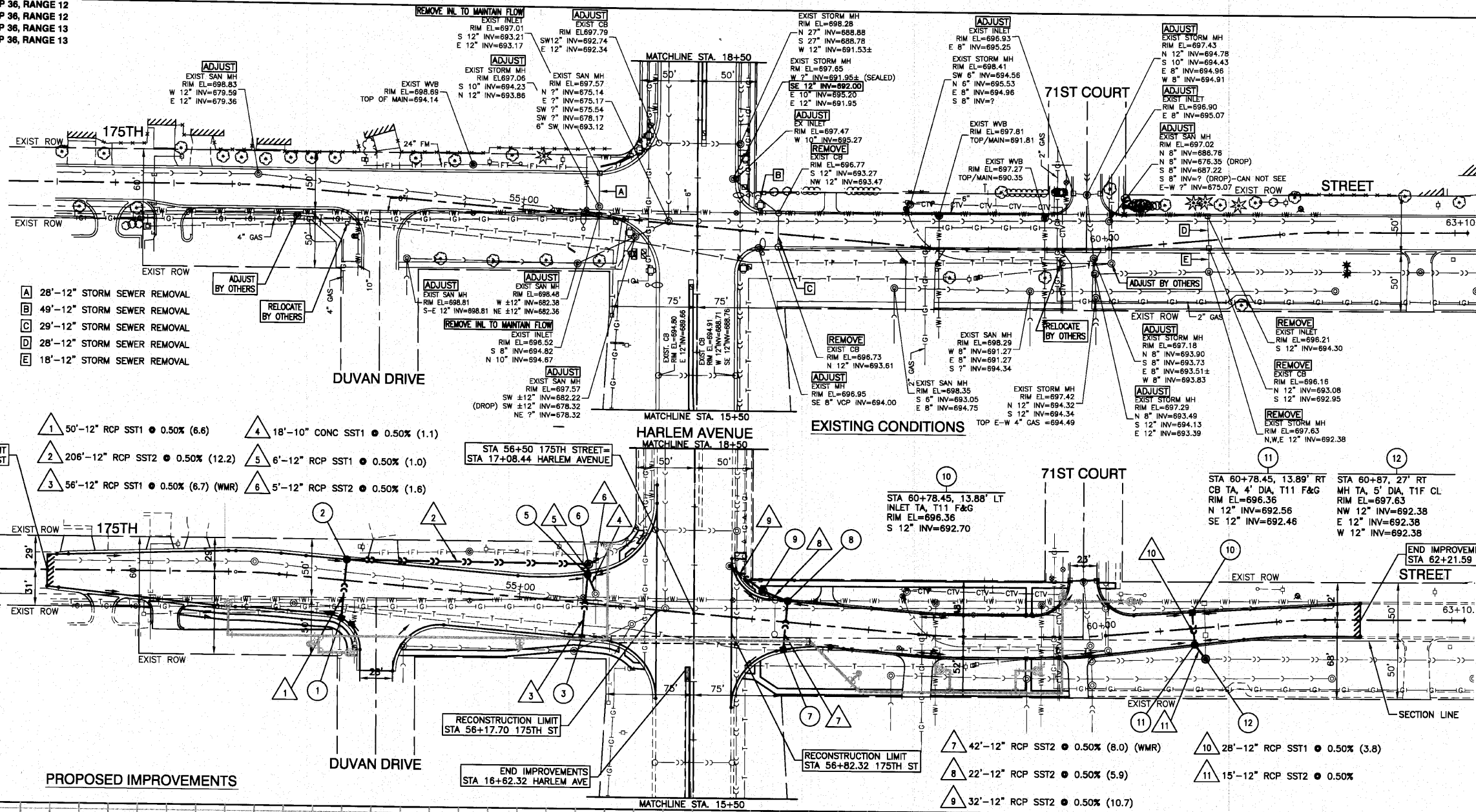
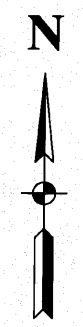

- A 28'-12" STORM SEWER REMOVAL
- B 49'-12" STORM SEWER REMOVAL
- C 29'-12" STORM SEWER REMOVAL
- D 28'-12" STORM SEWER REMOVAL
- E 18'-12" STORM SEWER REMOVAL

- 1 50'-12" RCP SST1 @ 0.50% (6.6)
- 2 206'-12" RCP SST2 @ 0.50% (12.2)
- 3 56'-12" RCP SST1 @ 0.50% (6.7) (WMR)
- 4 18'-10" CONC SST1 @ 0.50% (1.1)
- 5 6'-12" RCP SST1 @ 0.50% (1.0)
- 6 5'-12" RCP SST2 @ 0.50% (1.6)

- 7 42'-12" RCP SST2 @ 0.50% (8.0) (WMR)
- 8 22'-12" RCP SST2 @ 0.50% (5.9)
- 9 32'-12" RCP SST2 @ 0.50% (10.7)
- 10 28'-12" RCP SST1 @ 0.50% (3.8)
- 11 15'-12" RCP SST2 @ 0.50%

- 1 STA 53+50, 32.31' RT  
INLET TA, T24 F&G  
RIM EL=697.97  
N 12" INV=694.47
- 2 STA 53+50, 18' LT  
CB TA, 4' DIA T24 F&G  
RIM EL=698.26  
S 12" INV=694.22  
E 12" INV=694.22
- 3 STA 55+56.36, 30' RT  
INLET TA, T24 F&G  
RIM EL=696.36  
N 12" INV=693.50
- 5 STA 55+56.36, 25.46' LT  
CB TA, 4' DIA T24 F&G  
RIM EL=696.45  
SE 10" INV=693.77  
S 12" INV=693.22  
N 12" INV=693.22
- 6 STA 55+56.36, 33.5' LT  
MH TA, 4' DIA T1F CL  
RIM EL=697.09  
S 12" INV=693.19  
W 12" INV=693.19  
NE 12" INV=693.19
- 7 STA 57+28.83, 23.78' RT  
INLET TA, T24 F&G  
RIM EL=696.76  
N 12" INV=692.68
- 8 STA 57+28.83, 18' LT  
CB TA, 4' DIA, T11 F&G  
RIM EL=696.88  
S 12" INV=692.47  
NW 12" INV=692.37
- 9 STA 57+07, 24.5' LT  
MH TA, 4' DIA, T1F CL  
RIM EL=697.76  
SE 12" INV=692.26  
NW 12" INV=692.16

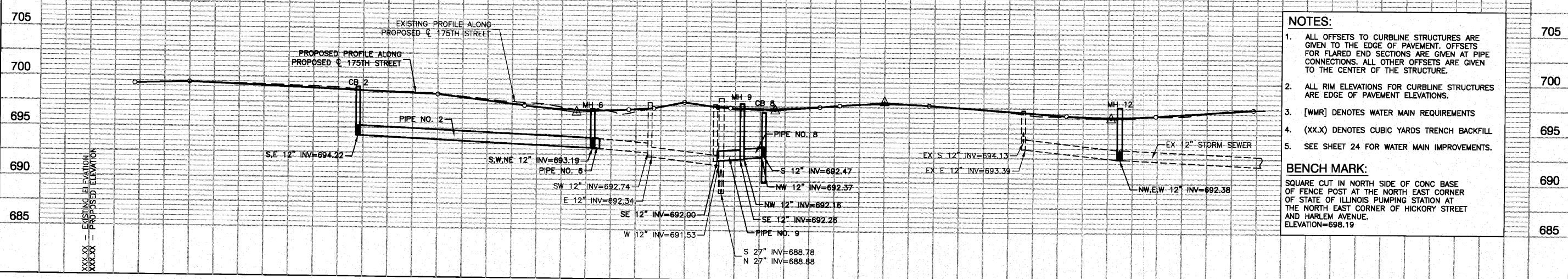

**NOTES:**

- ALL OFFSETS TO CURBLINE STRUCTURES ARE GIVEN TO THE EDGE OF PAVEMENT. OFFSETS FOR FLARED END SECTIONS ARE GIVEN AT PIPE CONNECTIONS. ALL OTHER OFFSETS ARE GIVEN TO THE CENTER OF THE STRUCTURE.
- ALL RIM ELEVATIONS FOR CURBLINE STRUCTURES ARE EDGE OF PAVEMENT ELEVATIONS.
- [WMR] DENOTES WATER MAIN REQUIREMENTS
- (XX.X) DENOTES CUBIC YARDS TRENCH BACKFILL
- SEE SHEET 24 FOR WATER MAIN IMPROVEMENTS.

**BENCH MARK:**  
 SQUARE CUT IN NORTH SIDE OF CONC BASE OF FENCE POST AT THE NORTH EAST CORNER OF STATE OF ILLINOIS PUMPING STATION AT THE NORTH EAST CORNER OF HICKORY STREET AND HARLEM AVENUE.  
 ELEVATION=698.19

FILE NAME = 08508-STRM-01 - P01	USER NAME =	DESIGNED - WPD	REVISIONS -	STATE OF ILLINOIS DEPARTMENT OF TRANSPORTATION	175TH STREET AT HARLEM AVENUE INTERSECTION IMPROVEMENTS DRAINAGE AND UTILITIES 175TH STREET	F.A.P. RTE. 348	SECTION 08-00104-00-CH	COUNTY COOK	TOTAL SHEETS 60	SHEET NO. 22	
PLOT SCALE = 1"=50'	CHECKED - WPD	REVISIONS -	SCALE: H 1"=50' V 1"=5'			SHEET NO. 22 OF 60 SHEETS	STA. 50+94.84 TO STA. 62+21.59	CONTRACT NO. 63453			
PLOT DATE = 10-14-10	DRAWN - AG	REVISIONS -	FED. ROAD DIST. NO. 1 ILLINOIS FED. AID PROJECT/HSIP-8003 (851)								
	CHECKED - AG	REVISIONS -									