

**LEGEND**

- ① 4" DOUBLE YELLOW CENTERLINE (11" C/C)
- ② 4" DOUBLE YELLOW MEDIAN OUTLINE (11" C/C)
- ③ 4" WHITE SKIP DASH (10' LINE, 30' SPACE)
- ④ 12" YELLOW DIAGONAL (25' C/C)
- ⑤ WHITE LETTERS & SYMBOLS - LARGE
- ⑥ 6" WHITE LANE LINE
- ⑦ 24" WHITE STOP BAR
- ⑧ 6" WHITE SKIP DASH (2' LINE, 6' SPACE)
- ⑨ 12" YELLOW DIAGONAL (20' C/C)
- ⑩ 6" WHITE CROSSWALK (6' C/C)

**NOTES:**  
 1. ALL PAVEMENT MARKINGS SHALL BE THERMOPLASTIC.

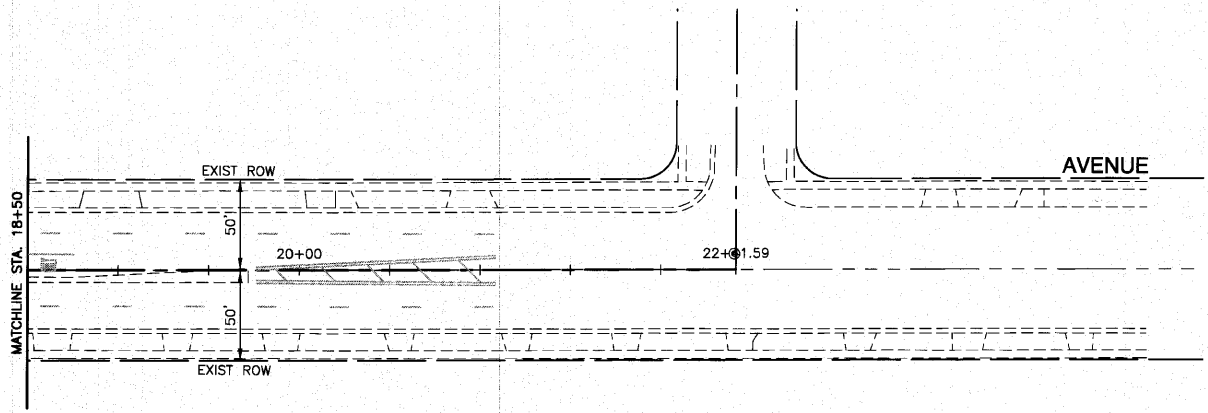

FILE NAME = 06508-PV/MK-01 - P01	USER NAME =	DESIGNED - WPD	REVISED -	<b>STATE OF ILLINOIS DEPARTMENT OF TRANSPORTATION</b>	<b>175TH STREET AT HARLEM AVENUE INTERSECTION IMPROVEMENTS PAVEMENT MARKING AND SIGNING PLAN</b>		F.A.P. RTE. 348	SECTION 06-00104-00-CH	COUNTY COOK	TOTAL SHEETS 80	SHEET NO. 25	
	PLOT SCALE =	CHECKED - WPD	REVISED -		SCALE: 1"=50'	SHEET NO. 25	OF 80 SHEETS	STA.	TO STA.	CONTRACT NO. 63453		
	PLOT DATE = 10-14-10	DRAWN - AG	REVISED -		FED. ROAD DIST. NO. 1 ILLINOIS FED. AID PROJECT #HSIP-8003 (851)							
		CHECKED - AG	REVISED -									