

OVERLAP LETTER	PERMISSIVE PHASE	PROTECTED PHASE
A	4	5

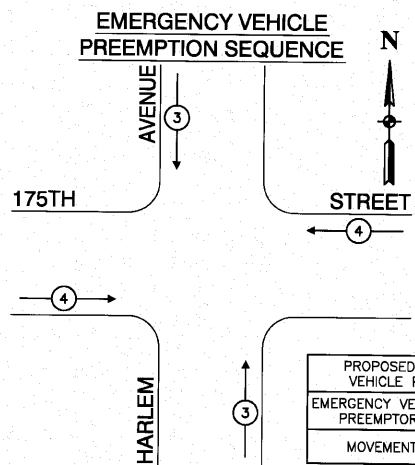

PROPOSED EMERGENCY VEHICLE PREEMPTORS	
EMERGENCY VEHICLE PREEMPTORS	3 4
MOVEMENT	↑ ↓

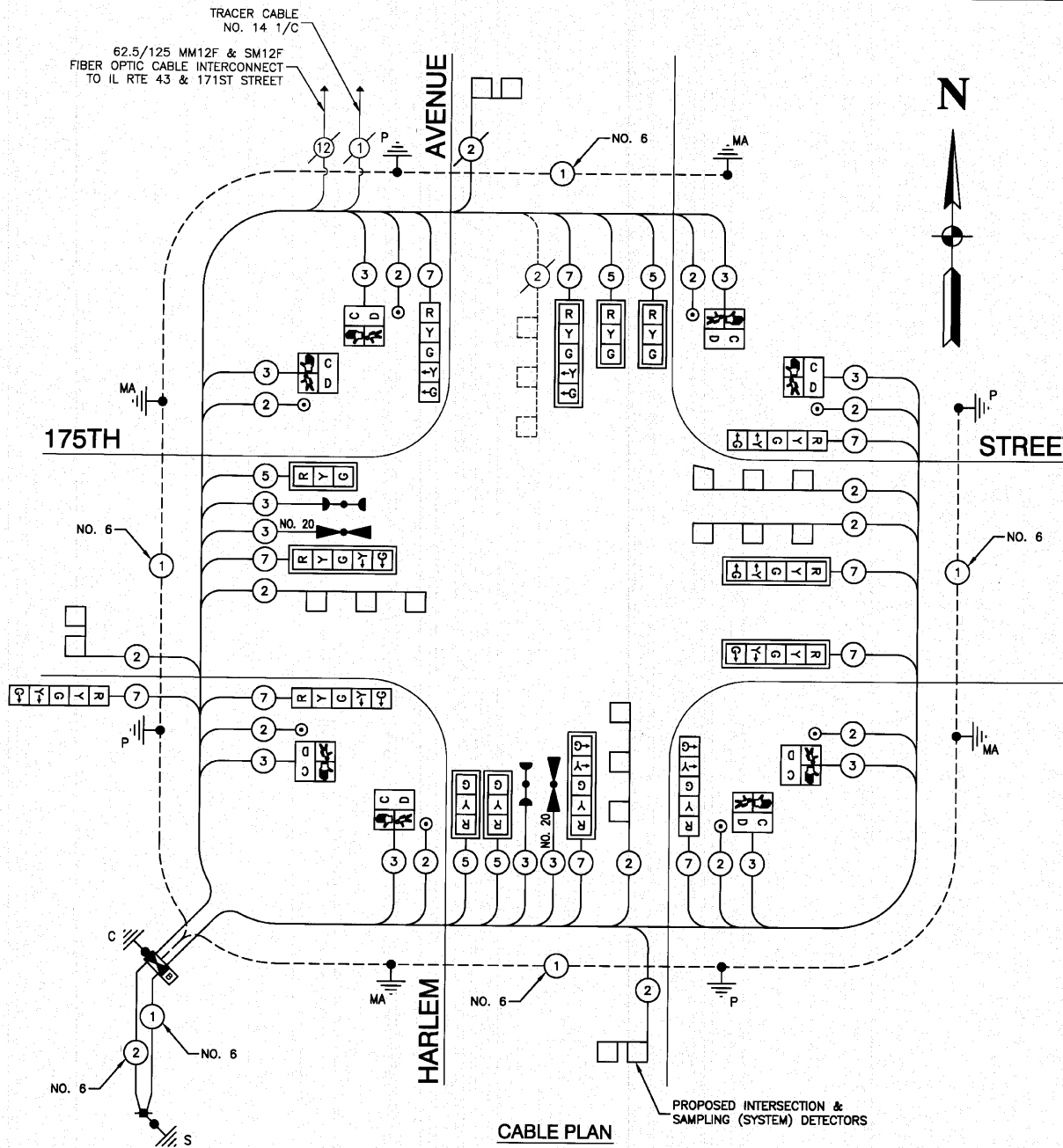

CABLE PLAN
NOT TO SCALE

SCHEDULE OF QUANTITIES

ITEM	UNIT	QUAN	ITEM	UNIT	QUAN
SIGN PANEL - TYPE 1	SQ FT	10.5	CONCRETE FOUNDATION, TYPE C	FOOT	4
SIGN PANEL - TYPE 2	SQ FT	25	CONCRETE FOUNDATION, TYPE E 36-INCH DIAMETER	FOOT	48
CONDUIT IN TRENCH, 2" DIA., GALVANIZED STEEL	FOOT	545	DRILL EXISTING HANDHOLE	EACH	2
CONDUIT IN TRENCH, 2 1/2" DIA., GALVANIZED STEEL	FOOT	98	SIGNAL HEAD, LED, 1-FACE, 3-SECTION, MAST-ARM MOUNTED	EACH	5
CONDUIT IN TRENCH, 3" DIA., GALVANIZED STEEL	FOOT	11	SIGNAL HEAD, LED, 1-FACE, 5-SECTION, BRACKET MOUNTED	EACH	3
CONDUIT IN TRENCH, 4" DIA., GALVANIZED STEEL	FOOT	29	SIGNAL HEAD, LED, 1-FACE, 5-SECTION, MAST-ARM MOUNTED	EACH	5
CONDUIT PUSHED, 2" DIA., GALVANIZED STEEL	FOOT	153	SIGNAL HEAD, LED, 2-FACE, 5-SECTION, BRACKET MOUNTED	EACH	1
CONDUIT PUSHED, 4" DIA., GALVANIZED STEEL	FOOT	441	PEDESTRIAN SIGNAL HEAD, LED, 1-FACE, BRACKET MOUNTED WITH COUNTDOWN TIMER	EACH	8
HANDHOLE	EACH	4	TRAFFIC SIGNAL BACKPLATE, LOUVERED, ALUMINUM	EACH	10
HEAVY-DUTY HANDHOLE	EACH	2	INDUCTIVE LOOP DETECTOR	EACH	2
DOUBLE HANDHOLE	EACH	2	DETECTOR LOOP, TYPE 1	FOOT	609
TRENCH AND BACKFILL FOR ELECTRICAL WORK	FOOT	711	LIGHT DETECTOR	EACH	2
MAINTENANCE OF EXISTING TRAFFIC SIGNAL INSTALLATION	EACH	1	LIGHT DETECTOR AMPLIFIER	EACH	1
FULL-ACTUATED CONTROLLER AND TYPE IV CABINET, SPECIAL	EACH	1	PEDESTRIAN PUSH-BUTTON	EACH	8
TRANSCEIVER - FIBER OPTIC	EACH	1	TEMPORARY TRAFFIC SIGNAL INSTALLATION	EACH	1
ELECTRIC CABLE IN CONDUIT, SIGNAL NO. 14 2C	FOOT	1147	REMOVE EXISTING TRAFFIC SIGNAL EQUIPMENT	EACH	1
ELECTRIC CABLE IN CONDUIT, SIGNAL NO. 14 3C	FOOT	1495	REMOVE EXISTING HANDHOLE	EACH	5
ELECTRIC CABLE IN CONDUIT, SIGNAL NO. 14 5C	FOOT	878	REMOVE EXISTING CONCRETE FOUNDATION	EACH	8
ELECTRIC CABLE IN CONDUIT, SIGNAL NO. 14 7C	FOOT	1571	ELECTRIC CABLE IN CONDUIT, TRACER, NO. 14 1C	FOOT	3400
ELECTRIC CABLE IN CONDUIT, LEAD-IN, NO. 14 1 PAIR	FOOT	2175	RE-OPTIMIZE TRAFFIC SIGNAL SYSTEM LEVEL 2	EACH	1
ELECTRIC CABLE IN CONDUIT, SERVICE, NO. 6 2 C	EACH	85	TEMPORARY TRAFFIC SIGNAL TIMING	EACH	1
TRAFFIC SIGNAL POST, GALVANIZED STEEL, 16 FT.	EACH	4	SERVICE INSTALLATION - POLE MOUNTED	EACH	1
STEEL MAST ARM ASSEMBLY AND POLE, 36 FT.	EACH	1	UNINTERRUPTIBLE POWER SUPPLY	EACH	1
STEEL MAST ARM ASSEMBLY AND POLE, 38 FT.	EACH	1	FIBER OPTIC CABLE IN CONDUIT, NO. 62.5/125, MM12F SM12F	FOOT	3400
STEEL MAST ARM ASSEMBLY AND POLE, 40 FT.	EACH	1	ELECTRIC CABLE IN CONDUIT, GROUNDING, NO. 6 1C	FOOT	1515
STEEL MAST ARM ASSEMBLY AND POLE, 42 FT.	EACH	1	ELECTRIC CABLE IN CONDUIT NO. 20 3/C, TWISTED, SHIELDED	FOOT	292
CONCRETE FOUNDATION, TYPE A	FOOT	16			

I.D.O.T. TRAFFIC SIGNAL INSTALLATION ELECTRICAL SERVICE REQUIREMENTS					TOTAL WATTAGE
TYPE	NO. LAMPS	WATTAGE INCAND.	WATTAGE LED	OPERATION	
SIGNAL (RED)	15	17	0.50		127.50
(YELLOW)	15	25	0.25		93.75
(GREEN)	15	0.25	56.25		56.25
ARROW	20	12	0.10		24.0
PED. SIGNAL	8	25	1.00		200.0
CONTROLLER	1	100	1.00		100
ILLUM. SIGN	-	25	0.05		-
FLASHER			0.50		
ENERGY COSTS TO:			TOTAL =		601.50

ILLINOIS DEPARTMENT OF TRANSPORTATION
DIVISION OF HIGHWAY / DISTRICT 1
201 WEST CENTER COURT / SCHAMBURG, ILLINOIS 60196-1096
ENERGY SUPPLY CONTACT: ANTHONY ESCALANTE
PHONE: (708) 236-2328
COMPANY: COMMONWEALTH EDISON

FILE NAME = 06509-CBLE-PLAN-01 - PD1	USER NAME =	DESIGNED - WPD	REVISED -
		CHECKED - WPD	REVISED -
	PLOT SCALE =	DRAWN - PS	REVISED -
		CHECKED - WD	REVISED -
	PLOT DATE = 10-14-10		

STATE OF ILLINOIS
DEPARTMENT OF TRANSPORTATION

175TH STREET AT HARLEM AVENUE
INTERSECTION IMPROVEMENTS
TRAFFIC SIGNAL - CABLE PLAN

SCALE: NONE SHEET NO. 39 OF 60 SHEETS STA. TO STA.

F.A.P. RTE. 348	SECTION 06-00104-00-CH	COUNTY COOK	TOTAL SHEETS 60	SHEET NO. 39
CONTRACT NO. 63453				
FED. ROAD DIST. NO. 1 ILLINOIS FED. AID PROJECT NHSIP-8003 (851)				