

STATE OF ILLINOIS
DEPARTMENT OF TRANSPORTATION
DIVISION OF HIGHWAYS

PLANS FOR PROPOSED FEDERAL AID HIGHWAY

FAP 348 (HARLEM AVENUE)
FROM SOUTHWEST HIGHWAY TO 65TH STREET
SIGNING
SECTION: 07-00055-01-SG
PROJECT: HPP-3462(001)
JOB NO: C-91-503-09
MUNICIPALITIES OF PALOS HILLS,
CHICAGO RIDGE, AND BRIDGEVIEW
COOK COUNTY

F. A. A. NO.	SECTION	COUNTY	TOTAL SHEETS	SHEET NO.
348	07-00055-01-SG	COOK	55	1
STA.		TO STA.		
FED. ROAD DIST. NO.	ILLINOIS	FED. AID PROJECT HPP-3462(001)		

CONTRACT #63510

INDEX OF SHEETS
SEE SHEET NO. 2

HIGHWAY STANDARDS
SEE SHEET NO. 2

PROJECT IS LOCATED IN THE CITY OF PALOS HILLS
AND THE VILLAGES OF BRIDGEVIEW AND CHICAGO RIDGE

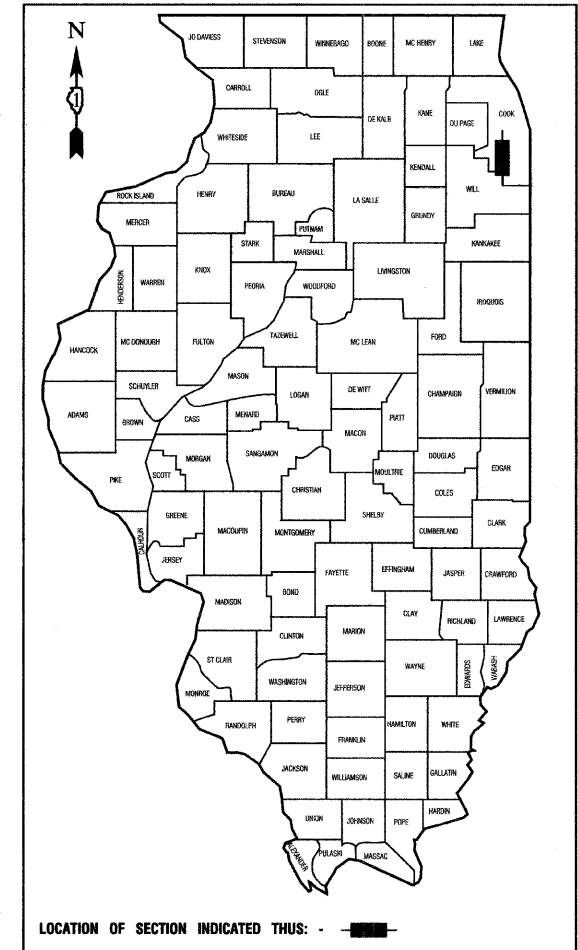

STATE OF ILLINOIS DEPARTMENT OF TRANSPORTATION
DIVISION OF HIGHWAYS

Approved: 10/22/2010
Steve Lelone
President, Village of Bridgeview

Passed: NOVEMBER 4, 2010
Chris Stathel
District 1 Engineer of Local Roads & Streets

Released for Bid Based on Limited Review: NOVEMBER 8, 2010
Diane M. O'Keefe
Deputy Director of Highways, Region 1 Engineer

PRINTED BY THE AUTHORITY OF
THE STATE OF ILLINOIS

PREPARED BY OR UNDER THE
DIRECT SUPERVISION OF:
[Signature]
10/22/2010

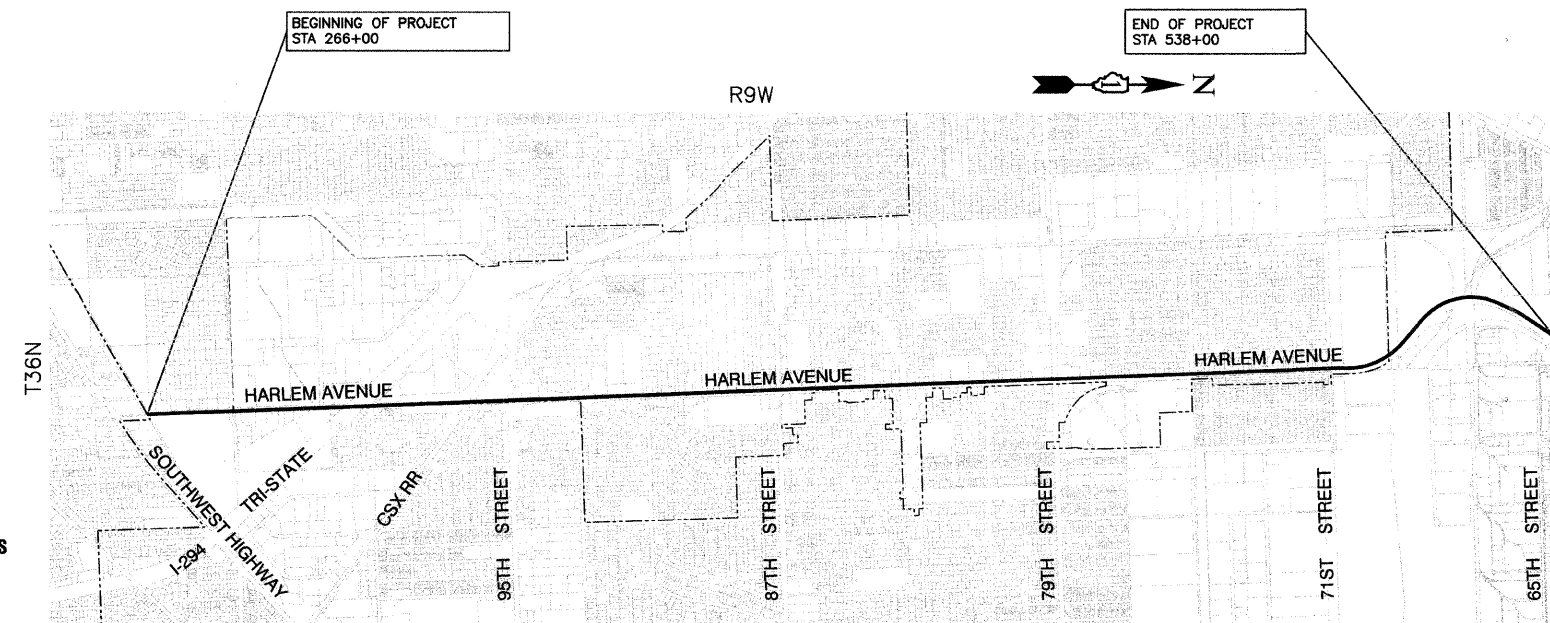
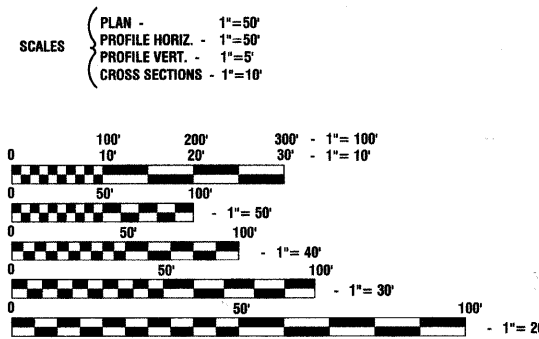
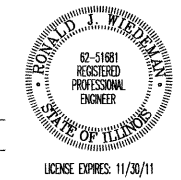

LOCATION MAP
NO SCALE
GROSS AND NET LENGTH=27,200 FEET=5.15 MILES

FULL SIZE PLANS HAVE BEEN PREPARED USING STANDARD
ENGINEERING SCALES, REDUCED SIZED PLANS WILL NOT
CONFORM TO STANDARD SCALES, IN MAKING MEASUREMENTS
ON REDUCED PLANS, THE ABOVE SCALES MAY BE USED.

J. U. L. I. E.
JOINT UTILITY LOCATION INFORMATION FOR EXCAVATION
1-800-892-0123 or 811

CONTRACT NO. 63510

PROGRAM AND OFFICE ENGINEER: CHARLES F. RIDDLE, P.E. 847-705-4406 SCHAUMBURG, IL
CONSULTANTS: ROBINSON ENGINEERING, LTD. 708-331-6700
CONTACT ENGINEER: RON WIEDEMAN