

- RANDALL ROAD AT COMMONS DRIVE NOTES:
1. REMOVE EXISTING TRAFFIC SIGNAL CONTROLLER FROM TRAFFIC SIGNAL CONTROLLER CABINET.
 2. REMOVE EXISTING MALFUNCTION MANAGEMENT UNIT (MMU) FROM TRAFFIC SIGNAL CONTROLLER CABINET.
 3. REMOVE EXISTING UNINTERRUPTIBLE POWER SUPPLY (UPS) AND CABINET FROM TRAFFIC SIGNAL CONTROLLER CABINET.
 4. REPLACE EXISTING INCANDESCENT FLOODLAMPS IN EMERGENCY VEHICLE PREEMPTION CONFIRMATION BEACONS WITH LED FLOODLAMPS.
 5. INSTALL NEW TRAFFIC SIGNAL CONTROLLER INTO EXISTING TRAFFIC SIGNAL CONTROLLER CABINET.
 6. INSTALL NEW MALFUNCTION MANAGEMENT UNIT (MMU) INTO EXISTING TRAFFIC SIGNAL CONTROLLER CABINET.
 7. INSTALL NEW UNINTERRUPTIBLE POWER SUPPLY (UPS) IN NEW CABINET AND ATTACH TO THE SIDE OF THE EXISTING TRAFFIC SIGNAL CONTROLLER CABINET.
 8. INSTALL OUTDOOR PENDANT DOME CAMERA ON EXISTING COMBINATION POLE ON THE NORTHEAST CORNER.
 9. INSTALL PTZ INTO EXISTING TRAFFIC SIGNAL CONTROLLER CABINET.
- SEE SHEETS 34-36 FOR AN EQUIPMENT LIST FOR ETHERNET INTERFACE AND COMMUNICATIONS UPGRADE

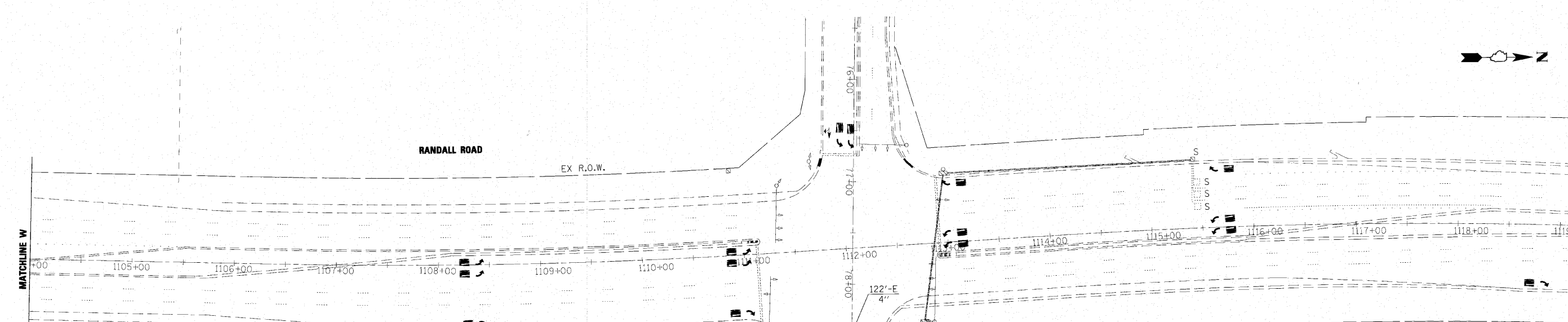
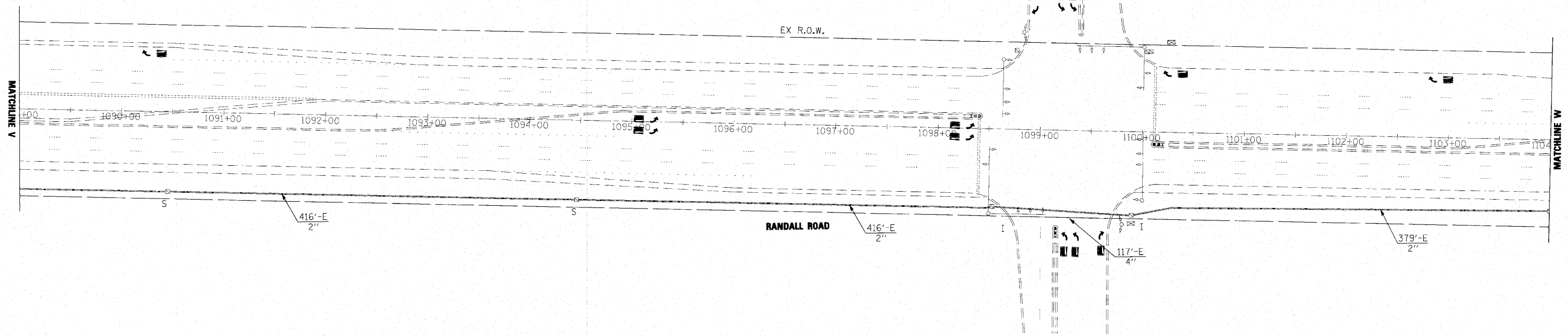

- RANDALL ROAD AT COUNTY LINE ROAD NOTES:
1. REMOVE EXISTING TRAFFIC SIGNAL CONTROLLER FROM TRAFFIC SIGNAL CONTROLLER CABINET.
 2. REMOVE EXISTING MALFUNCTION MANAGEMENT UNIT (MMU) FROM TRAFFIC SIGNAL CONTROLLER CABINET.
 3. REMOVE EXISTING UNINTERRUPTIBLE POWER SUPPLY (UPS) AND CABINET FROM TRAFFIC SIGNAL CONTROLLER CABINET.
 4. REMOVE EXISTING PTZ CAMERA AND ASSOCIATED CONTROL EQUIPMENT.
 5. REPLACE EXISTING INCANDESCENT FLOODLAMPS IN EMERGENCY VEHICLE PREEMPTION CONFIRMATION BEACONS WITH LED FLOODLAMPS.
 6. INSTALL NEW TRAFFIC SIGNAL CONTROLLER INTO EXISTING TRAFFIC SIGNAL CONTROLLER CABINET.
 7. INSTALL NEW MALFUNCTION MANAGEMENT UNIT (MMU) INTO EXISTING TRAFFIC SIGNAL CONTROLLER CABINET.
 8. INSTALL NEW UNINTERRUPTIBLE POWER SUPPLY (UPS) IN NEW CABINET AND ATTACH TO THE SIDE OF THE EXISTING TRAFFIC SIGNAL CONTROLLER CABINET.
 9. INSTALL OUTDOOR PENDANT DOME CAMERA ON EXISTING COMBINATION POLE ON THE SOUTHWEST CORNER.
 10. INSTALL PTZ INTO EXISTING TRAFFIC SIGNAL CONTROLLER CABINET.
 11. SEE SHEETS 34-36 FOR AN EQUIPMENT LIST FOR ETHERNET INTERFACE AND COMMUNICATIONS UPGRADE

PLAN	DESIGNED	DATE
	DRAWN	
	CHECKED	
	DATE	
	BY	
	NO.	
	FILE NAME	

PROFILE	DESIGNED	DATE
	DRAWN	
	CHECKED	
	DATE	
	BY	
	NO.	
	FILE NAME	

FILE NAME
#11ELE8

DESIGNED	-	REVISED	-
DRAWN	-	REVISED	-
CHECKED	-	REVISED	-
DATE	-	REVISED	-

**KANE COUNTY
DIVISION OF TRANSPORTATION**

**INTERCONNECT PLANS
RANDALL ROAD**

SCALE: 1" = 50' SHEET NO. 23 OF 36 SHEETS STA. TO STA.

F.A. RTE.	SECTION	COUNTY	TOTAL SHEETS	SHEET NO.
	08-00379-00-TL	KANE	36	23
				CONTRACT NO. 63520
ILLINOIS FED. AID PROJECT CMM-9003047				