

PLAN	SURVEYED	BY	DATE
	PLOTTED		
	REVISIONS CHECKED		
	ROADWAY CHECKED		
NO.			

PROFILE	SURVEYED	BY	DATE
	PLOTTED		
	GRADES CHECKED		
	STRUCTURE NOTATIONS CHECKED		
NO.			

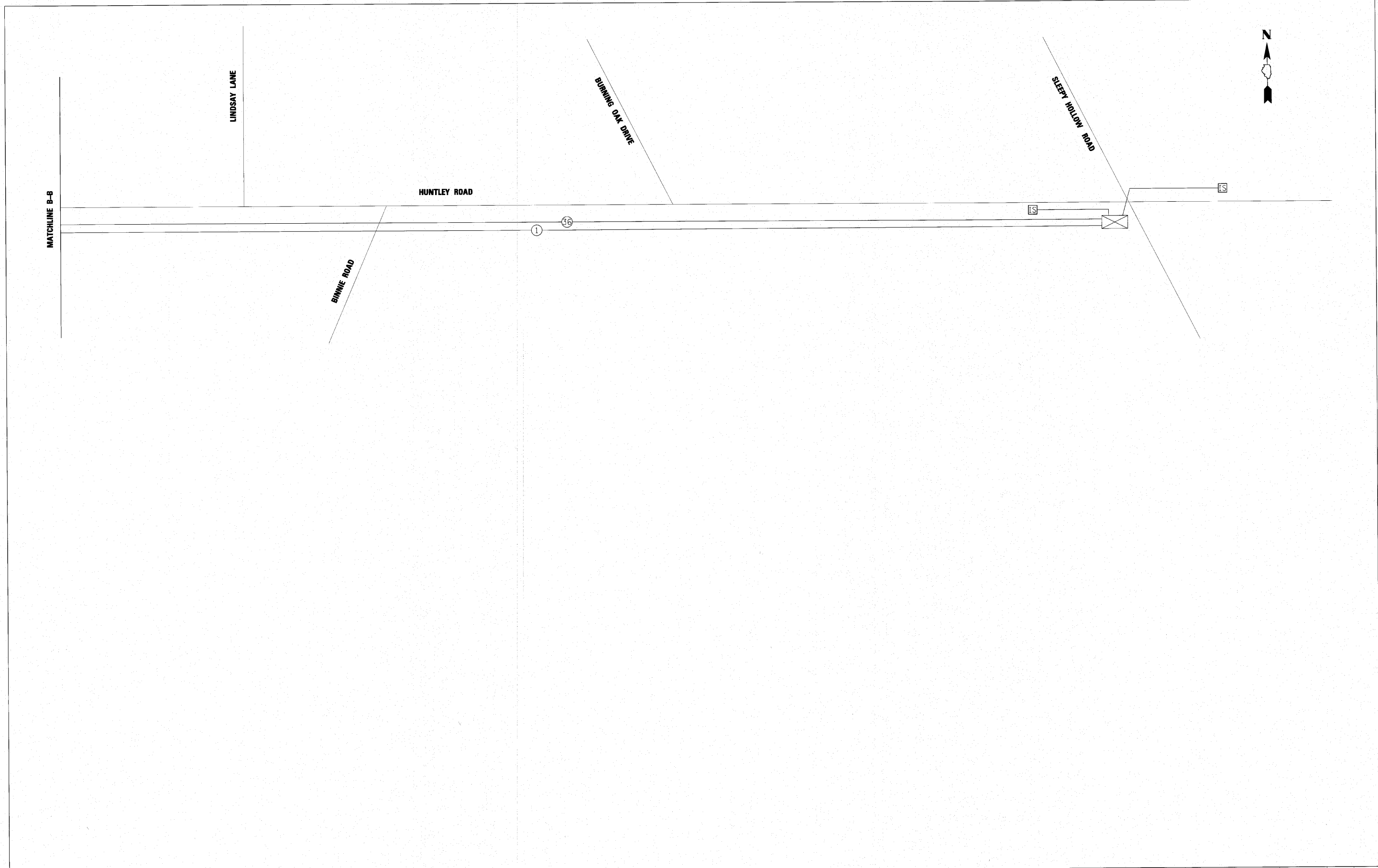

FILE NAME =	
FILE #	

DESIGNED -	REVISIONS
DRAWN -	REVISIONS
CHECKED -	REVISIONS
DATE -	REVISIONS

**KANE COUNTY
DEPARTMENT OF TRANSPORTATION**

**INTERCONNECT SCHEMATIC
HUNTLEY ROAD FROM LINDSAY LANE TO SLEEPY HOLLOW ROAD**

SCALE: 1" = 50' SHEET NO. 25 OF 36 SHEETS STA. TO STA.

F.A. RTE.	SECTION	COUNTY	TOTAL SHEETS	SHEET NO.
	08-00379-00-TL	KANE	36	25
CONTRACT NO. 63520				
ILLINOIS FED. AID PROJECT CMW-9003(147)				