

EXIST./PROP. CURVE
 PI STA. = 125+54.61
 $\Delta = 34^\circ 05' 52''$ (LT)
 $D = 6^\circ 59' 56''$
 $R = 818.64'$
 $T = 251.05'$
 $L = 487.19'$
 $E = 37.63'$
 $e = 8\%$
 $T.R. = 48'$
 $S.E. RUN = 192'$
 $P.C. STA. = 123+03.56$
 $P.T. STA. = 127+90.75$

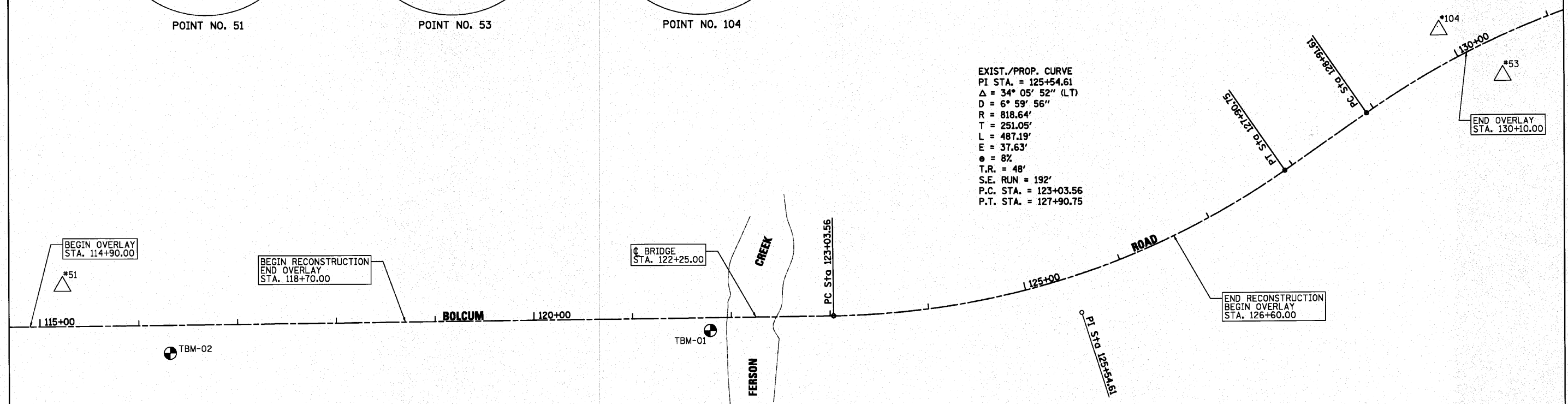

DATUM
 HORIZONTAL: NAD 83
 VERTICAL: NAVD 29

LEGEND
 = TEMPORARY BENCHMARK LOCATION
 = HORIZONTAL CONTROL POINT LOCATION

POINT NO.	NORTHING	EASTING	STATION	OFFSET
51	1,926,467.908	976,995.117	115+23.25	40.76' LT
53	1,926,675.358	978,454.026	130+32.58	37.37' RT
104	1,926,721.856	978,389.566	129+95.61	33.06' LT

TBM	ELEVATION	DESCRIPTION
01	753.96	CHISEL 'X' ON THE SOUTHWESTERLY END OF SOUTH CONCRETE CURB OF BOLCUM ROAD BRIDGE OVER FERSON CREEK.
02	749.97	POINT LOCATED ON TOP OF THE SOUTHERLY END OF THE WESTERLY CULVERT PIPE UNDER BOLCUM ROAD, APPROXIMATELY 547 FEET WEST OF BOLCUM ROAD BRIDGE OVER FERSON CREEK.

FILE NAME = P:\CIBBEL\WEST Projects\22891\gpr-0802 Bolcum PHOTOC\1\Drawings\SHA\TAB_01.dgn

WBK WILLS BURKE KELSEY ASSOCIATES LTD.
 116 West Main Street, Suite 201
 St. Charles, Illinois 60174

USER NAME = #USER#	DESIGNED -	REVISED -
PLOT SCALE =	DRAWN -	REVISED -
PLOT DATE = 10/21/2010	CHECKED -	REVISED -
	DATE = 10/22/10	REVISED -

**STATE OF ILLINOIS
 DEPARTMENT OF TRANSPORTATION**

ALIGNMENT, TIES & BENCHMARKS

SCALE: SHEET NO. 12 OF 73 SHEETS STA. 118+70 TO STA. 126+60

F.A.U. RT# 2332	SECTION 03-14185-02-BR	COUNTY KANE	TOTAL SHEETS 73	SHEET NO. 12
FED. ROAD DIST. NO. 1 ILLINOIS FED. AID PROJECT				

CONTRACT NO. 63521