

Bench Mark: Chiseled "X" on SW wingwall of SN 045-3042 (Elev. 753.96 - NGVD 29)

Existing Structure:
SN 045-3042, three span reinforced concrete slab superstructure measuring 93'-1" back to back abutments and 26'-0" out to out of deck supported on timber pile bent abutments and concrete pile bent piers. Built as SA Route 73, Section 185 B-MFT at Station 122+25.00 in 1959. The Contractor shall remove the existing structure and replace it with a two span steel beam structure on integral abutments. The road will be closed and traffic detoured during construction.

Existing guardrail and terminal sections to be salvaged. Contractor to deliver to location specified by Engineer.

Hatched areas indicate excavation required for stone riprap placement. For earth excavation quantities, see Roadway Plans.

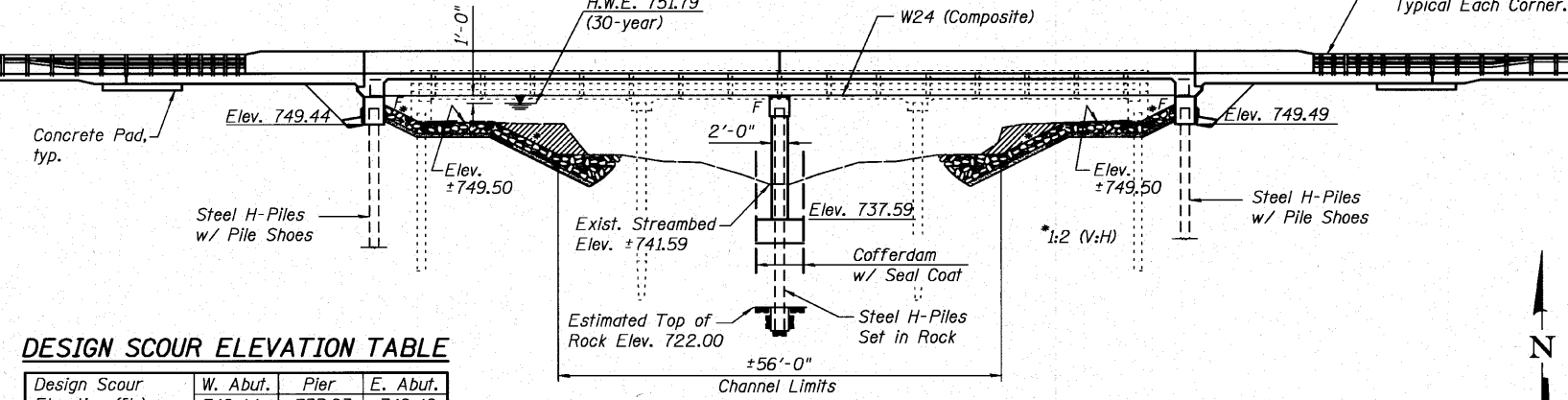

DESIGN SCOUR ELEVATION TABLE

Design Scour Elevation (ft.)	W. Abut.	Pier	E. Abut.
	749.44	733.93	749.49

ELEVATION

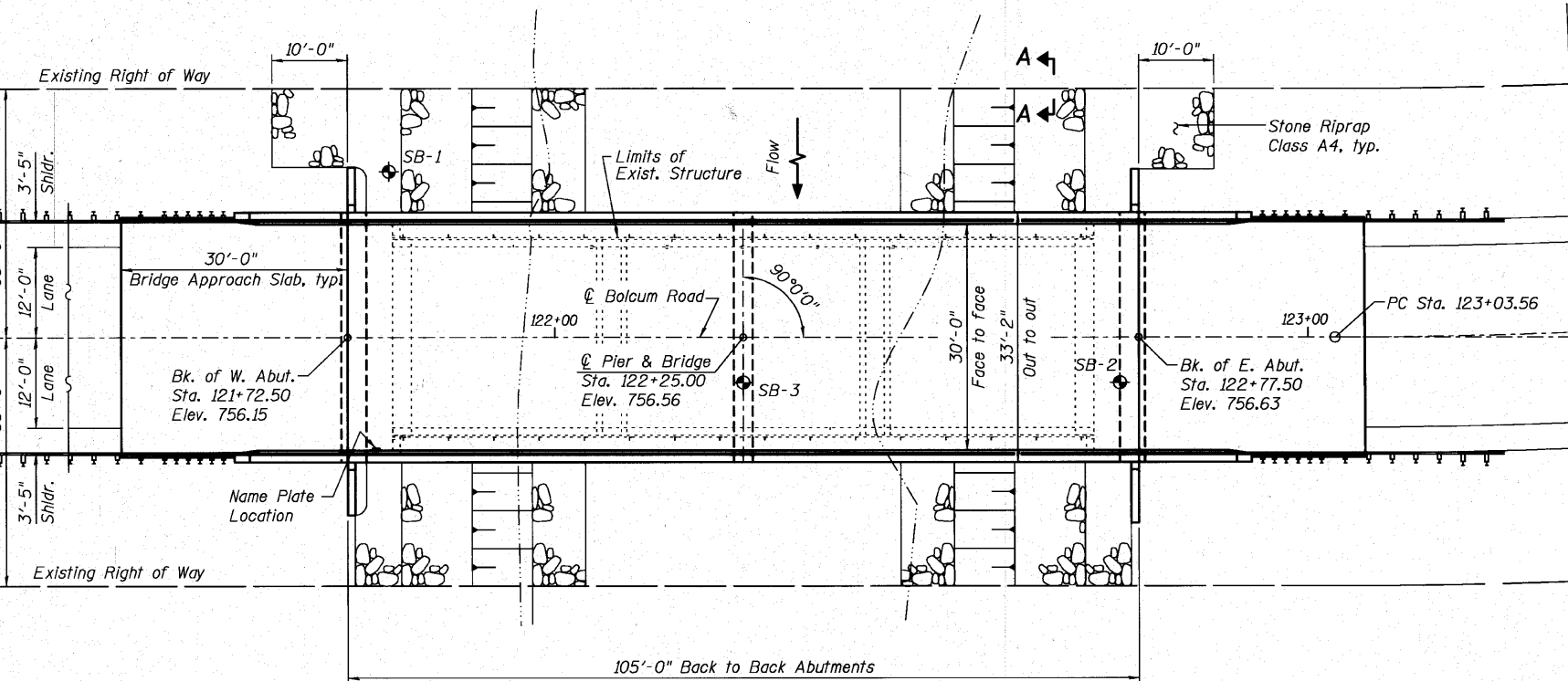

PLAN

Indicates Soil Boring Location

WATERWAY INFORMATION

Drainage Area = 43.92 sq. mi. Low Grade Elev. 752.30 Sta. 114+00

Flood	Freq. Yr.	Q C.F.S.	Opening Sq. Ft.		Nat. H.W.E.	Head - Ft.		Headwater El.	
			Exist.	Prop.		Exist.	Prop.	Exist.	Prop.
Design	30	2083	459	535	751.79	0.14	0.12	751.93	751.91
Base	100	3027	489	589	752.48	0.22	0	752.70	752.48
Overtopping	500	5649	489	640	754.10	0.03	0	754.13	754.10

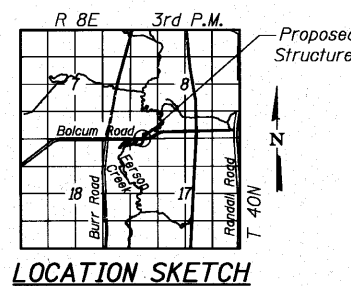

LOCATION SKETCH

FERSON CREEK
BUILT 2011 BY
ST. CHARLES TOWNSHIP
SEC. 03-14185-02-BR
F.A.U. 2332 STA. 122+25
STR. NO. 045-3020 LOADING HL 93

NAME PLATE
See Std. 515001

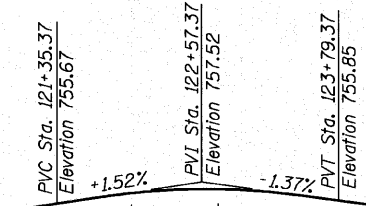

PROFILE GRADE
(Along E Bolcum Road)

Grade	Station
8%	Sta. 123+64
5.33%	Sta. 123+00
2%	Sta. 122+20
2%	Sta. 121+72
2%	Sta. 121+24

DECK CROSS-SLOPE TRANSITIONS
(Looking Upstation)

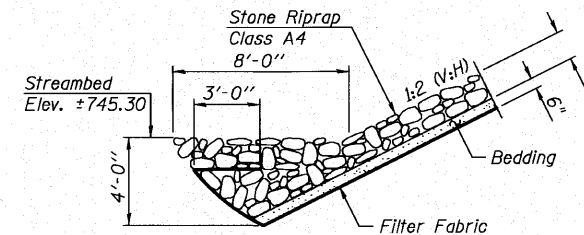

STONE RIPRAP ANCHOR DETAIL

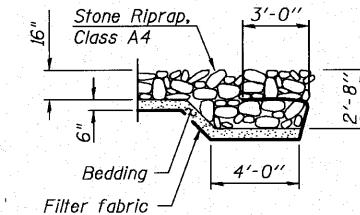

SECTION A-A

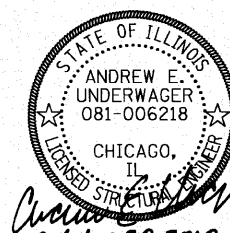

"I certify that to the best of my knowledge, information and belief, this bridge design is structurally adequate for the design loading shown on the plans. The design is an economical one for the style of structure and complies with requirements of the current 'AASHTO LRFD Bridge Design Specifications'."

GENERAL PLAN & ELEVATION
BOLCUM ROAD OVER FERSON CREEK
SECTION 03-14185-02-BR
KANE COUNTY
STATION 122+25
STRUCTURE NO. 045-3020

SHEET NO. 1 21 SHEETS	F.A.U.	SECTION	COUNTY	TOTAL SHEETS	SHEET NO.
	2332	03-14185-02-BR	KANE	73	25
CONTRACT NO. 63521					
FED. ROAD DIST. NO.		ILLINOIS	FED. AID PROJECT		

WILLS BURKE KELSEY ASSOCIATES LTD.
116 West Main Street, Suite 201
St. Charles, Illinois 60174

FILE NAME = P:\CBEL\WEST\Projects\2009\99-0802 Bolcum PH\Structure\1\Drawings\0453020-63521-001-01.dgn