

- NOTES:**
- STATIONS NOTED WITH (G) REFERENCE THE GREENLEAF AVENUE ALIGNMENT.
 - SEE SHEET 72 FOR MEDIAN NOSE DETAILS.
 - CONSTRUCT BASE COURSE MONOLITHICALLY WITH CURB & GUTTER OR CONCRETE MEDIAN WHEN WIDENING IS LESS THAN 2 FEET - SEE DETAIL.
 - ALL DRIVEWAYS SHALL BE REPLACED WITH PCC DRIVEWAY PAVEMENT, 8 INCH, SPECIAL.
 - SEE INTERSECTION GRADING PLAN FOR SIDEWALK LAYOUT DETAILS.

MATCH LINE STA. 118+75
(SEE SHEET NO. 21)

MATCH LINE STA. 95+50
(SEE SHEET NO. 17)

MATCH LINE STA. 100+50
(SEE SHEET NO. 19)

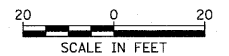
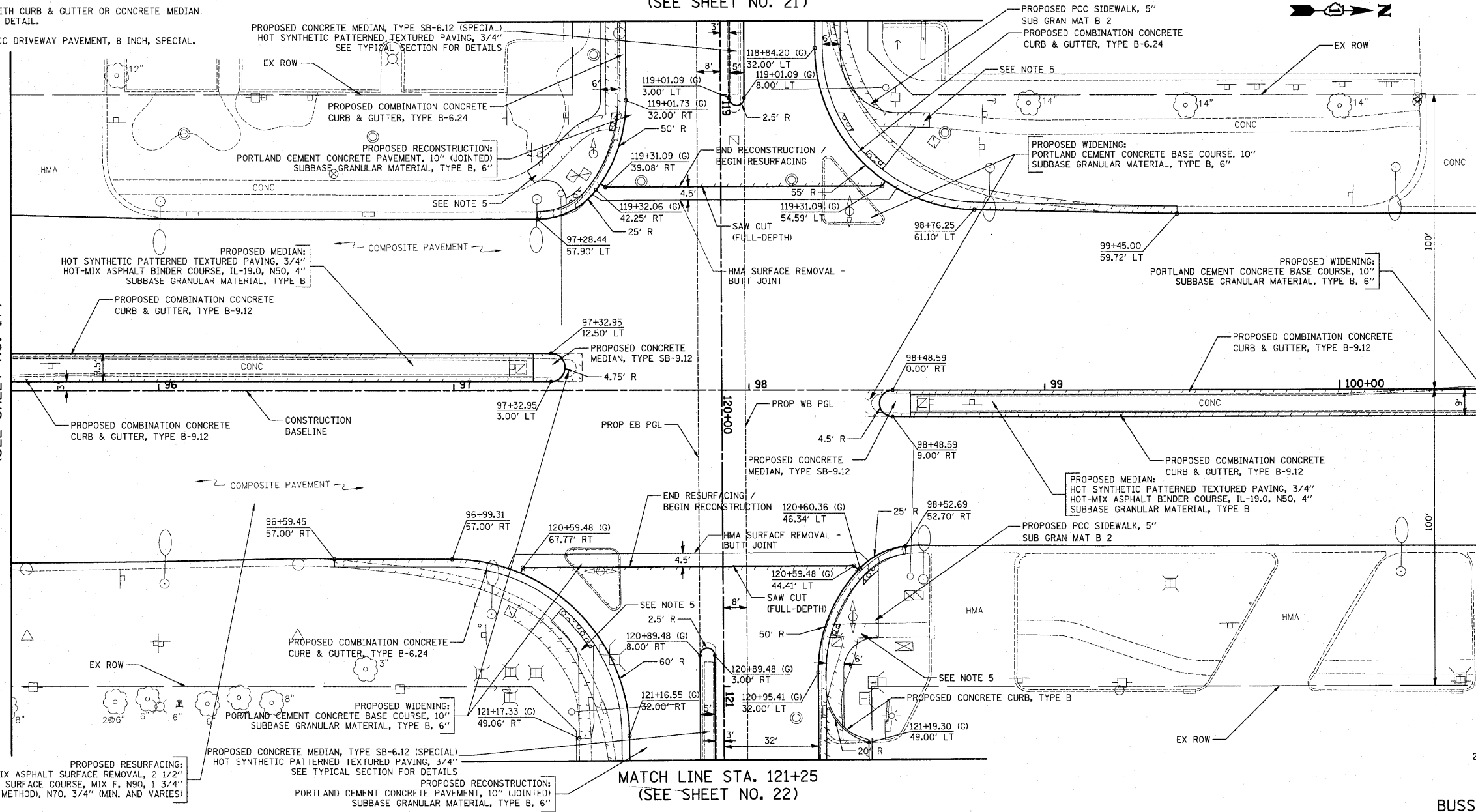

BUSSE ROAD

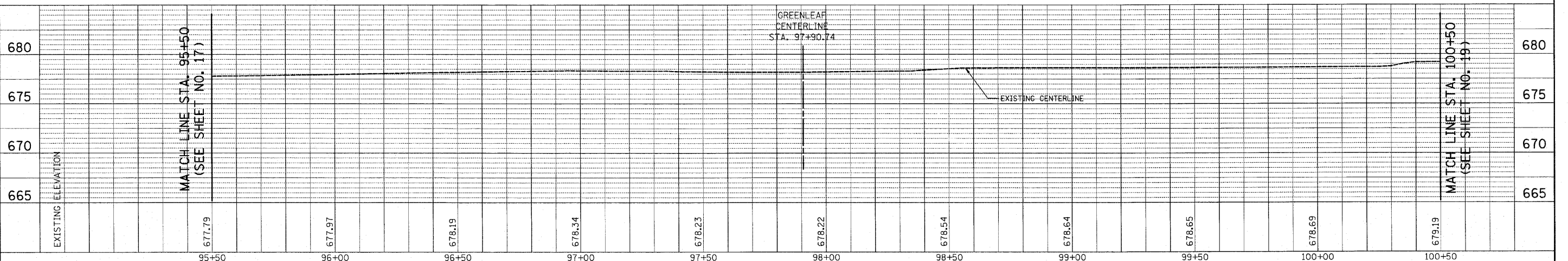

FILE NAME = ...2362\cad\sheet\2362_P&P_2.dgn	USER NAME = krk	DESIGNED - BLG	REVISED -	STATE OF ILLINOIS DEPARTMENT OF TRANSPORTATION	IL ROUTE 83 (BUSSE ROAD) AND GREENLEAF AVENUE PLAN AND PROFILE	F.A.P. RTE. 344	SECTION 09-00056-00-CH	COUNTY COOK	TOTAL SHEETS 111	SHEET NO. 18		
PLOT SCALE = 20,0000' / IN.	CHECKED - DJK	DATE - 10-22-10	REVISIONS			SCALE: 1" = 20'	SHEET NO. 2 OF 7 SHEETS	STA. 95+50.00 TO STA. 100+50.00	CONTRACT NO. 63527			
PLOT DATE = 10/21/2010	DATE - 10-22-10	REVISIONS	FED. ROAD DIST. NO. 1 ILLINOIS FED. AID PROJECT M-9003(659)									