

FOR CONTINUATION
SEE BELOW LEFT

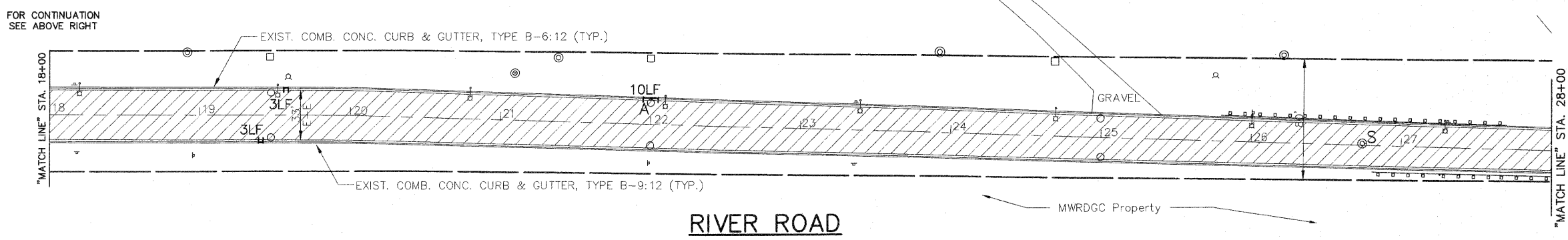

ALL SAW CUTS SHALL BE CONSIDERED INCLUDED
IN THE COST OF THE ITEM BEING REMOVED.

FOR CONTINUATION
SEE BELOW LEFT

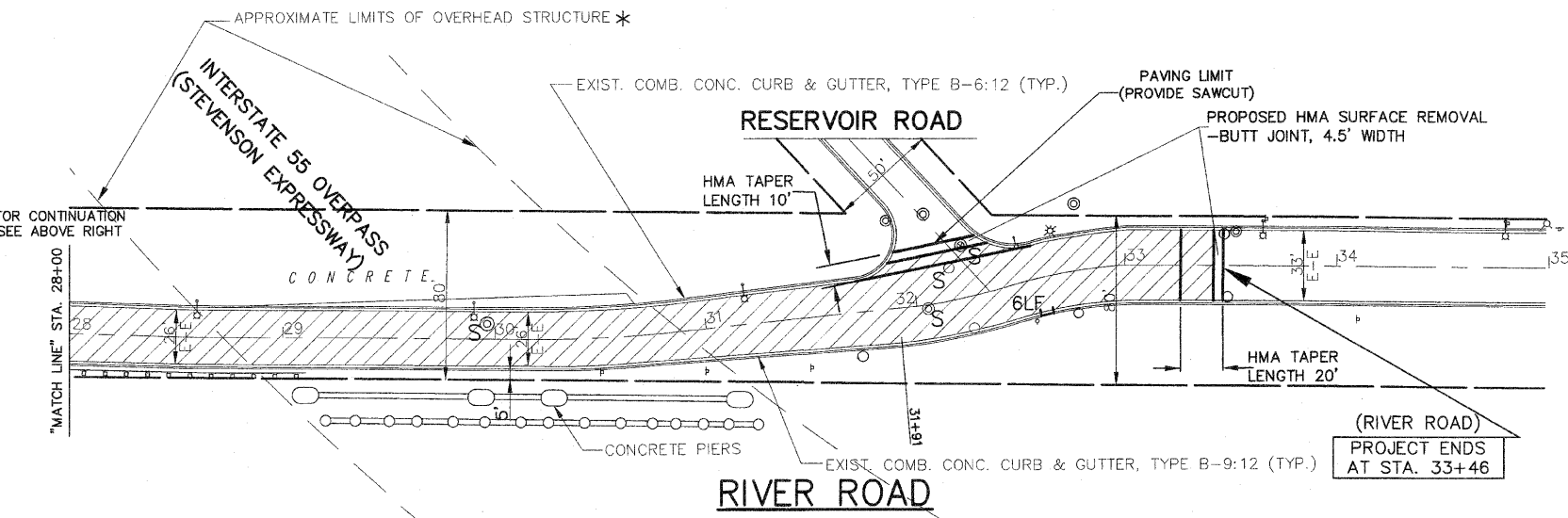

LEGEND

- DENOTES HOT-MIX ASPHALT SURFACE REMOVAL, 2-3/4 INCH, LEVELING BINDER (MACHINE METHOD), N50, 1 INCH AND HOT-MIX ASPHALT SURFACE COURSE, MIX C, N50, 1-3/4 INCH
- "A" DENOTES EXISTING CATCH BASINS TO BE ADJUSTED TO GRADE WITH NEW ADJUSTING RINGS. (ALL TOP BANDS OF FALLEN, COMMON OR CONCRETE BRICK TO BE REPLACED WITH PRECAST CONCRETE ADJUSTING RINGS)
- "S" DENOTES EXISTING FRAMES AND LIDS TO BE ADJUSTED (SPECIAL) (SEE SHEET 6 FOR DETAIL)
- DENOTES COMBINATION CURB AND GUTTER REMOVAL AND COMBINATION CONCRETE CURB AND GUTTER, TYPE B-6.12 OR B-9.12

* NOTE:
EXISTING VERTICAL CLEARANCE UNDER
I-55 OVERPASS IS IN EXCESS OF 30 FEET

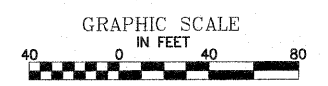

Frank Novotny & Associates, Inc.
Civil Engineering
Municipal Consultants
825 Midway Drive • Willmetts, IL • 60091 • Telephone: (630) 887-8840 • Fax: (630) 887-0139
ILLINOIS PROFESSIONAL DESIGN FIRM NO. 184-000028

F.A.U. RTE.	SECTION	COUNTY	TOTAL SHEETS
1692	09-00017-00-RS	COOK	14 4
CONTRACT NO. 63534			
FED. ROAD DIST. NO.	ILLINOIS FED. AID PROJECT	M-9003(511)	

IMPORTANT!
FULL SIZE PLANS HAVE BEEN PREPARED USING STANDARD ENGINEERING SCALES.
REDUCED SIZED PLANS WILL NOT CONFORM TO STANDARD SCALES INDICATED IN TITLE BLOCK.

FOR TYPICAL CROSS SECTION
OF NEW PAVEMENT WORK
SEE SHEET 3

FILE NAME = VILLAGE OF HODGKINS, ILLINOIS RIVER ROAD LAPP RESURFACING LEON COOK DRIVE TO RESERVOIR ROAD	USER NAME =	DESIGNED -- JLC DRAWN -- JFP-JEP CHECKED -- THK DATE -- 7-1-10	REVISED -- JLC 9-16-10 REVISED -- JLC 10-27-10 REVISED -- REVISED --
--	-------------	---	---

**STATE OF ILLINOIS
DEPARTMENT OF TRANSPORTATION**

**PLAN:
RIVER ROAD- LEON COOK DRIVE TO RESERVOIR ROAD**
SCALE: AS NOTED | SHEET NO. OF SHEETS | STA. 8+55 TO STA. 33+46
(RESURFACING)