

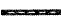

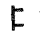





LEGEND

-  WORK AREA
-  IMPACT ATTENUATORS, TEMPORARY (NON-REDIRECTIVE, NARROW)
-  TYPE III BARRICADE
-  TEMPORARY CONCRETE BARRIER
-  DRUM WITH STEADY BURN MONODIRECTIONAL LIGHT (PER HWY. STD. 701321-10)
-  SIGN
-  DETECTOR LOOPS
-  TRAFFIC SIGNAL
-  TEMPORARY RUMBLE STRIPS
-  DOUBLE VERTICAL PANELS

PRESTAGE CONSTRUCTION:

1. CONSTRUCT TEMPORARY PAVEMENT ON SHOULDER FROM STA. 160+55 TO STA. 164+88 RT AND STA. 166+25 TO STA. 170+66 RT IN ACCORDANCE WITH HIGHWAY STANDARD 701326 AND AS SHOWN IN THE PLANS.

STAGE I CONSTRUCTION

1. REMOVE CONFLICTING PAVEMENT MARKING LINES AND RAISED REFLECTIVE PAVEMENT MARKERS.
2. CLOSE WEST HALF OF IL-84 IN ACCORDANCE WITH HIGHWAY STANDARD 701321 AND AS SHOWN IN THE PLANS.
3. PERFORM WEST HALF STRUCTURAL AND APPROACH ROADWAY RECONSTRUCTION AS SHOWN IN THE PLANS.
4. CONSTRUCT TEMPORARY PAVEMENT ON SHOULDER FROM STA. 160+91 TO STA. 162+00 LT AND STA. 169+20 TO STA. 170+73 LT.

NOTES:

1. SEE HIGHWAY STANDARD 701321 FOR PLACEMENT OF DEVICES, INFORMATION, ETC.
2. ACCESS TO BE MAINTAINED TO DRIVEWAYS AT ALL TIMES DURING CONSTRUCTION.

SEQUENCE OF OPERATIONS						
PHASE	A	B	C	D	E	F
NORTHBOUND	G	Y	R	R	R	R
SOUTHBOUND	R	R	R	R	G	Y

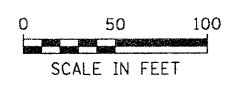
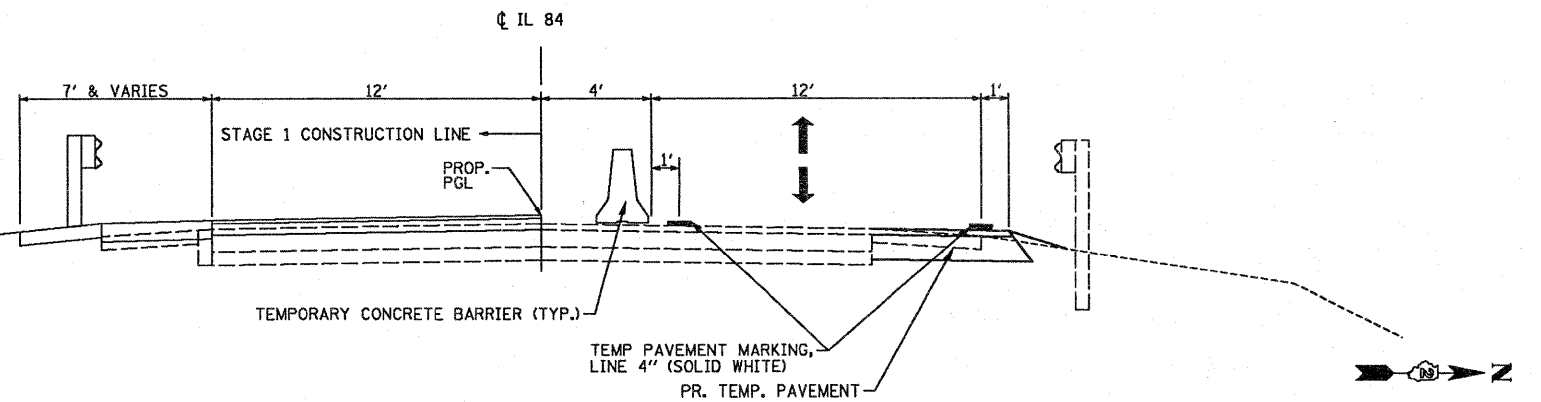
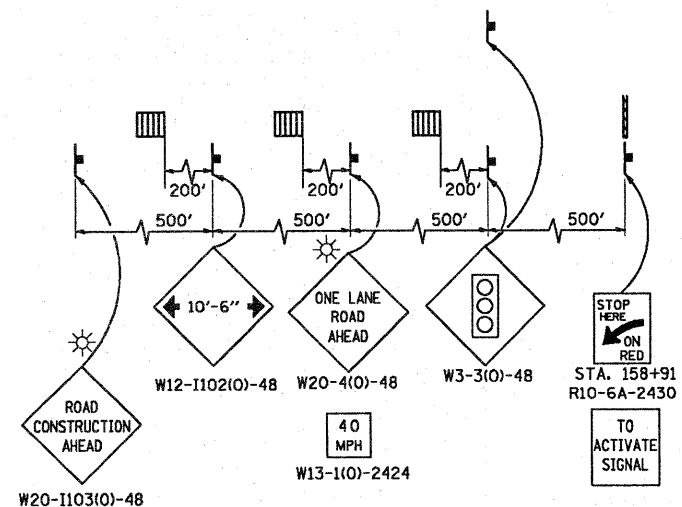
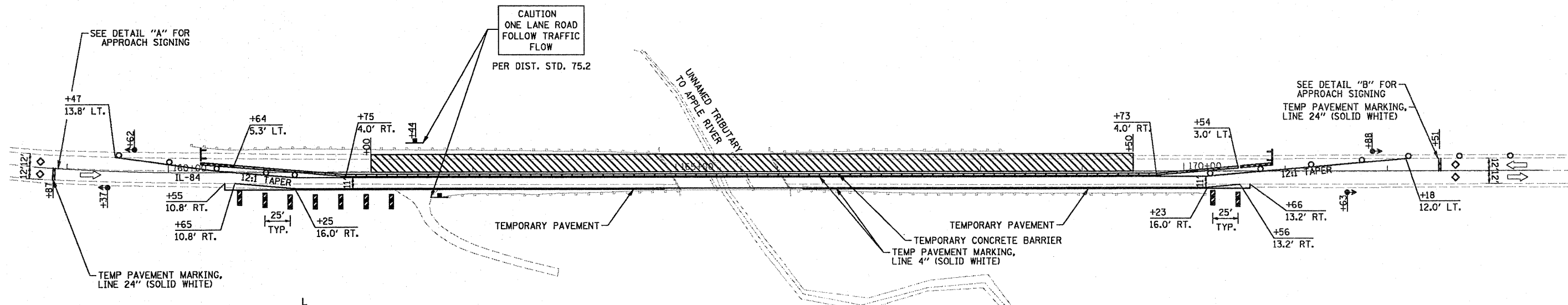
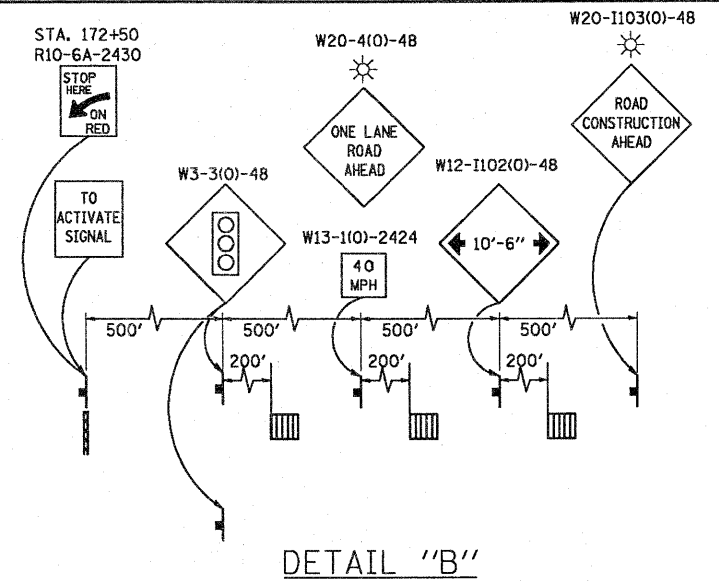

FILE NAME = ...D464b26-sh1-staging1.dgn	USER NAME = Plotted by Scott Wilkinson	DESIGNED - SEW	REVISED -	STATE OF ILLINOIS DEPARTMENT OF TRANSPORTATION	MAINTENANCE OF TRAFFIC PLAN - STAGE 1 IL-84 OVER TRIBUTARY TO APPLE RIVER			F.A.P. RTE.	SECTION	COUNTY	TOTAL SHEETS	SHEET NO.
	PLOT SCALE = 1/8" = 100' / IN.	DRAWN - SEW	REVISED -					308	103BR-3 & 104BR-1	JO DAVIESS	126	24
	PLOT DATE = 12/1/2010	CHECKED - FML	REVISED -					CONTRACT NO. 64B26				
	DATE = 10-15-2010	DATE - 10-15-2010	REVISED -					ILLINOIS FED. AID PROJECT				
				SCALE: 1" = 50'			SHEET NO. 1 OF 1 SHEETS		STA. 159+00 TO STA. 173+00			