

CONSULTANT: BRIAN MALONE (630-969-7000)

PROJECT ENGINEER: REBECCA MARRUFFO

DISTRICT 2 BUREAU OF DESIGN
SQUAD LEADER: CHRIS CONDORIAN (815-284-5955)

F.A.P. RTE.	SECTION	COUNTY	TOTAL SHEETS	SHEET NO.
638	129BR-4	HENRY	93	1
		ILLINOIS	CONTRACT NO. 64D25	

INDEX OF SHEETS

- 1 COVER SHEET
- 2 GENERAL NOTES AND STANDARDS
- 3 HORIZONTAL & VERTICAL CONTROL
- 4-5 SUMMARY OF QUANTITIES
- 6-10 SCHEDULE OF QUANTITIES
- 11-12 TYPICAL SECTIONS
- 13-15 EXISTING AND PROPOSED PLAN & PROFILE
- 16 MAINTENANCE OF TRAFFIC TYPICAL SECTIONS
- 17-20 MAINTENANCE OF TRAFFIC STAGING PLANS
- 21 EROSION AND SEDIMENT CONTROL PLAN
- 22-50 STRUCTURE PLANS - BRIDGE (SN 037-0176)
- 51-55 STRUCTURE PLANS - CULVERT EXTENSION (SN 037-1085)
- 56 PROPOSED DETAILED GRADING PLAN AT BRIDGE
- 57 PAVEMENT DETAILED GRADING - BRIDGE CONNECTOR
- 58 PAVEMENT DETAILED GRADING - TRANSITIONS
- 59 RIGHT OF WAY PLAT
- 60 CONSTRUCTION DETAILS
- 61-69 IDOT REGION 2/ DISTRICT 2 STANDARDS
- 70-76 MAINTENANCE OF TRAFFIC CROSS SECTIONS
- 77-93 CROSS SECTIONS

FOR LIST OF HIGHWAY STANDARDS, SEE SHEET NO. 2

 ROBERT TESSITORE REGISTERED PROFESSIONAL ENGINEER OF ILLINOIS EXPIRES: 11-30-2011 SHEETS 1-15, 56-58, 60, 77-93	 FRED M. LIN LICENSED PROFESSIONAL ENGINEER OF ILLINOIS EXPIRES: 11-30-2011 SHEETS 16-21, 51-55, 70-76	 BRIAN J. MALONE LICENSED STRUCTURAL ENGINEER OF ILLINOIS EXPIRES: 11-30-2012 SHEETS 22-50
--	--	--

Wight
 Wight & Company
 2500 North Frontage Road, Darien, IL 60561
 630.969.7000 630.969.7979 fax
 Design Firm Registration 184-000451

Lin Engineering, Ltd.
 Consulting Engineers
 Chatham, Illinois Westmont, Illinois

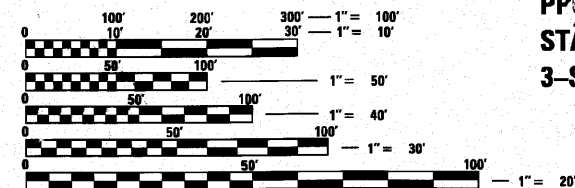

FULL SIZE PLANS HAVE BEEN PREPARED USING STANDARD ENGINEERING SCALES. REDUCED SIZED PLANS WILL NOT CONFORM TO STANDARD SCALES. IN MAKING MEASUREMENTS ON REDUCED PLANS, THE ABOVE SCALES MAY BE USED.

J.U.L.I.E.
 JOINT UTILITY LOCATION INFORMATION FOR EXCAVATION
 1-800-892-0123
 OR 811

STATE OF ILLINOIS

DEPARTMENT OF TRANSPORTATION

DIVISION OF HIGHWAYS

PROPOSED HIGHWAY PLANS

FAP ROUTE 638 (IL ROUTE 82)
SECTION 129BR-4
PROJECT F-0638(023)
BRIDGE REPLACEMENT AND EXTENSION
OF EXISTING ACROSS ROAD BOX CULVERT
HENRY COUNTY

D-92-065-07
 92-118-10
 GENESEO TOWNSHIP SEC 4 - SW 1/4
 Rte

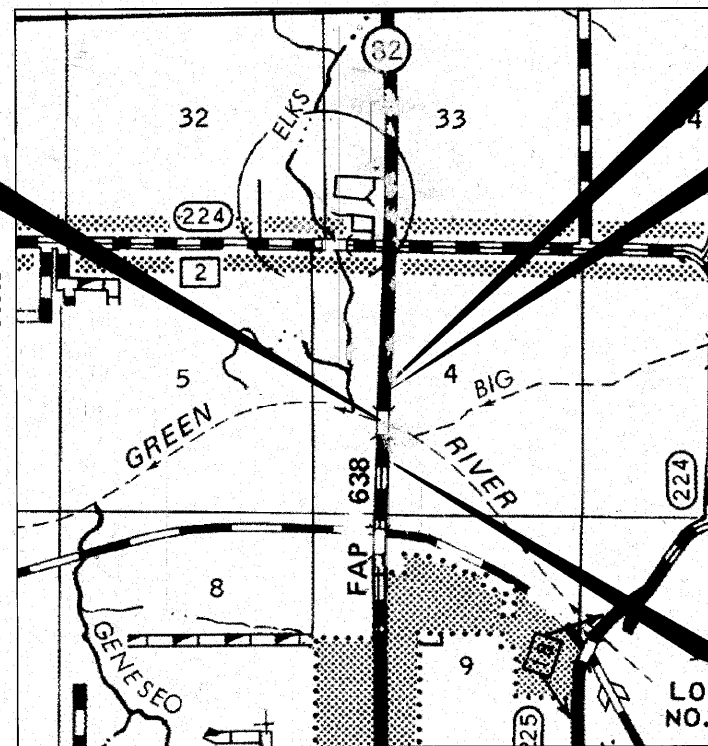

IMPROVEMENT & SECTION ENDS
 STA 1271+25.00

BOX CULVERT EXTENSION
 SN 037-1085
 STA 1259+05.61

N
 LOCATION MAP
 NOT TO SCALE

SECTION BEGINS
 STA 1259+50.00

IMPROVEMENT BEGINS
 STA 1258+01.00

GROSS LENGTH = 1175.00 FT. = 0.223 MILE
 NET LENGTH = 978.50 FT. = 0.185 MILE

PROJECT LOCATED ON
 IL ROUTE 82 OVER GREEN RIVER
 4.5 MI. SOUTH OF IL ROUTE 92

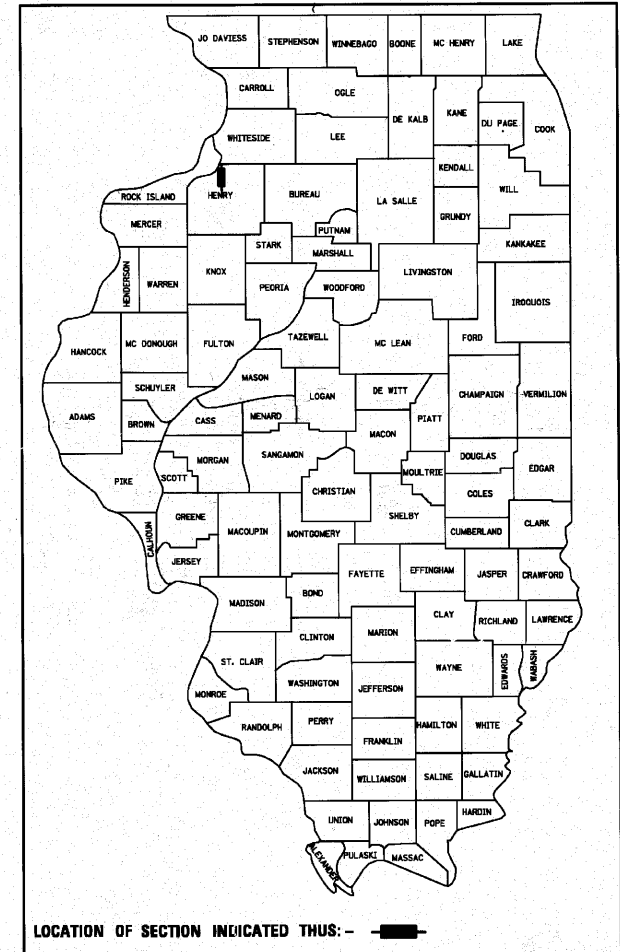

FUNCTIONAL CLASSIFICATION
RURAL MINOR ARTERIAL
 2010 ADT = 5675
 SPEED LIMIT: 55 MPH

STATE OF ILLINOIS
 DEPARTMENT OF TRANSPORTATION
 DIVISION OF HIGHWAYS

SUBMITTED 11/15 2010

Debra F. Ryan
 DEPUTY DIRECTOR OF HIGHWAYS, REGION ENGINEER

December 10, 2010
Scott E. Stith, P.E.
 acting ENGINEER OF DESIGN AND ENVIRONMENT

December 10, 2010
Christine M. Roedel
 DIRECTOR OF HIGHWAYS, CHIEF ENGINEER

**PRINTED BY THE AUTHORITY
 OF THE STATE OF ILLINOIS**

CONTRACT NO. 64D25

FAP ROUTE 638 HENRY COUNTY SECTION 129BR-4