









**LEGEND**

-  WORK AREA
-  IMPACT ATTENUATORS, TEMPORARY (NON-REDIRECTIVE) TEST LEVEL 3
-  TYPE III BARRICADE
-  TEMPORARY CONCRETE BARRIER
-  DRUM WITH STEADY BURN MONODIRECTIONAL LIGHT / DIRECTION INDICATOR BARRICADE WITH STEADY BURN MONODIRECTIONAL LIGHT (PER HWY. STD. 701321-10)
-  SIGN
-  DETECTOR LOOPS
-  TRAFFIC SIGNAL
-  DOUBLE VERTICAL PANELS

**STAGE 2 CONSTRUCTION**

1. CLOSE WEST HALF OF IL 82 IN ACCORDANCE WITH HIGHWAY STANDARD 701321 AND AS SHOWN IN THE PLANS.
2. REMOVE TEMPORARY PAVEMENT ON THE WEST SIDE.
3. PERFORM WEST HALF STRUCTURAL AND ROADWAY RECONSTRUCTION BETWEEN THE LIMITS AS SHOWN IN THE PLANS.

**STAGE 3 CONSTRUCTION**

1. COMPLETE REMAINDER OF SHOULDER CONSTRUCTION, PLACE SURFACE COURSE ON THE TRAFFIC LANES, PLACE THE TOP LIFT ON THE HMA SHOULDERS AND APPLY PERMANENT PAVEMENT MARKINGS UNDER HIGHWAY STANDARD 701311.

**NOTES:**

1. ALL SIGNS SHALL BE MOUNTED WITH MONODIRECTIONAL FLASHING BEACONS.
2. SEE HIGHWAY STANDARD 701321 FOR PLACEMENT OF TRAFFIC SIGNAL DETECTOR LOOPS.

SEQUENCE OF OPERATIONS									
PHASE	A	B	C						
INTERVAL	1	2	3	4	5	6	7	8	9
NORTHBOUND	G	Y	R	R	R	R	R	R	R
SOUTHBOUND	R	R	R	G	Y	R	R	R	R

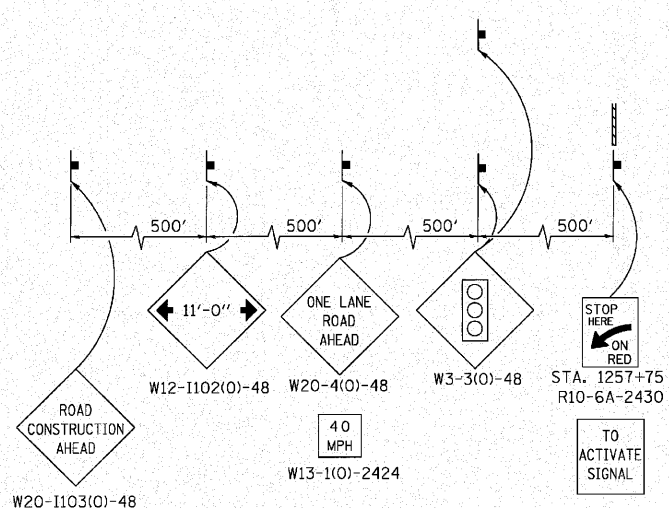
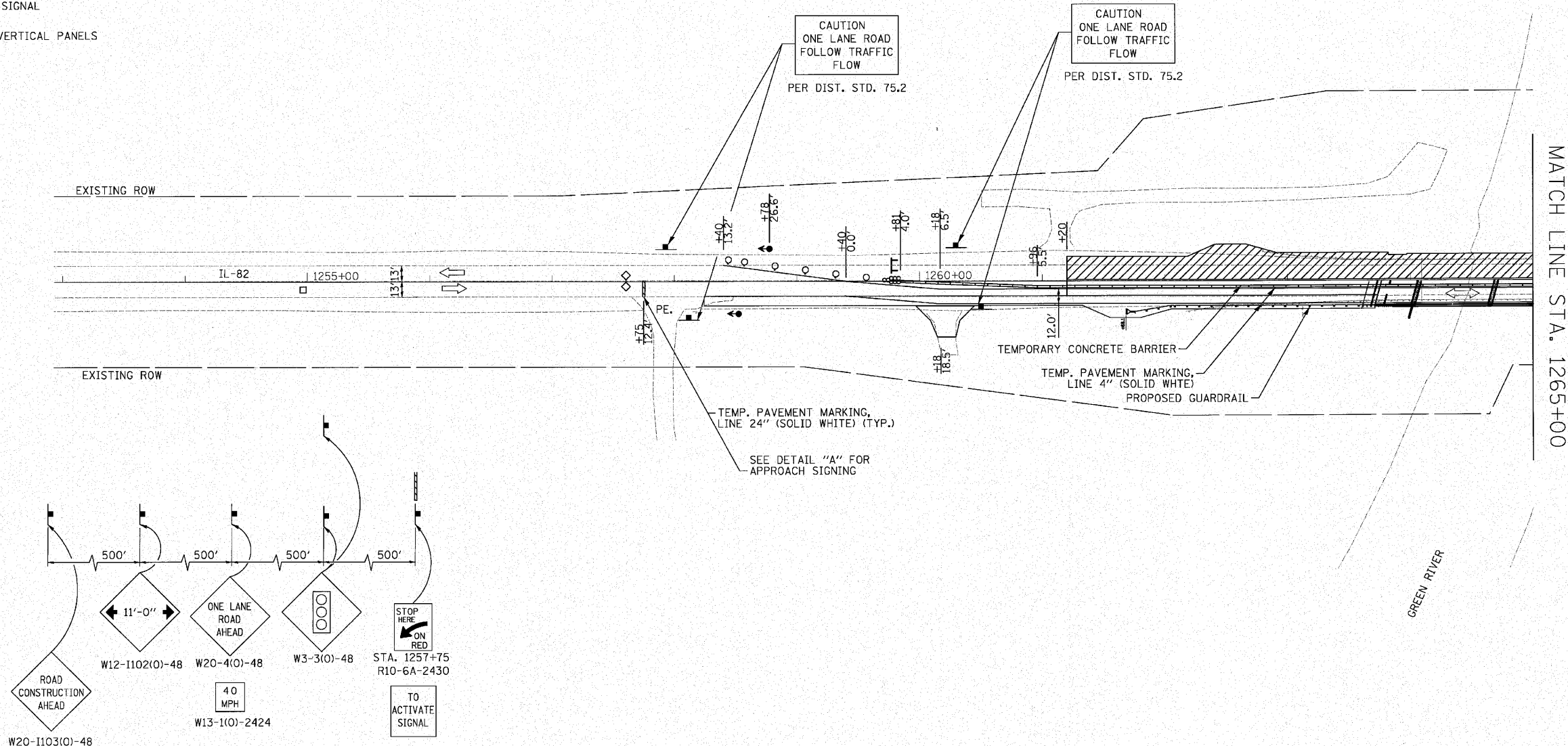

MATCH LINE STA. 1265+00

GREEN RIVER

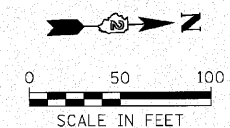

	USER NAME = #USER#	DESIGNED - CRV	REVISED -	<b>STATE OF ILLINOIS</b> <b>DEPARTMENT OF TRANSPORTATION</b>	<b>MAINTENANCE OF TRAFFIC PLAN - STAGE 2</b> <b>IL 82 OVER GREEN RIVER</b>			F.A.P. RTE.	SECTION	COUNTY	TOTAL SHEETS	SHEET NO.
	PLOT SCALE = #SCALE#	DRAWN - CRV	REVISED -		638	129BR-4	HENRY	93	19			
	PLOT DATE = #DATE#	CHECKED - ST	REVISED -		SCALE: 1" = 50'    SHEET NO. 1 OF 2 SHEETS    STA. 1253+00 TO STA. 1265+00			[ILLINOIS] FED. AID PROJECT				
		DATE - 07/2010	REVISED -									