

**INSIDE ELEVATION OF PARAPET**

**SUPERSTRUCTURE  
BILL OF MATERIAL**

Bar	No.	Size	Length	Shape
d(E)	788	#5	21'-3"	—
a1(E)	526	#5	20'-5"	—
a2(E)	788	#6	6'-6"	—
a3(E)	8	#5	21'-11"	—
b(E)	276	#5	35'-5"	—
b1(E)	88	#7	36'-0"	—
b2(E)	294	#5	30'-10"	—
d(E)	430	#5	5'-7"	—
d1(E)	430	#5	7'-5"	—
e(E)	84	#4	18'-4"	—
e1(E)	28	#4	7'-5"	—
e2(E)	28	#4	8'-3"	—
e3(E)	42	#4	16'-11"	—
e4(E)	8	#8	31'-3"	—
e5(E)	4	#8	7'-5"	—
e6(E)	4	#8	8'-3"	—
e7(E)	4	#8	29'-2"	—
e8(E)	8	#4	29'-2"	—
e9(E)	4	#4	7'-5"	—
e10(E)	4	#4	8'-3"	—
e11(E)	4	#4	27'-1"	—
m(E)	20	#6	22'-2"	—
m1(E)	24	#6	10'-10"	—
m2(E)	24	#6	5'-9"	—
m3(E)	4	#6	1'-9"	—
m4(E)	32	#4	7'-1"	—
m5(E)	12	#8	5'-11"	—
m6(E)	12	#6	2'-9"	—
m7(E)	16	#4	3'-4"	—
s(E)	84	#5	6'-10"	—
s1(E)	60	#4	11'-0"	—
s2(E)	60	#4	11'-0"	—
v(E)	88	#5	4'-0"	—
Floor Drains		Each	24	
Concrete Superstructure		Cu. Yd.	316	
Bridge Deck Grooving		Sq. Yd.	830	
Protective Coat		Sq. Yd.	1040	
Reinforcement Bars, Epoxy Coated		Pounds	75370	
Bar Splicers		Each	781	

Bars indicated thus 1 x 2-#5 etc. indicates 1 line of bars with 2 lengths per line.

**MINIMUM BAR LAP**

#4 bar = 2'-7"  
#8 bar = 6'-9"

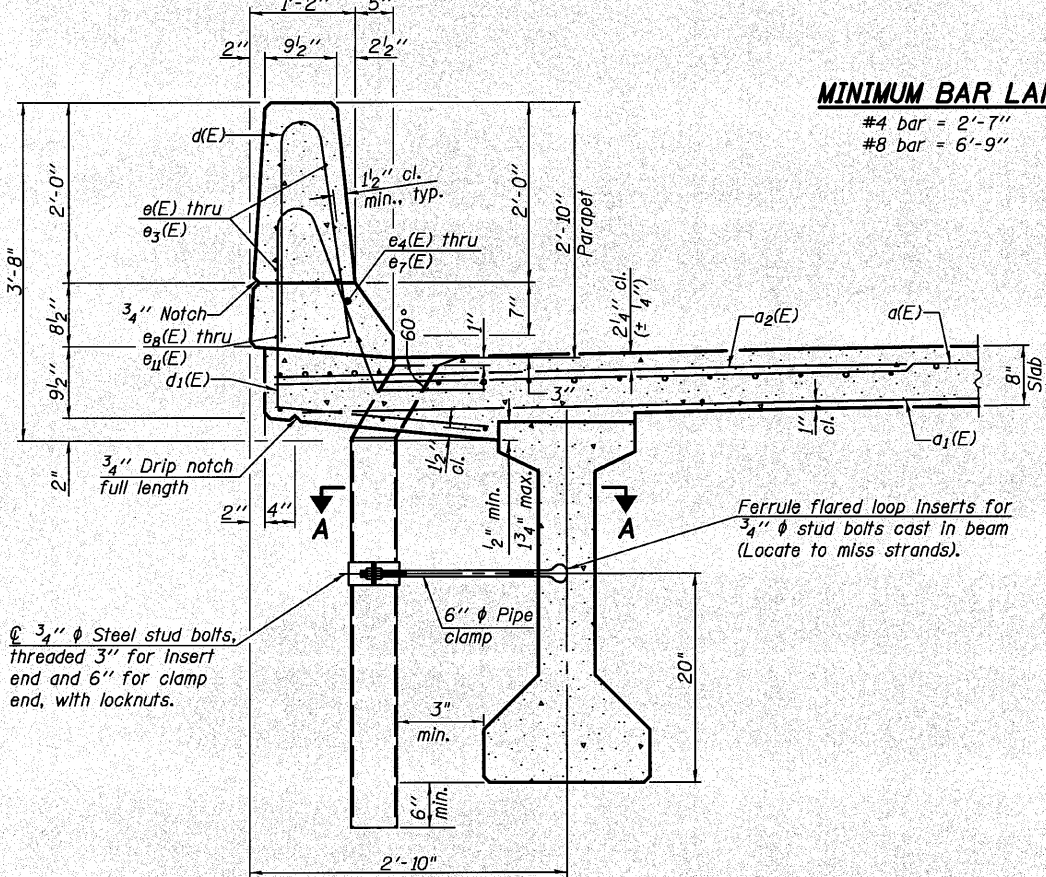

**SECTION THRU PARAPET**  
\*\*For insert locations See sheet 18 of 29.

Non-staining gray one component non-sag elastomeric gun grade polyurethane sealant meeting the requirements of ASTM C-920, Type S, Grade NS, Class 25. Use T with a 5/8" backer rod.

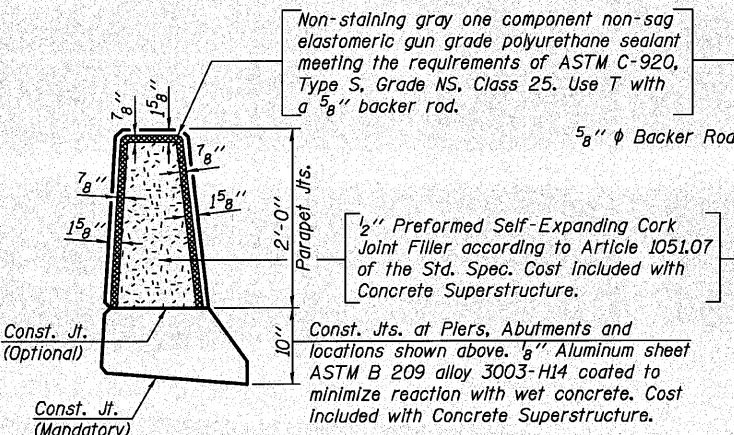

**PARAPET JOINT DETAILS**

**Notes:**  
Fiberglass pipe shall conform to ASTM D2996, with short-time rupture strength hoop tensile stress of 30,000 p.s.i. minimum.  
The exterior surfaces of the floor drains shall be coated or pigmented by the manufacturer with a color that matches the concrete.  
The clamping device and inserts shall be galvanized according to AASHTO M 232. Cost of clamping device and galvanizing included with Floor Drains.

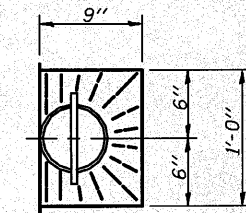

**TOP PLAN**

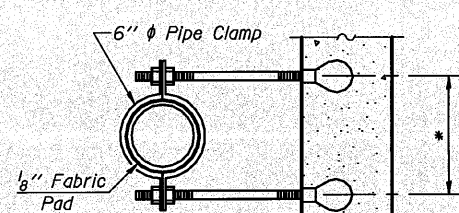

**SECTION A-A**  
\*Dimension as required by Pipe Clamp

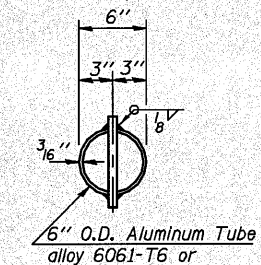

**TOP PLAN**  
(Showing Aluminum Tube)

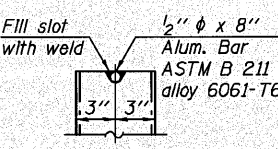

**ALUMINUM TUBE**

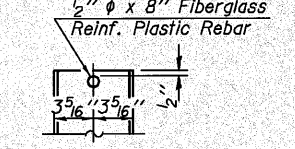

**FIBERGLASS PIPE**

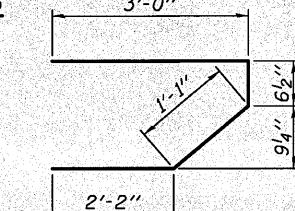

**BAR s(E)**

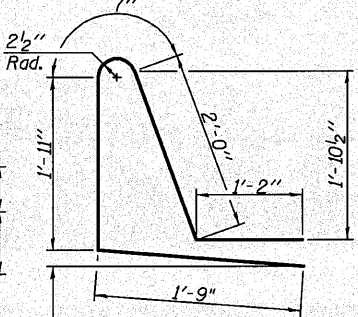

**BAR d1(E)**

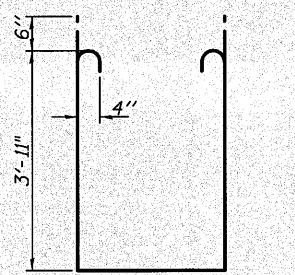

**BAR s1(E)**

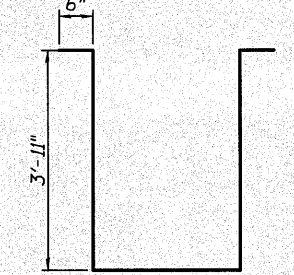

**BAR s2(E)**

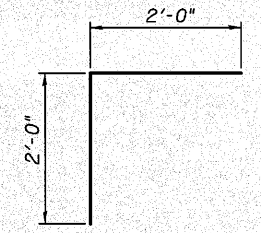

**BAR v(E)**



DESIGNED - JNH	REVISED -
CHECKED - BJM	REVISED -
DRAWN - JNH	REVISED -
CHECKED - BJM	REVISED -

**STATE OF ILLINOIS  
DEPARTMENT OF TRANSPORTATION**

**SUPERSTRUCTURE DETAILS  
STRUCTURE NO. 037-0176  
SHEET NO. 13 OF 29 SHEETS**

F.A.P. RTE.	SECTION	COUNTY	TOTAL SHEETS	SHEET NO.
638	1298R-4	HENRY	93	34
			CONTRACT NO. 64D25	
[ILLINOIS] FED. AID PROJECT				

11/22/2010 10:05:09 AM C:\ENR\06-07\96-44\02 Bridge Phase 2\11.02.CAD\Structure\Sh\0370176\_04D25.dwg SUPERSTRUCTURE DETAILS