

STATE OF ILLINOIS  
 DEPARTMENT OF TRANSPORTATION  
 DIVISION OF HIGHWAYS

**PROPOSED  
 HIGHWAY PLANS**

VARIOUS ROUTES  
 SECTION D2 DECK SEALING 2011-1

BRIDGE DECK SEALING  
 VARIOUS COUNTIES

C-92-002-11

F.A. RTE.	SECTION	COUNTY	TOTAL SHEETS	SHEET NO.
			7 #	1
ILLINOIS			CONTRACT NO. 64G32	

# 7+1 = 8

D-92-094-10

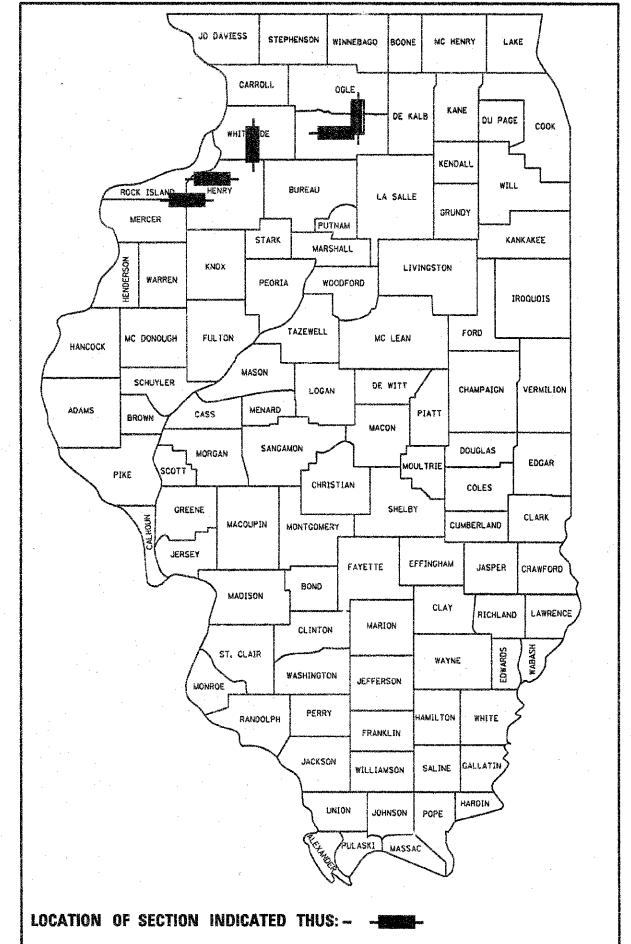

FOR INDEX OF SHEETS, SEE SHEET NO. 2

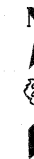
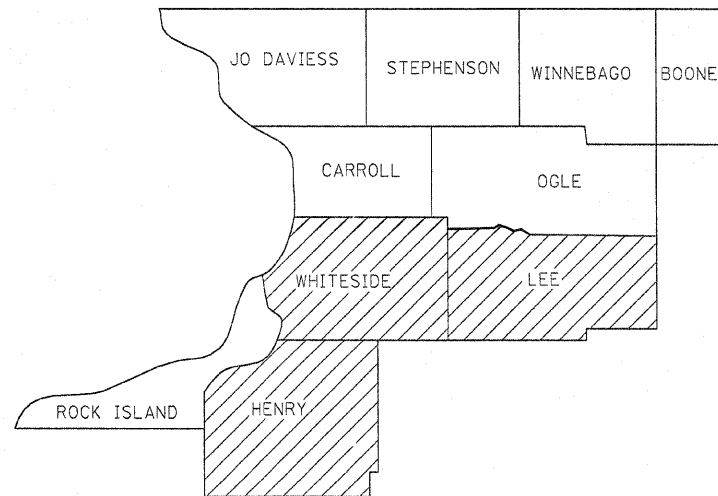

**DISTRICT 2**

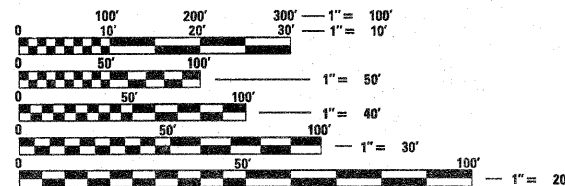

FULL SIZE PLANS HAVE BEEN PREPARED USING STANDARD ENGINEERING SCALES. REDUCED SIZED PLANS WILL NOT CONFORM TO STANDARD SCALES. IN MAKING MEASUREMENTS ON REDUCED PLANS, THE ABOVE SCALES MAY BE USED.

J.U.L.I.E.  
 JOINT UTILITY LOCATION INFORMATION FOR EXCAVATION  
 1-800-892-0123  
 OR 811

PROJECT ENGINEER MAHMOUD ETEMADI 815/284-5393

CONTRACT NO. 64G32

STATE OF ILLINOIS  
 DEPARTMENT OF TRANSPORTATION  
 DIVISION OF HIGHWAYS

SUBMITTED Oct 8 20 10  
Maureen F. Ryan  
 DEPUTY DIRECTOR OF HIGHWAYS, REGION ENGINEER

December 10 20 10  
Scott E. Stitt, P.E.  
 Acting ENGINEER OF DESIGN AND ENVIRONMENT

December 10 20 10  
Christine M. Reed  
 DIRECTOR OF HIGHWAYS, CHIEF ENGINEER

**PRINTED BY THE AUTHORITY  
 OF THE STATE OF ILLINOIS**

# INDEX OF SHEETS

1. Cover sheet
  2. General Notes
  3. Summary of Quantities
  4. Schedule of Quantities
  5. Location Maps
  6. Sealing Detail
  7. Traffic Control Detail
- 7A. District Standard for Turnbays to remain open

# GENERAL NOTES

The concrete sealer shall be applied to the entire top surface of the deck, including the inside faces and tops of parapets.

Water based concrete sealers will not be allowed.

# HIGHWAY STANDARDS

- 701006-03
- 701101-02
- 701201-04
- 701301-04
- 701421-03
- 701606-07
- 701701-07
- 701801-04
- 701901-01

Various Routes  
D2 Deck Sealing 2011-1  
Various Counties

FILE NAME =	USER NAME = lmkdj	DESIGNED -	REVISED -	<b>STATE OF ILLINOIS DEPARTMENT OF TRANSPORTATION</b>	<b>General Notes</b>	F.A. RTE.	SECTION	COUNTY	TOTAL SHEETS	SHEET NO.	
G:\BRY\CADD plans\Various Counties\2011 deck sealing\Rock River\PLA\Neng.dgn	DRAWN -	REVISED -									
PLOT SCALE = 50.0000' / 1".	CHECKED -	REVISED -									
PLOT DATE = Wed Oct 06 11:30:46 2010	DATE -	REVISED -									
					SCALE: _____	SHEET NO. ____ OF ____ SHEETS		STA. _____ TO STA. _____		ILLINOIS FED. AID PROJECT	
										CONTRACT NO. 64G32	

# SUMMARY OF QUANTITIES

100% State

PAY ITEM #	DESCRIPTION	UNIT	0021 QUANTITY
58700300	CONCRETE SEALER	SQ FT	307,841
67100100	MOBILIZATION	L SUM	1
70100310	TRAFFIC CONTROL AND PROTECTION, STANDARD 701421	L SUM	1
70100450	TRAFFIC CONTROL AND PROTECTION, STANDARD 701201	L SUM	1
70102632	TRAFFIC CONTROL AND PROTECTION, STANDARD 701602	L SUM	1
70102635	TRAFFIC CONTROL AND PROTECTION, STANDARD 701701	L SUM	1
70102640	TRAFFIC CONTROL AND PROTECTION, STANDARD 701801	L SUM	1

Various Routes  
D2 Deck Sealing 2011-1  
Various Counties

FILE NAME =	USER NAME = lmkdj	DESIGNED -	REVISED -	<b>STATE OF ILLINOIS DEPARTMENT OF TRANSPORTATION</b>	<b>SUMMARY OF QUANTITIES</b>	F.A. RTE:	SECTION	COUNTY	TOTAL SHEETS	SHEET NO.	
Q:\BRYCADD plans\Various Counties\2011 deck sealing\Rock River\PLMeng.dgn	DRAWN -	REVISED -									
PLOT SCALE = 50.0000' / IN.	CHECKED -	REVISED -									
PLOT DATE = Wed Oct 06 11:30:40 2010	DATE -	REVISED -									
SCALE: _____ SHEET NO. ___ OF ___ SHEETS STA. _____ TO STA. _____						CONTRACT NO. 64632 ILLINOIS FED. AID PROJECT					

# SCHEDULE OF QUANTITIES

## Concrete Sealer

Location				Deck Length (Ft)	Deck Width (Ft)	Parapet Left (Ft)	Parapet Right (Ft)	AREA (SQ FT)	TC&P
Henry County									
Structure Number	Facility Carried	Feature Crossed	Location						
037-0128	IL 84	Rock River	Henry/Rock Island County Line	984	87.4	3.77	3.77	93,421	701421 & TC Detail
037-0149	IL 92	Rock River	Henry/Rock Island County Line	1120.3	32	3.77	3.77	44,297	701201
Lee County									
Structure Number									
052-0063	IL 2	Rock River	Grand Detour	1032.6	40	3.77	3.77	49,090	701201
052-0072	US 52/IL 2/IL 26	Rock River	Dixon	713	102.7	6.44	6.44	82,409	701602 & 701701
Whiteside County									
098-0100	IL 78	Rock River	North edge of Prophetstown	805.7	40.4	3.77	3.77	38,625	701201
								307,841	

Note: No Lane closures will be allowed at the 052-0072 Dixon location from 12:00 PM to 6:00 PM Monday through Friday.

Various Routes  
D2 Deck Sealing 2011-1  
Various Counties

FILE NAME =	USER NAME = linkdj	DESIGNED -	REVISED -	<b>STATE OF ILLINOIS DEPARTMENT OF TRANSPORTATION</b>	<b>SCHEDULE OF QUANTITIES</b>			F.A. RTE.	SECTION	COUNTY	TOTAL SHEETS	SHEET NO.			
G:\BRYCADD plans\Various Counties\2011 deck sealing\Rock River\PLANeng.dgn		DRAWN -	REVISED -												
		CHECKED -	REVISED -												
		DATE -	REVISED -					SCALE: _____	SHEET NO. _____ OF _____ SHEETS	STA. _____ TO STA. _____	CONTRACT NO. 64C32		7	4	
							ILLINOIS FED. AID PROJECT								

# LOCATION MAPS

Henry/Rock Island Counties

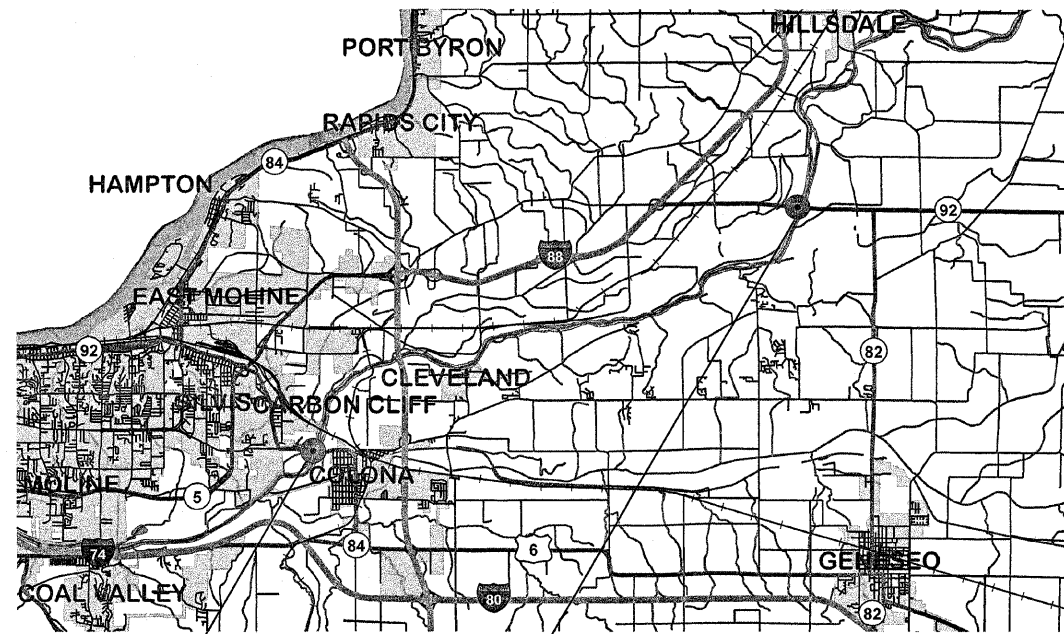

SN 037-0128

SN 037-0149

Lee County

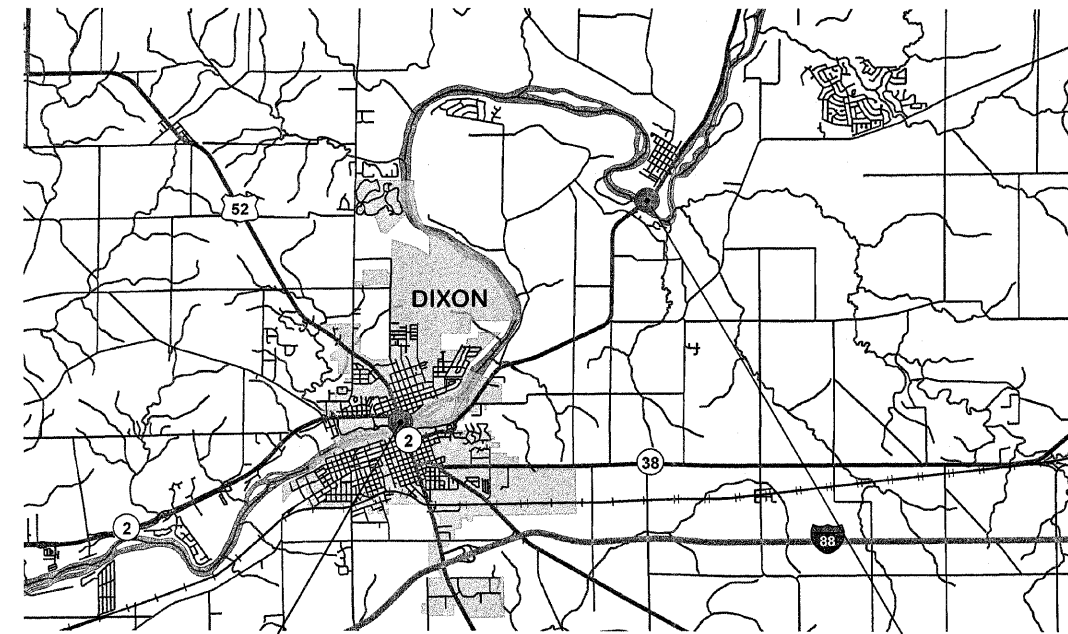

SN 052-0072

SN 052-0063

Whiteside County

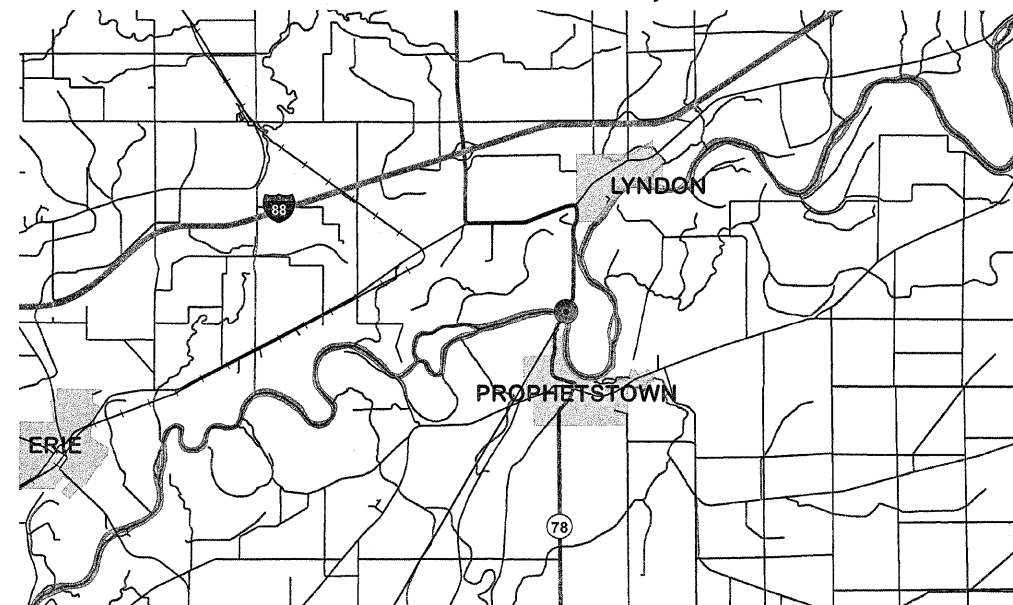

SN 098-0100

Various Routes  
D2 Deck Sealing 2011-1  
Various Counties

FILE NAME =	USER NAME = lmkd	DESIGNED -	REVISED -	<b>STATE OF ILLINOIS DEPARTMENT OF TRANSPORTATION</b>	<b>LOCATION MAPS</b>			F.A. RTE.	SECTION	COUNTY	TOTAL SHEETS	SHEET NO.
G:\BR\CADD\plans\Various Counties\2011\dek sealing\Rock River\PLANeng.dgn		DRAWN -	REVISED -		SCALE: _____	SHEET NO. _____ OF _____ SHEETS	STA. _____ TO STA. _____	_____	_____	_____	7	5
	PLOT SCALE = 52.0000' / IN.	CHECKED -	REVISED -		CONTRACT NO. 64G32							
	PLOT DATE = Wed Oct 26 11:30:28 2010	DATE -	REVISED -		ILLINOIS FED. AID PROJECT							

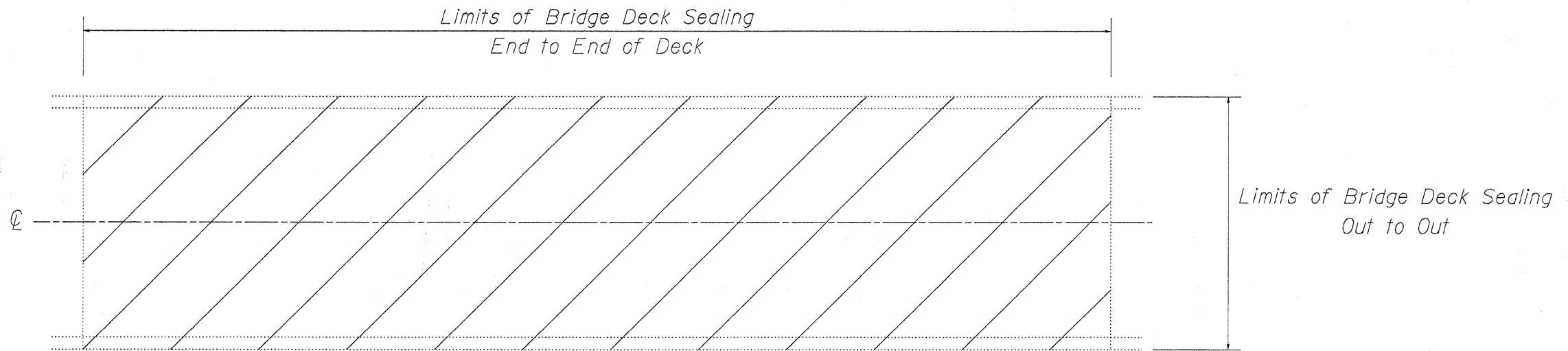

PLAN VIEW

Existing pavement markings shall be temporarily covered prior to application of the deck surface treatment, to prevent the material from being applied to the markings. The temporary covering shall be removed after application of the deck surface treatment and prior to opening to traffic. Cost included with Concrete Sealer.

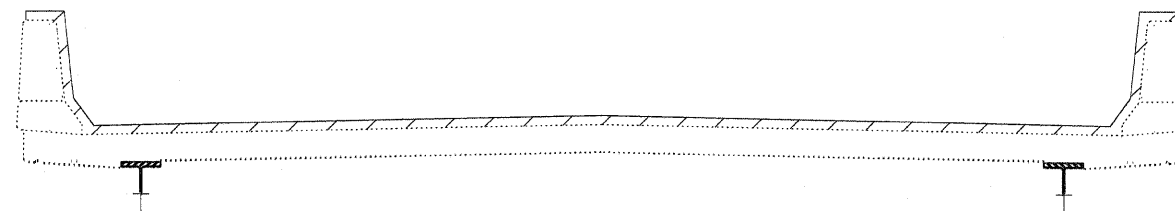

CROSS SECTION WITH PARAPET

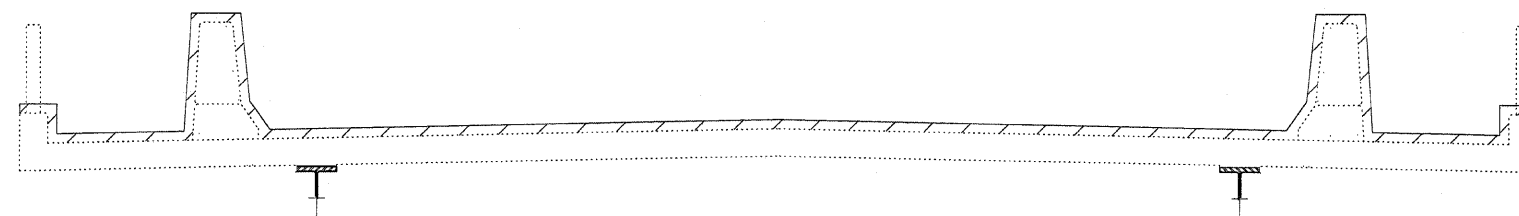

CROSS SECTION WITH SIDEWALK

Various Routes  
D2 Deck Sealing 2011-1  
Various Counties

FILE NAME =	USER NAME = linkdj	DESIGNED -	REVISD -	<b>STATE OF ILLINOIS DEPARTMENT OF TRANSPORTATION</b>	<b>SEALING DETAIL</b>		F.A.	SECTION	COUNTY	TOTAL	SHEET	
D:\BR\CADD plans\Various Counties\2011 deck sealing\Rook River\PLANeng.dgn	DRAWN -	REVISD -	RTE.						SHEETS	NO.		
PLOT SCALE = 50.0000' / IN.	CHECKED -	REVISD -				7	6					
PLOT DATE = Wed Oct 06 11:29:45 2010	DATE -	REVISD -				CONTRACT NO. 64G32						
					SCALE: _____	SHEET NO. ____ OF ____ SHEETS	STA. _____ TO STA. _____	ILLINOIS FED. AID PROJECT				

# TRAFFIC CONTROL AT TRANSITION

## WHEN 1 LANE INCREASES TO 2 LANES IN THE SAME DIRECTION

Various Routes  
 D2 Deck Sealing 2011-1  
 Various Counties  
 Sheet 7 of 7  
 Contract Number: 64G32

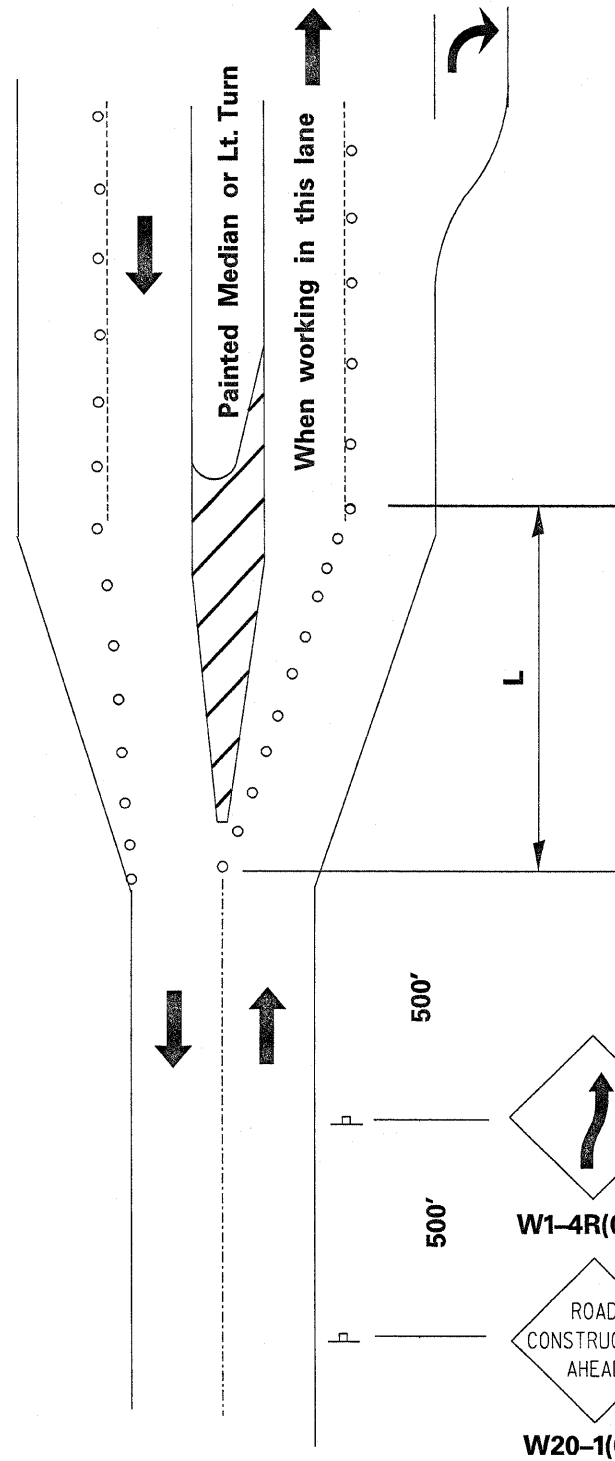

SPEED LIMIT	FORMULAS
40 MPH or Less	$L = \frac{WS^2}{60}$
45 MPH or Greater	$L = (W)(S)$

W = Width of Offset (Feet)

S = Normal Posted Speed (MPH)

○ Cone, Drum, or Barricade

**NOTE:**  
 All Costs To Comply with this Additional Traffic Control Shall be Considered Included in the Contract Unit Price Per L. SUM for TRAFFIC CONTROL AND PROTECTION STANDARD 701421. If the work area ends within 2500 feet of the transition, the lane closure must be extended as shown.

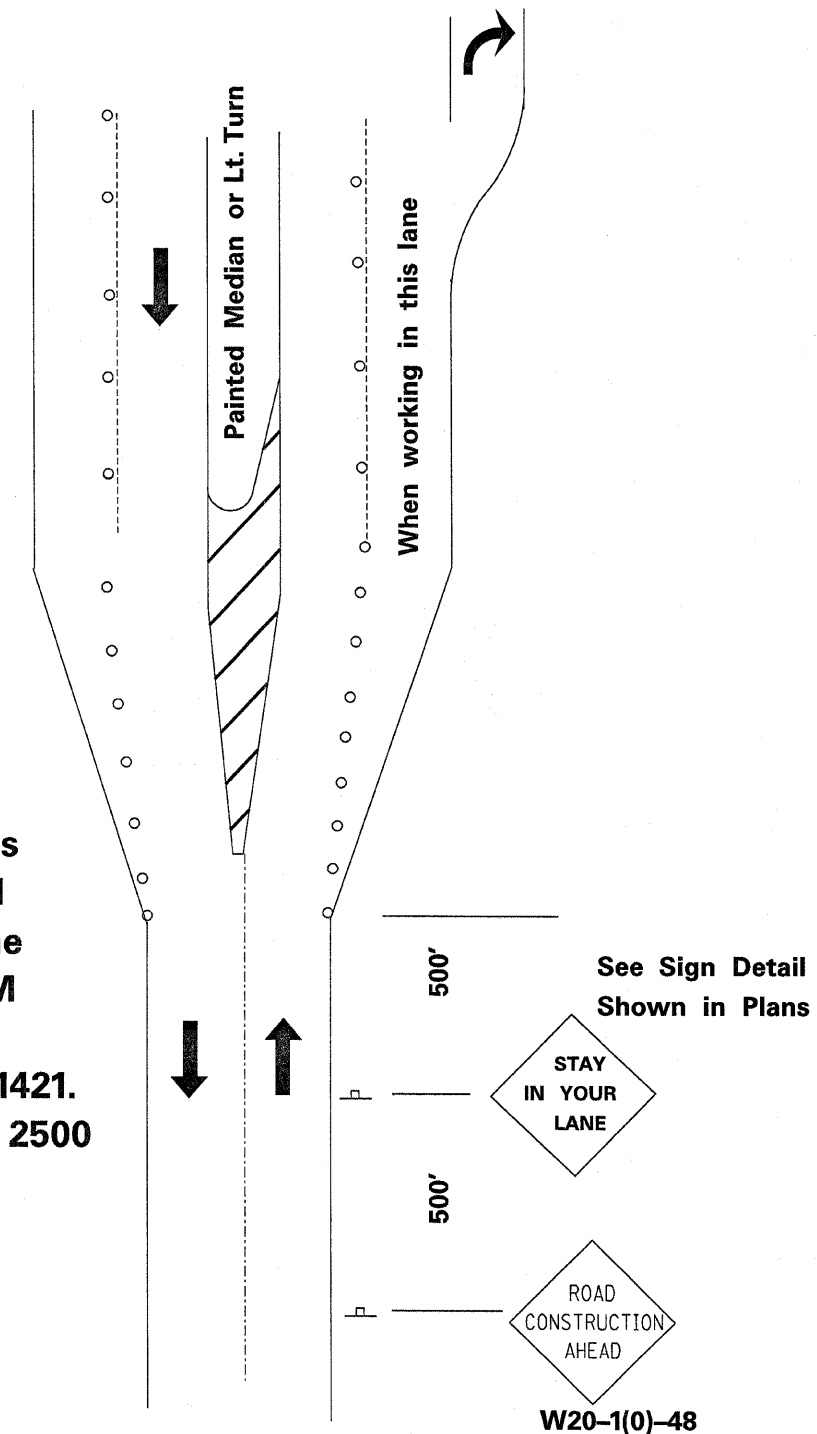



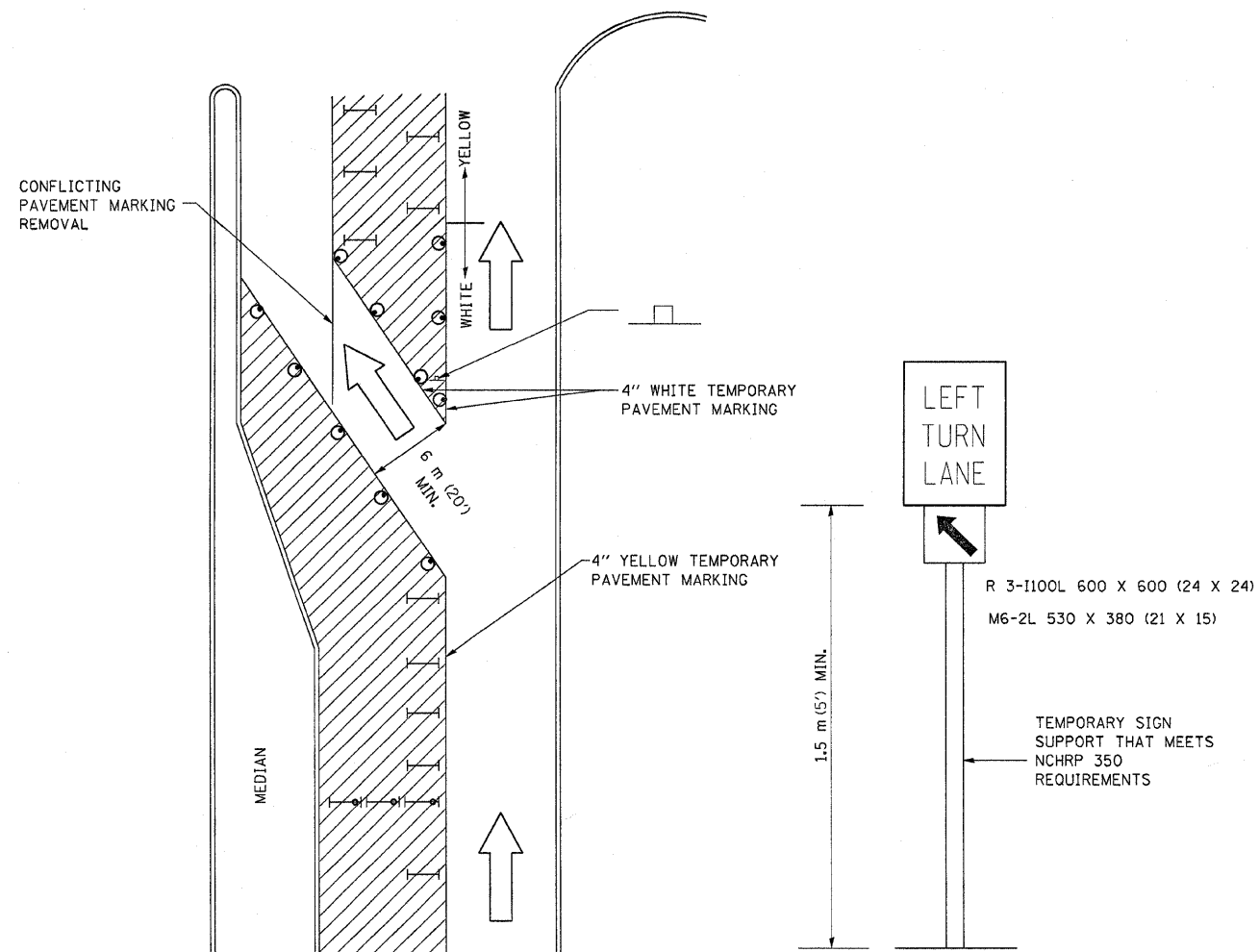

2Into4Intransitiontrafficcontrol.dgn

# TRAFFIC CONTROL AND PROTECTION AT TURN BAYS (TO REMAIN OPEN TO TRAFFIC)

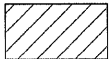
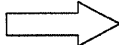
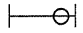

## LEGEND

-  WORK AREA
-  LANE OPEN TO TRAFFIC
-  TYPE I OR II BARRICADE OR DRUM WITH FLASHING BURNING LIGHT
-  DRUM OR BARRICADE WITH STEADY BURN LIGHT
-  SIGN (SEE DETAIL)
-  TYPE I OR II CHECK BARRICADE WITH STEADY LIGHT BURN

REVISED - 12-09-09

## GENERAL NOTES

- CONES MAY BE SUBSTITUTED FOR BARRICADES OR DRUMS AT HALF THE SPACING DURING DAY OPERATIONS. CONES SHALL BE A MINIMUM OF 710 (28) IN HEIGHT.
- STEADY BURNING LIGHTS WILL NOT BE REQUIRED ON BARRICADES OR DRUMS FOR DAY OPERATIONS. ALL LIGHTS WILL BE MONODIRECTIONAL.
- TEMPORARY PAVEMENT MARKING SHALL BE PLACED THROUGHOUT THE BARRICADED AREA OF EACH BAY WHERE THE CLOSURE TIME IS GREATER THAN FOURTEEN DAYS.
- THIS APPLICATION ALSO APPLIES WHEN WORK IS BEING PERFORMED IN THE RIGHT LANE(S) AND THE RIGHT TURN BAY IS TO REMAIN OPEN. UNDER THIS CONDITION, "RIGHT TURN LANE" R3-100 600 X 600 (24 X 24) AND M6-2R 530 X 380 (21 X 15) SHALL BE USED.
- THESE CONTROLS SHALL SUPPLEMENT MAINLINE TRAFFIC CONTROL FOR LANE CLOSURES. LONGITUDINAL DIMENSIONS MAY BE ADJUSTED TO FIT FIELD CONDITIONS.
- TRAFFIC CONTROL AND PROTECTION AT TURN BAYS (TO REMAIN OPEN TO TRAFFIC) SHALL BE INCLUDED IN THE COST SPECIFIED TRAFFIC CONTROL STANDARDS OR ITEMS.
- ALL DIMENSIONS ARE IN MILLIMETERS (INCHES) UNLESS OTHERWISE NOTED.

**Various Routes  
D2 Deck Sealing 2011-1  
Various Counties  
Contract Number: 64G32**

REVISED - ---	<b>REGION 2 / DISTRICT 2 STANDARD</b>	F.A. RTE.	SECTION	COUNTY	TOTAL SHEETS	SHEET NO.
REVISED - ---						1A
REVISED - ---		CONTRACT NO. 64G32				
REVISED - ---		SCALE: 50,000/1 IN	SHEET NO. ___ OF ___ SHEETS	STA. _____ TO STA. _____	FED. ROAD DIST. NO. _____	ILLINOIS FED. AID PROJECT

PLOT DATE = Wed Oct 06 11:29:19 2010