

SEC 25 T18N R10E 4th PM

JOE L. PETERSON et ux
05-25-201-005

10X2"

CURVE DATA
 PI STA. = 723+99.78
 $\Delta = 27^\circ 26' 30.75''$ (RT)
 $D = 5^\circ 39' 52''$
 $R = 1,011.51'$
 $T = 246.97'$
 $L = 484.46'$
 $E = 29.71'$
 e = MATCH EXISTING
 T.R. = MATCH EXISTING
 S.E. RUN = MATCH EXISTING
 P.C. STA = 721+52.81
 P.T. STA = 726+37.27

IMPROVEMENT BEGINS
STATION 724+50.00

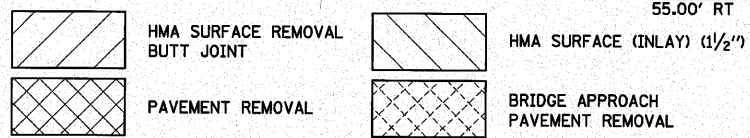
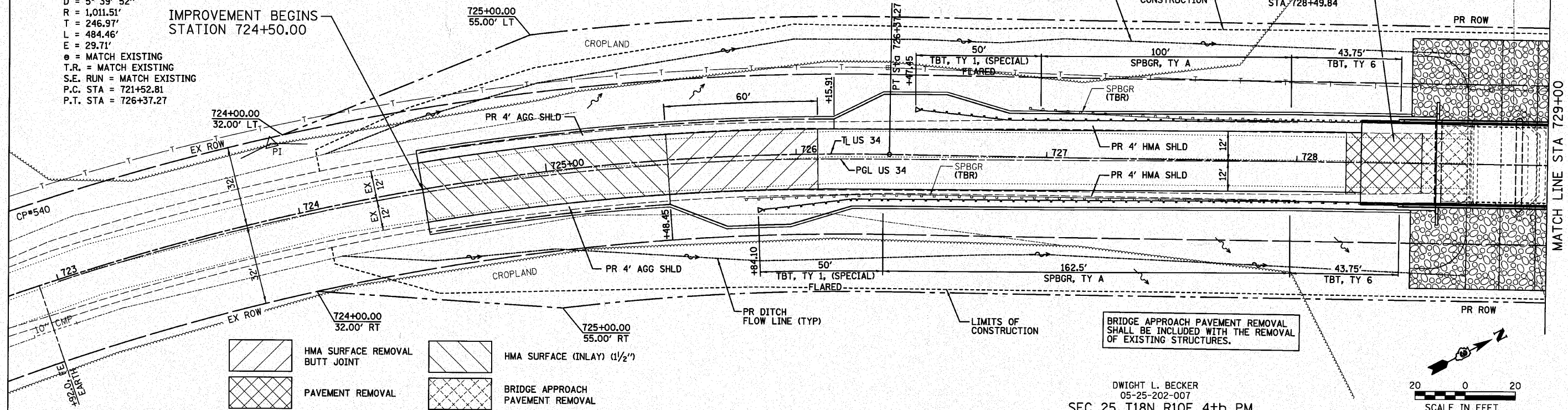

DWIGHT L. BECKER
05-25-202-007
SEC 25 T18N R10E 4th PM

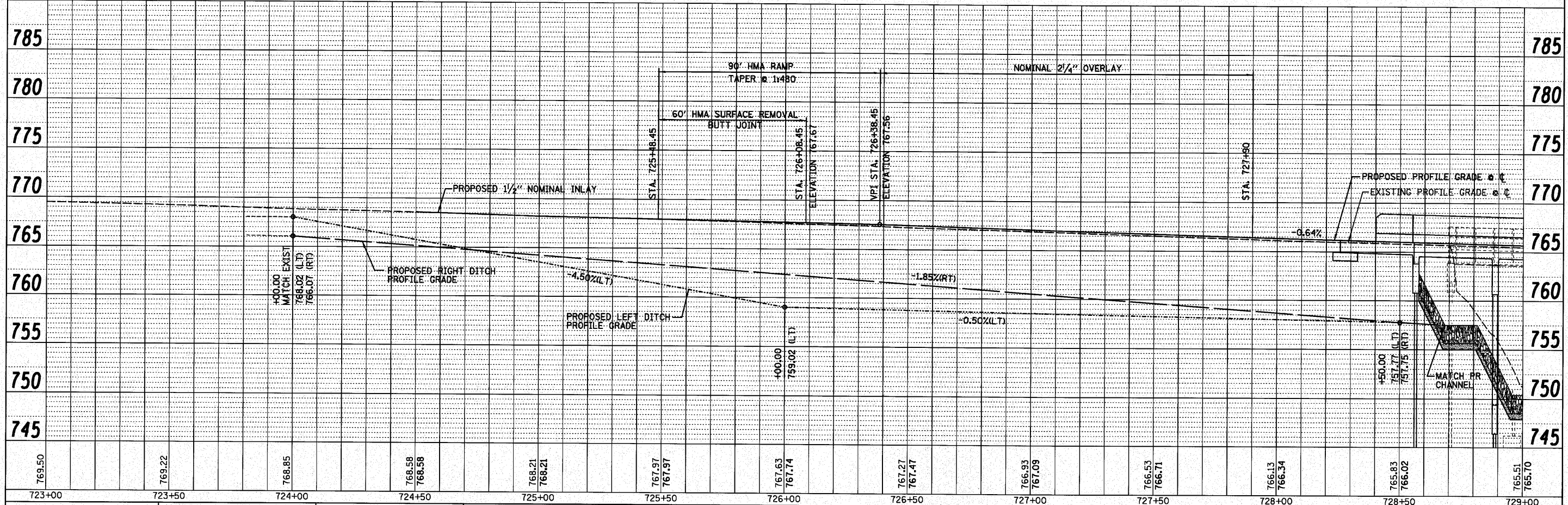
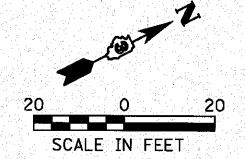

723+00	723+50	724+00	724+50	725+00	725+50	726+00	726+50	727+00	727+50	728+00	728+50	729+00
769.50	769.22	768.85	768.58 768.58	768.21 768.21	767.97 767.97	767.63 767.74	767.27 767.47	766.93 767.09	766.53 766.71	766.13 766.34	765.83 766.02	765.51 765.70

FILE NAME =
#FILE#

USER NAME = #USER#
DESIGNED - JML
DRAWN - JJO
CHECKED - MSW
DATE - 10/08/10

REVISED -
REVISED -
REVISED -
REVISED -

STATE OF ILLINOIS
DEPARTMENT OF TRANSPORTATION

PLAN & PROFILE

F.A.S. RTE.	SECTION	COUNTY	TOTAL SHEETS	SHEET NO.
1249	(23 BR)BR	BUREAU	39	10
CONTRACT NO. 66909				

FARNSWORTH GROUP, INC.

CONSULTING ENGINEERS - 2709 MCGRAW DRIVE BLOOMINGTON, ILLINOIS 61704 (309) 663-8435 / (309) 663-1571 FAX

24-8372