

STATE OF ILLINOIS
DEPARTMENT OF TRANSPORTATION

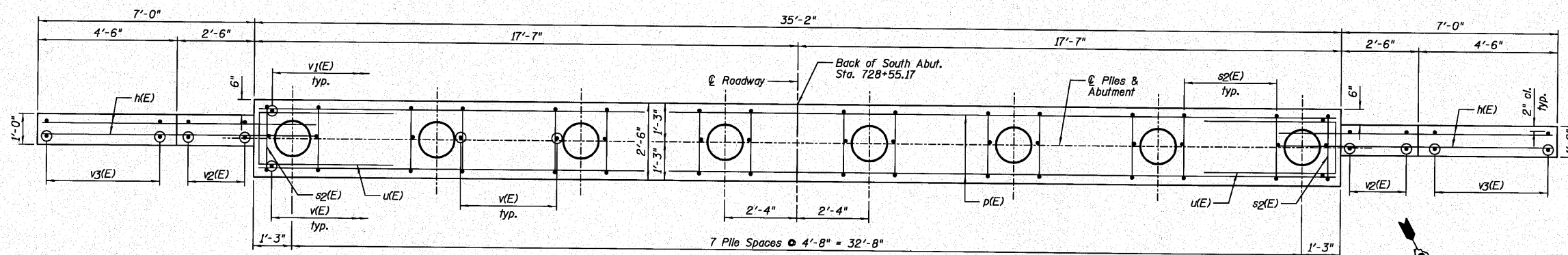

PLAN

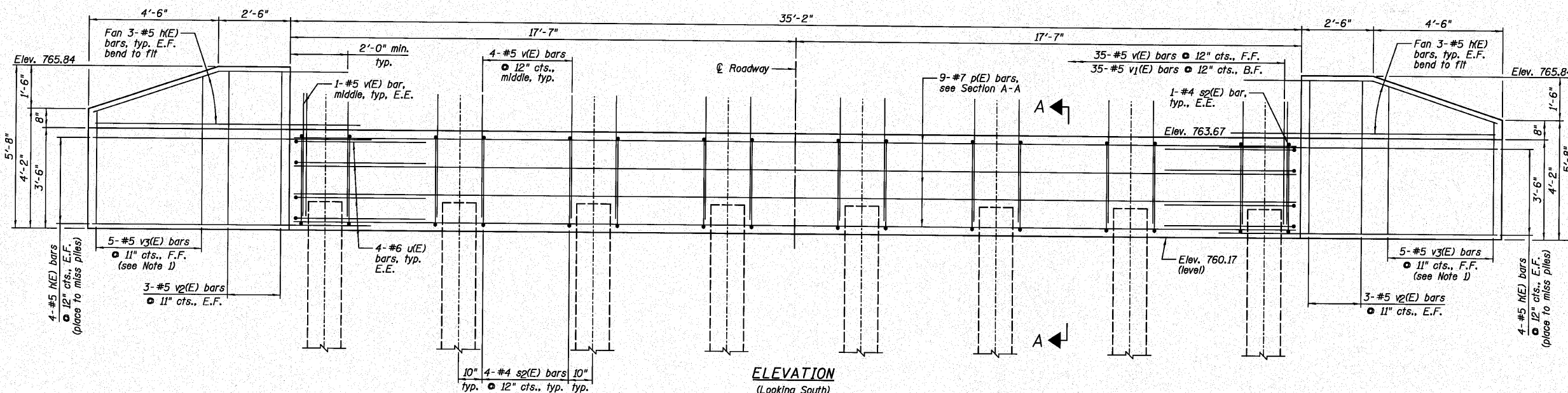

ELEVATION
(Looking South)

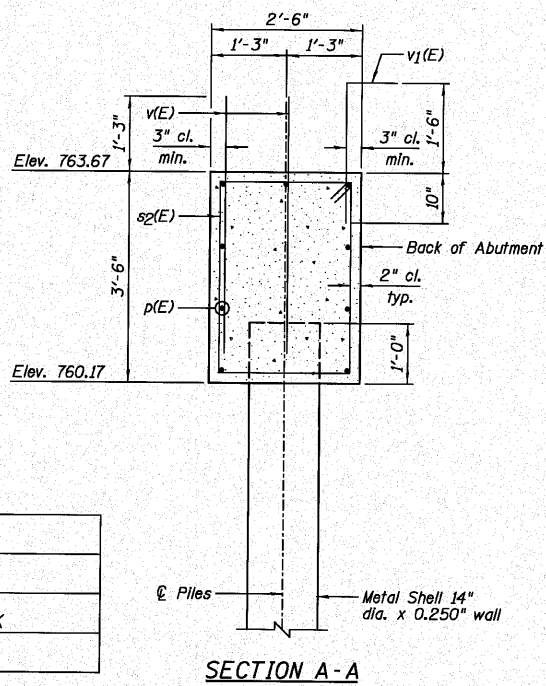

SECTION A-A

SOUTH ABUTMENT
BILL OF MATERIAL

Bar	No.	Size	Length	Shape
h(E)	28	#5	9'-2"	
p(E)	9	#7	34'-10"	
s2(E)	30	#4	11'-5"	□
u(E)	8	#6	10'-3"	□
v(E)	65	#5	4'-3"	
v1(E)	35	#5	3'-2"	
v2(E)	12	#5	5'-4"	
v3(E)	10	#5	8'-11"	

Item	Unit	Quantity
Porous Granular Embankment, Special	Cu. Yd.	36
Structure Excavation	Cu. Yd.	50
Concrete Structures	Cu. Yd.	14.1
Reinforcement Bars, Epoxy Coated	Pound	1,830
Furnishing Metal Shell Piles 14" x 0.250"	Foot	352
Driving Piles	Foot	352
Geocomposite Wall Drain	Sq. Yd.	20
Pipe Underdrains For Structures 4"	Foot	64

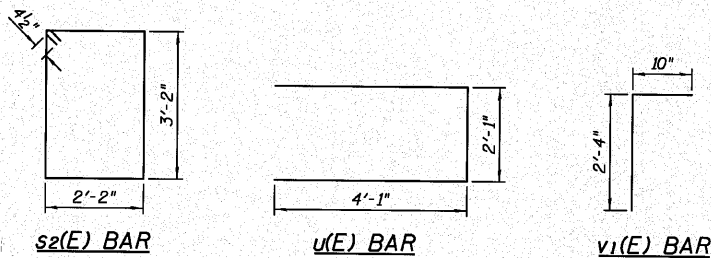

BAR CUTTING DIAGRAM

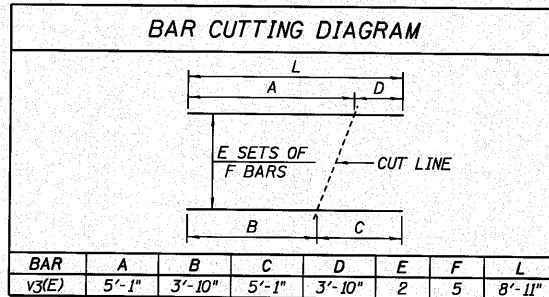

PILE DATA:

Pile Type and Size	Metal Shell - 14 In. dia. x 0.250 In. walls
Nominal Required Bearing	214 kips
Factored Resistance Available	118 kips
Estimated Pile Length	44 Feet
Number of Production Piles	8
Number of Test Piles	0

NOTES:

- Order v3(E) bars full length. Cut according to Bar Cutting Diagram. Use remainder of bars in Back Face.
- Bend or cut h(E) bars to miss piles.
- E.E. denotes Each End, F.F. denotes Front Face, B.F. denotes Back Face and E.F. denotes Each Face.

SOUTH ABUTMENT
STRUCTURE NO. 006-0182

DESIGNED SDH
CHECKED JML
DRAWN DJM/JWK
CHECKED MSW

DATE 10/08/10

Farnsworth
GROUP, INC.
2709 McGraw Drive
Bloomington, Illinois 61704
309/663-8435, 309/663-1571 fax

SHEET NO. B10
17 SHEETS

F.A.S. RTE.	SECTION	COUNTY	TOTAL SHEETS	SHEET NO.
1249	(23 BR)BR	BUREAU	39	23
CONTRACT NO. 66909				
FED. ROAD DIST. NO.		ILLINOIS FED. AID PROJECT		