

STATE OF ILLINOIS
DEPARTMENT OF TRANSPORTATION

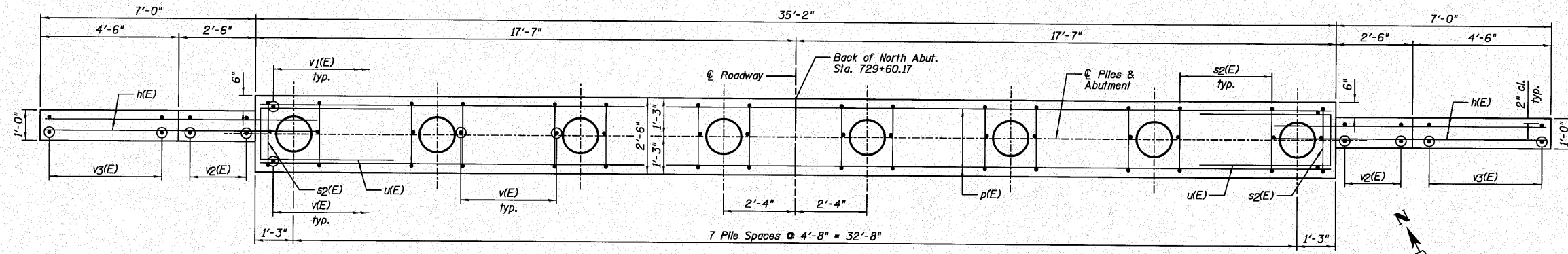

PLAN

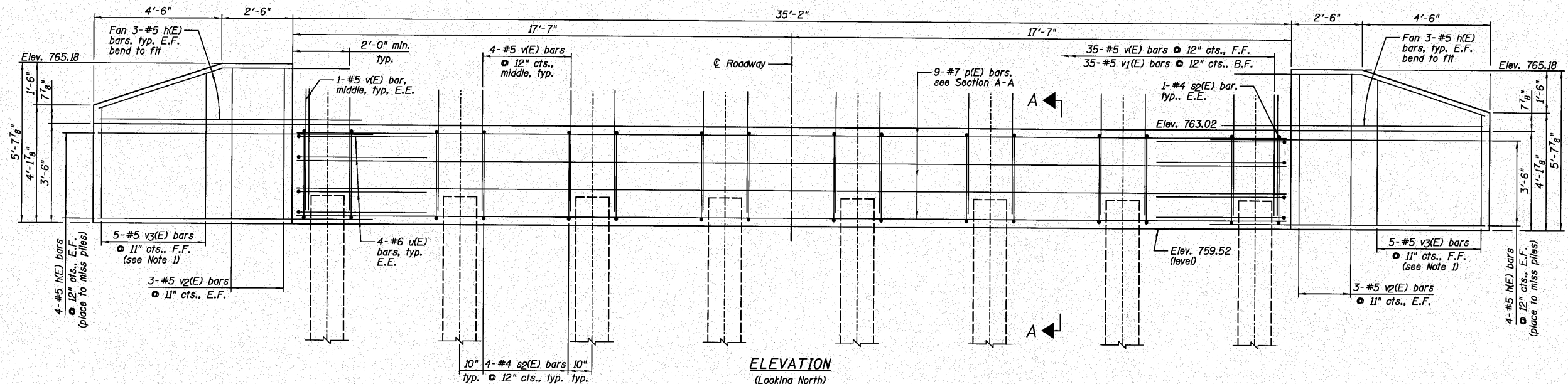

ELEVATION
(Looking North)

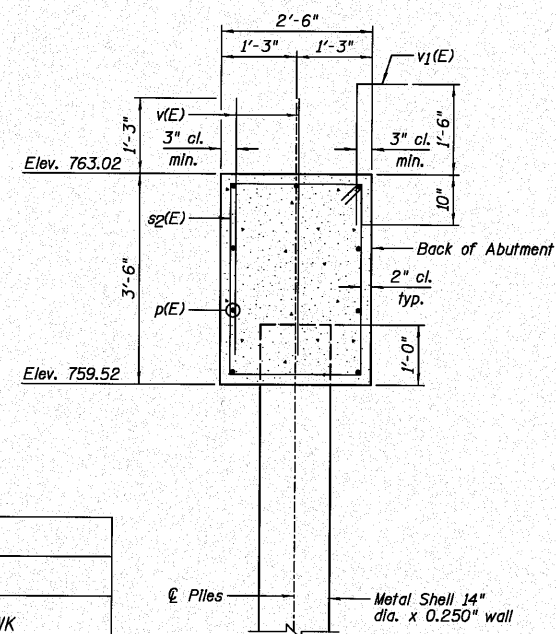

SECTION A-A

NORTH ABUTMENT
BILL OF MATERIAL

Bar	No.	Size	Length	Shape
v(E)	28	#5	9'-2"	—
p(E)	9	#7	34'-10"	—
sz(E)	30	#4	11'-5"	□
u(E)	8	#6	10'-3"	—
v(E)	65	#5	4'-3"	—
v1(E)	35	#5	3'-2"	—
v2(E)	12	#5	5'-4"	—
v3(E)	10	#5	8'-11"	—

Item	Unit	Quantity
Porous Granular Embankment, Special	Cu. Yd.	36
Structure Excavation	Cu. Yd.	50
Concrete Structures	Cu. Yd.	14.1
Reinforcement Bars, Epoxy Coated	Pound	1,830
Furnishing Metal Shell Piles 14" x 0.250"	Foot	133
Driving Piles	Foot	133
Test Pile Metal Shells	Each	1
Pile Shoes	Each	8
Geocomposite Wall Drain	Sq. Yd.	20
Pipe Underdrains For Structures 4"	Foot	64

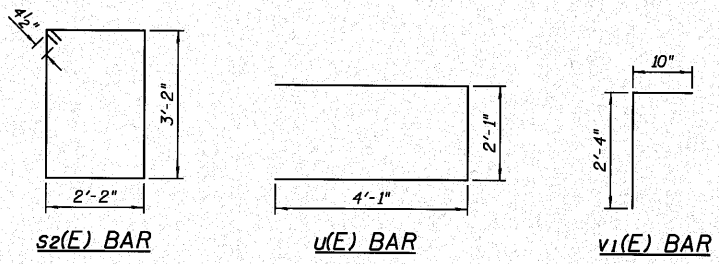

BAR CUTTING DIAGRAM

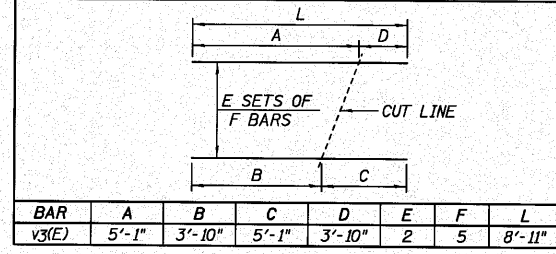

PILE DATA:

Pile Type and Size	Metal Shell - 14 in. dia. x 0.250 in. walls with pile shoes
Nominal Required Bearing	224 kips
Factored Resistance Available	123 kips
Estimated Pile Length	19 Feet
Number of Production Piles	7
Number of Test Piles	1

NOTES:

- Order v3(E) bars full length. Cut according to Bar Cutting Diagram. Use remainder of bars in Back Face.
- Bend or cut v(E) bars to miss piles.
- E.E. denotes Each End, F.F. denotes Front Face, B.F. denotes Back Face and E.F. denotes Each Face.

DESIGNED SDH
CHECKED JML
DRAWN DJM/JWK
CHECKED MSW
DATE 10/08/10

Farnsworth
GROUP, INC.
2709 McGraw Drive
Bloomington, Illinois 61704
309/663-8435, 309/663-1571 fax

SHEET NO. B11
17 SHEETS

F.A.S. RTE.	SECTION	COUNTY	TOTAL SHEETS	SHEET NO.
1249	(23 BR)BR	BUREAU	39	24

CONTRACT NO. 66909
FED. ROAD DIST. NO. ILLINOIS FED. AID PROJECT

NORTH ABUTMENT
STRUCTURE NO. 006-0182