

STATE OF ILLINOIS
DEPARTMENT OF TRANSPORTATION

Bench Mark: Brass Disk in Concrete Monument stamped "Peoria County G.I.S. Monument" on East Side of Cameron Lane next to a Red Witness Post at Station 335+82.62, 310.12' Right. Elevation 462.45

Existing Structure: S.N. 072-0010 was originally built in 1955 as S.B.I. Route 9, Section 45-R-B. The 1955 superstructure (current eastbound superstructure) consists of 3 span continuous variable depth reinforced concrete beams. In 1975 the bridge was rehabilitated and widened using 3 simple spans, PPC Deck Beams. In 2002 or 2003 a 5" concrete wearing surface was placed on the westbound lanes. In 2007 the bridge was rehabilitated and 9 PPC Deck Beams were replaced. The substructure consists of spill-thru pile supported abutments and solid piers (partly pile supported and partly spread footings). 203'-2" back to back abutments and 92'-10" out-to-out of deck. Structure will be removed and replaced using stage construction.

No salvage

DESIGN SPECIFICATIONS

2007 AASHTO LRFD Bridge Design Specifications
with 2008 & 2009 Interims

SEISMIC DATA

Seismic Performance Zone (SPZ) = 1
Design Spectral Acceleration at 1.0 sec. (S_{D1}) = 0.12g
Design Spectral Acceleration at 0.2 sec. (S_{D5}) = 0.18g
Soil Site Class = D

DESIGN STRESSES

FIELD UNITS
 f'_c = 3,500 psi
 f_y = 60,000 psi (Reinforcement)
 f_y = 50,000 psi (M270 Grade 50W)

LOADING HL-93

Allow 50#/sq. ft. for future wearing surface

Traffic Barrier Terminal
Type 6 typ 4 corners
Std 631031

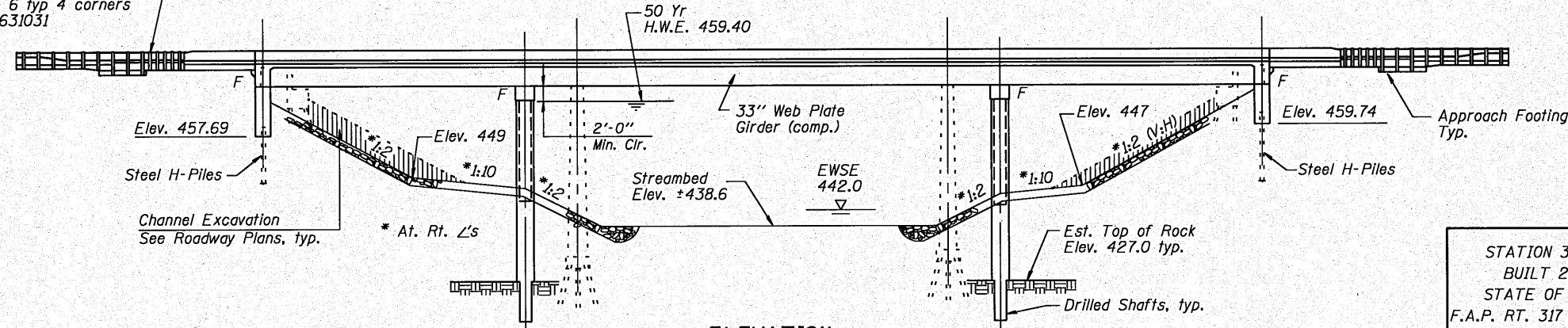

STATION 337+89.89
BUILT 201 BY
STATE OF ILLINOIS
F.A.P. RT. 317 SEC. 45BR-2
LOADING HL-93
STRUCTURE NO. 072-0228

NAME PLATE
See Std. 515001

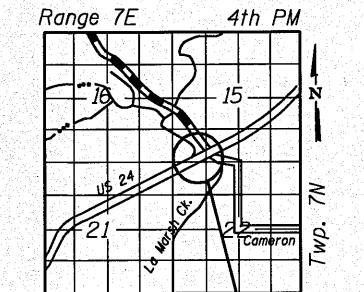

LOCATION SKETCH

APPROVED
For Structural Adequacy Only

Ralph E. Anderson
Engineer of Bridges & Structures (730)

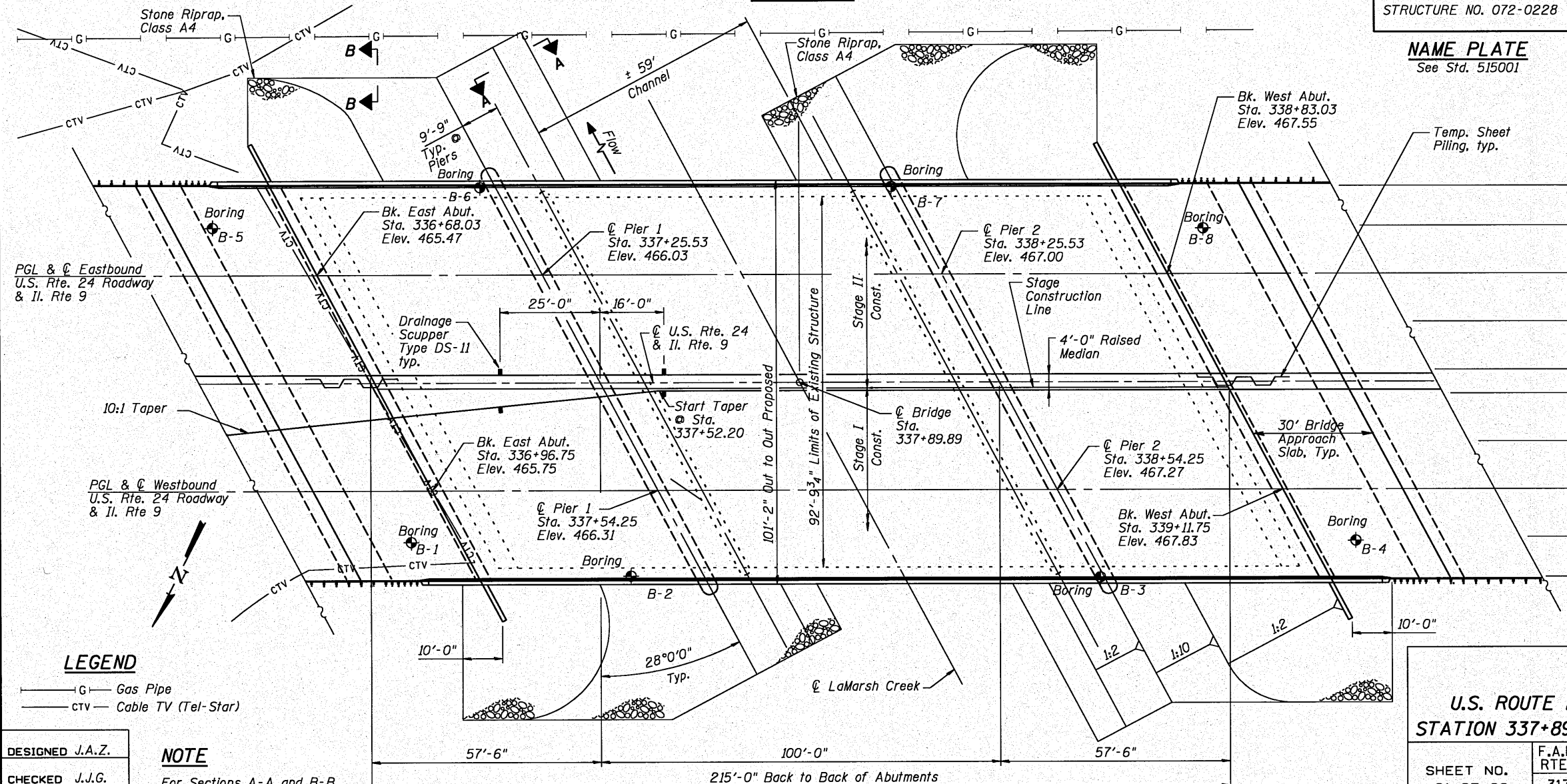
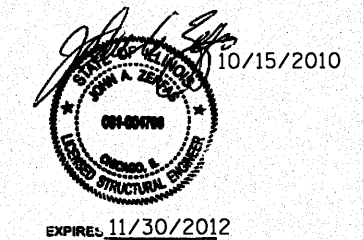

LEGEND

G — Gas Pipe
ctv — Cable TV (Tel-Star)

DESIGNED J.A.Z.
CHECKED J.J.G.
DRAWN E.E.J.
CHECKED J.A.Z.

NOTE
For Sections A-A and B-B
See Sheet S2.

GENERAL PLAN & ELEVATION
U.S. ROUTE 24 & IL ROUTE 9 OVER LA MARSH CREEK
STATION 337+89.89
STRUCTURE NO. 072-0228

SHEET NO. S1 OF 39 SHEETS	F.A.P. RTE. 317	SECTION 45BR-2	COUNTY PEORIA	TOTAL SHEETS 122	SHEET NO. 49
	CONTRACT NO. 68719			ILLINOIS FED. AID PROJECT	



h:\jobs\2010\201003014\ced\vide...s\structural\vdgn\020\501_GP&E.dgn
 12/18/2010