

BY: \_\_\_\_\_  
 SURVEYED \_\_\_\_\_  
 PLOTTED \_\_\_\_\_  
 NOTE BOOK \_\_\_\_\_  
 DATE \_\_\_\_\_  
 AREAS CHECKED \_\_\_\_\_

BY: \_\_\_\_\_  
 SURVEYED \_\_\_\_\_  
 PLOTTED \_\_\_\_\_  
 NOTE BOOK \_\_\_\_\_  
 DATE \_\_\_\_\_  
 AREAS CHECKED \_\_\_\_\_

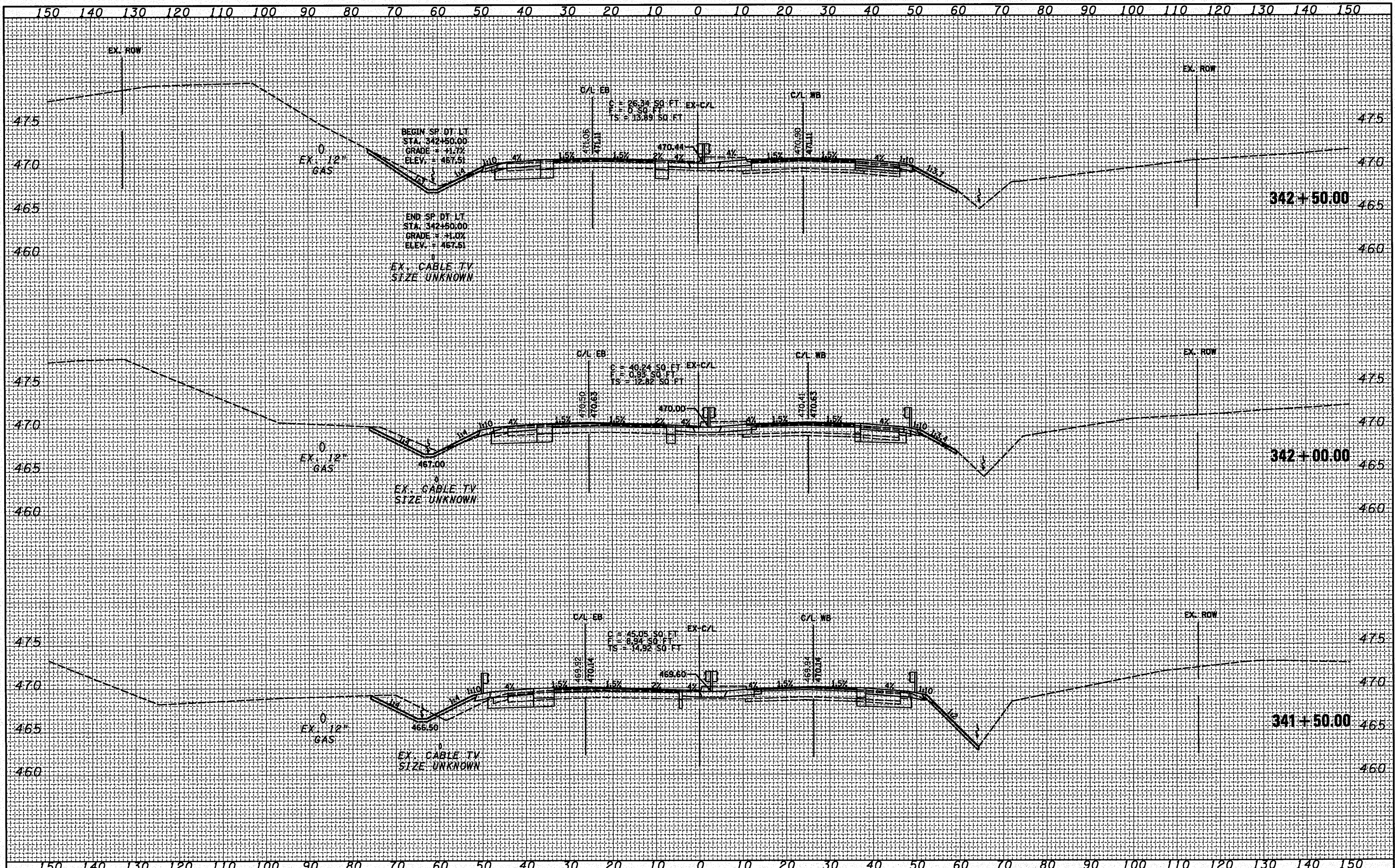

FILE NAME =	USER NAME = #USER*	DESIGNED - ST	REVISED -	STATE OF ILLINOIS DEPARTMENT OF TRANSPORTATION	CROSS SECTIONS US ROUTE 24 OVER LAMARSH CREEK		F.A.P. RTE. 317	SECTION 45BR-2	COUNTY PEORIA	TOTAL SHEETS 122	SHEET NO. 116
#FILE#		DRAWN - ST	REVISED -		SCALE: 1"=10'H, 5'V	SHEET NO. 10 OF 11 SHEETS	STA. 341+50.00 TO STA. 342+50.00	CONTRACT NO. 68719		(ILLINOIS) FED. AID PROJECT	
		CHECKED - FML	REVISED -								
		DATE - 10-15-2010	REVISED -								