

BY	
DATE	
NO.	
FINAL SURVEY	
PLOTTED	
NOTE BOOK	
AREAS CHECKED	

BY	
DATE	
NO.	
ORIGINAL SURVEY	
PLOTTED	
NOTE BOOK	
AREAS CHECKED	

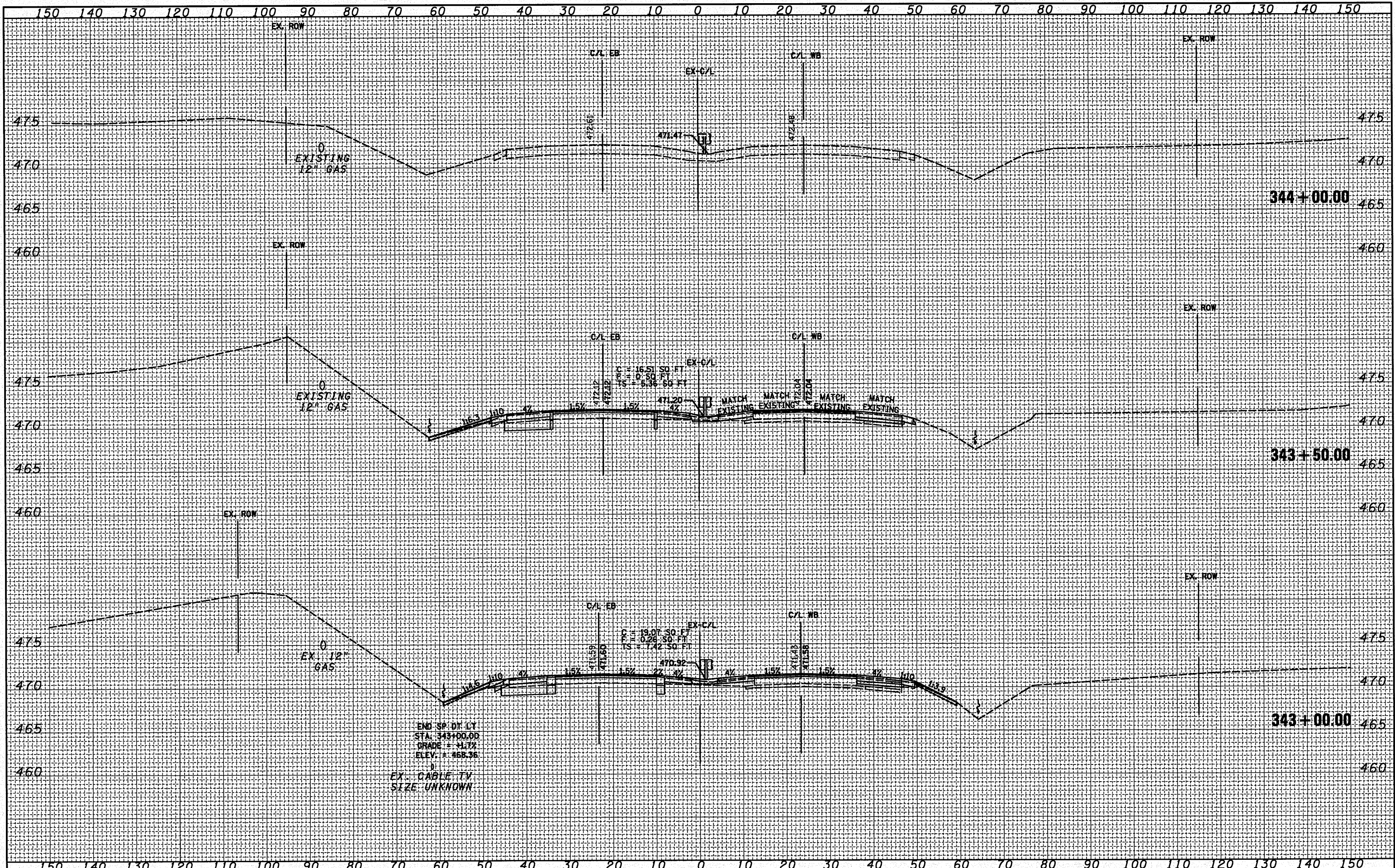

FILE NAME =	USER NAME = #USER#	DESIGNED - ST	REVISED -	STATE OF ILLINOIS DEPARTMENT OF TRANSPORTATION	CROSS SECTIONS US ROUTE 24 OVER LAMARSH CREEK				F.A.P. RTE. 317	SECTION 45BR-2	COUNTY PEORIA	TOTAL SHEETS 122	SHEET NO. 117
#FILE#		DRAWN - ST	REVISED -		SCALE: 1"=10'H, 5"V	SHEET NO. 11 OF 11 SHEETS	STA. 343+00.00 TO STA. 344+00.00	ILLINOIS FED. AID PROJECT					
		CHECKED - FML	REVISED -										
		DATE - 10-15-2010	REVISED -										