

STAGING LEGEND

	TYPE III BARRICADE WITH FLASHING LIGHTS		TRAFFIC SIGNAL
	TEMPORARY CONCRETE BARRIER		DOUBLE VERTICAL PANEL
	DRUM WITH STEADY BURNING LIGHTS		SIGN
	DETECTOR LOOPS		GUARDRAIL MARKERS
	TEMPORARY RUMBLE STRIPS		

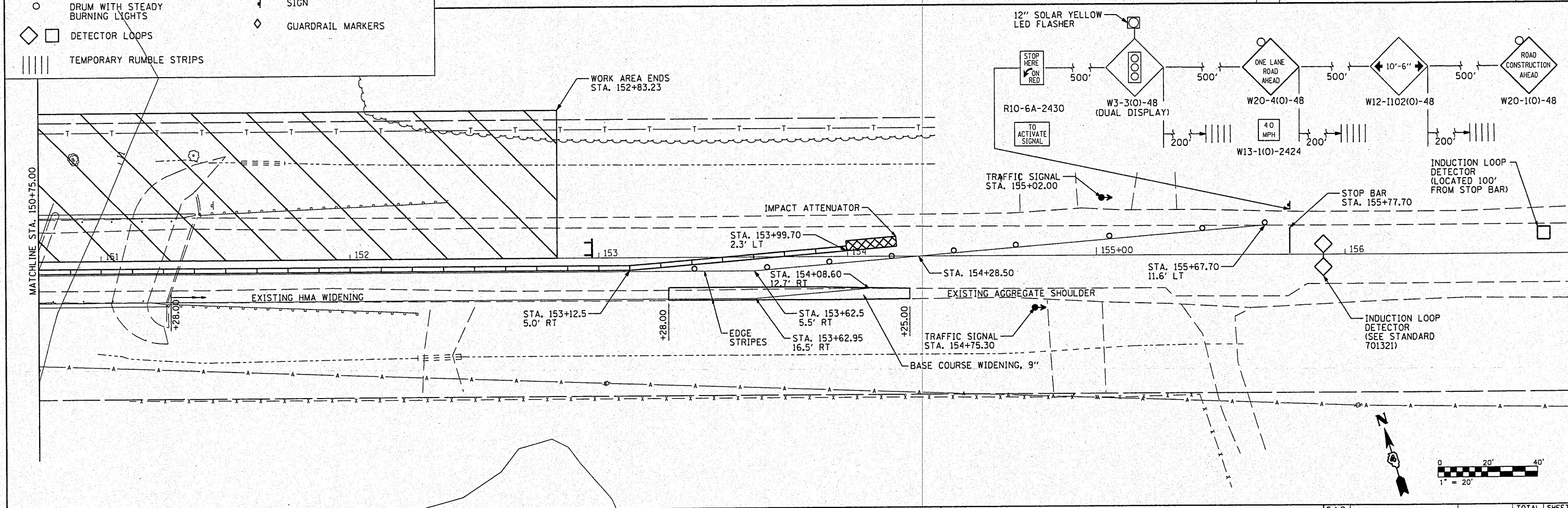

FILE NAME = S:\237\2009\23708001\IL164SmithCreek\CAD\04CADD Sheets\0468761-sht-staging.dgn	USER NAME = rbradley	DESIGNED - RMB	REVISED -	STATE OF ILLINOIS DEPARTMENT OF TRANSPORTATION	IL 164 OVER SMITH CREEK STAGING PLAN-STAGE 1 CONSTRUCTION	F.A.P. RTE. = 657	SECTION = 116-CBR-1	COUNTY = HENDERSON	TOTAL SHEETS = 56	SHEET NO. = 14
PLOT SCALE = 40.0000' / IN.	CHECKED - RJA	REVISIONS	SCALE: SHEET NO. OF SHEETS STA. 147+25.00 TO STA. 154+25.00			CONTRACT NO. 68761				
PLOT DATE = 10/23/2010	DATE -	REVISIONS	ILLINOIS FED. AID PROJECT							