

SEC 7 - T 17 N - R 6 E - 3RD PM

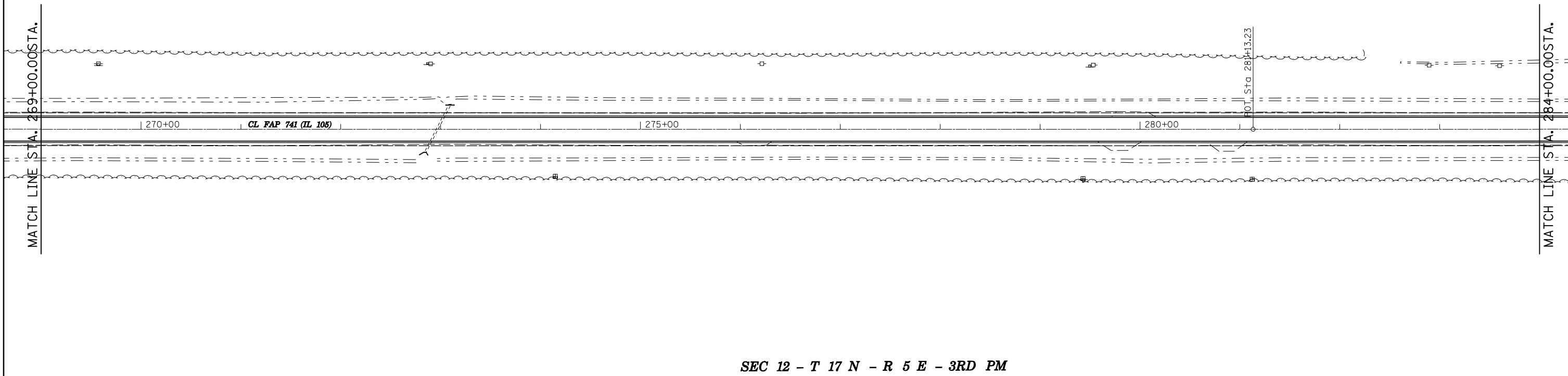

SEC 12 - T 17 N - R 5 E - 3RD PM

SEC 7 - T 17 N - R 6 E - 3RD PM

SEC 18 - T 17 N - R 6 E - 3RD PM

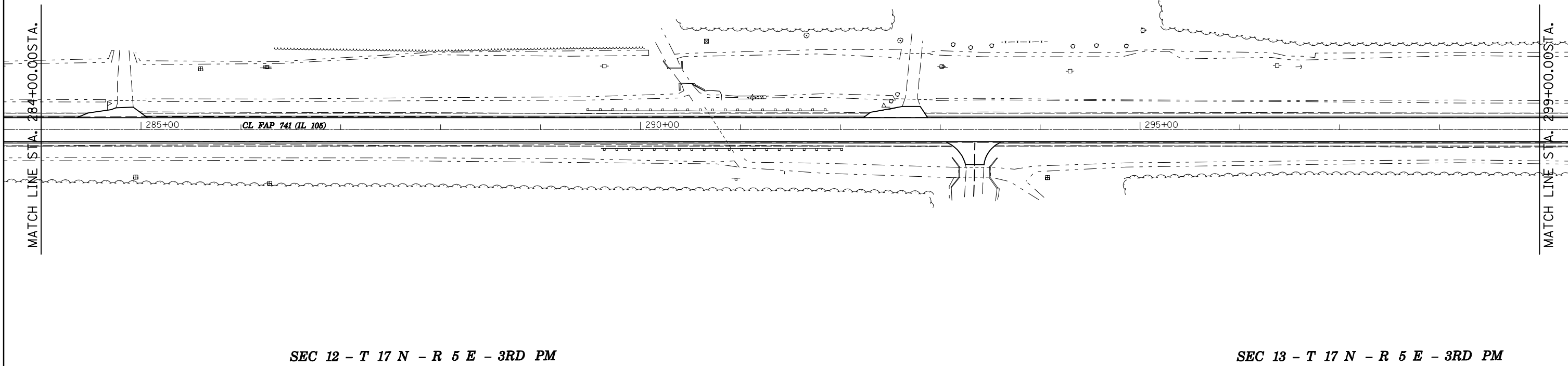

SEC 12 - T 17 N - R 5 E - 3RD PM

SEC 13 - T 17 N - R 5 E - 3RD PM

| | | | |
|--|-----------------------|------------|-----------|
| FILE NAME = | USER NAME = bucklesjj | DESIGNED - | REVISED - |
| ct:\pw\work\p\dot\bucklesjj\d0155680\0570273-shr-Plan_50.dgn | | DRAWN - | REVISED - |
| PLOT SCALE = 100.0000' / IN. | | CHECKED - | REVISED - |
| PLOT DATE = 10/14/2010 | | DATE - | REVISED - |

STATE OF ILLINOIS
DEPARTMENT OF TRANSPORTATION

PLAN SHEETS

SCALE: SHEET NO. OF SHEETS STA. 269+00 TO STA. 299+00

| F.A.P. RTE. | SECTION | COUNTY | TOTAL SHEETS | SHEET NO. |
|---------------------------|---------------|--------|--------------------|-----------|
| 741 | (75,8,28)RS-3 | Platt | 202 | 24 |
| ILLINOIS FED. AID PROJECT | | | CONTRACT NO. 70273 | |

Sheet: 24
Date: 10/14/2010