

SEC. 19 - T 17 N - R 6 E - 3RD PM

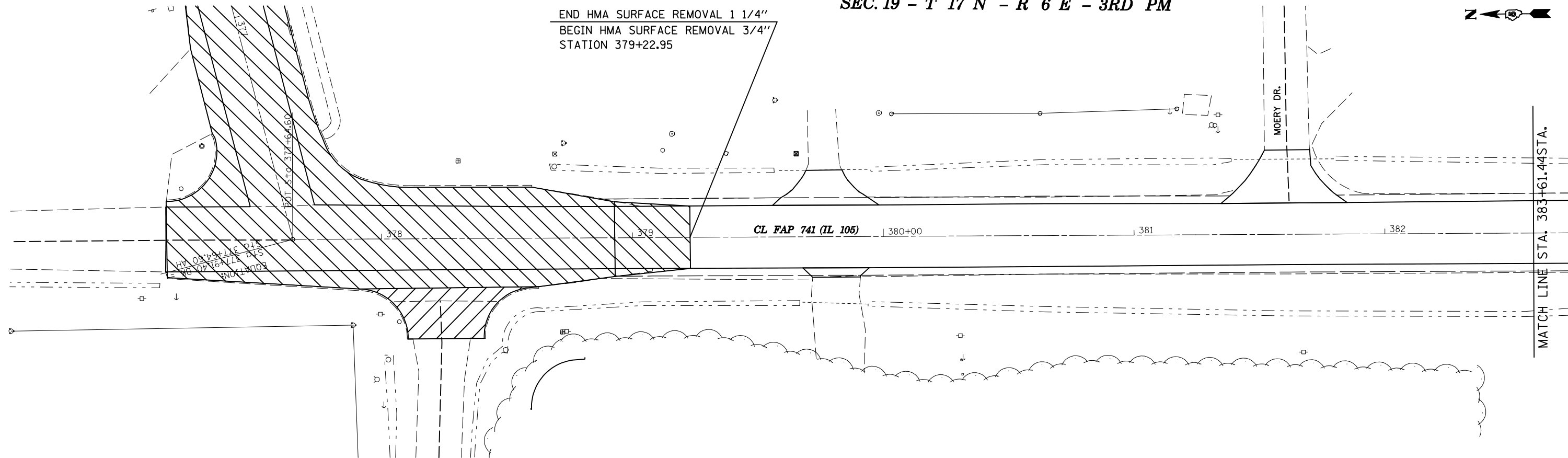

END HMA SURFACE REMOVAL 1 1/4"  
 BEGIN HMA SURFACE REMOVAL 3/4"  
 STATION 379+22.95



SEC. 24 - T 17 N - R 5 E - 3RD PM

SEC. 19 - T 17 N - R 6 E - 3RD PM

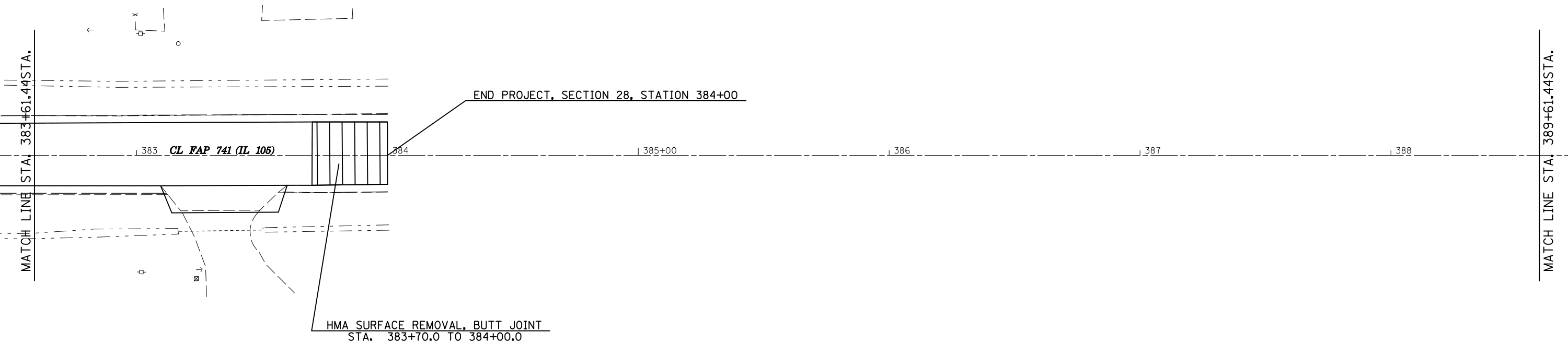

SEC. 24 - T 17 N - R 5 E - 3RD PM

FILE NAME = c:\pwwork\pwwork\dot\bucklesj\0155680\0570273-sht-Plan_20.dgn	USER NAME = bucklesj	DESIGNED -	REVISED -	<b>STATE OF ILLINOIS DEPARTMENT OF TRANSPORTATION</b>	<b>PLAN SHEETS</b>			F.A.P. RTE.	SECTION	COUNTY	TOTAL SHEETS	SHEET NO.
	PLOT SCALE = 40.0000' / IN.	CHECKED -	REVISED -					741	(75,8,28)RS-3	Platt	202	32
PLOT DATE = 10/14/2010	DATE -	REVISED -	REVISED -		SCALE:	SHEET NO.	OF SHEETS	STA. 377+88.24 TO STA. 384+00	CONTRACT NO. 70273			
								ILLINOIS FED. AID PROJECT				