

BENCHMARK: 4732-1
 CHISELED SQUARE ON THE TOP OF THE
 NORTHWEST CORNER OF STRUCTURE 074-0017
 STATION 164+18.72, 21.95' LT., ELEVATION 678.043

SEC. 13, T. 18 N., R. 4 E., 3rd P.M.

PLAN	SURVEYED	DATE
	PLOTTED	BY
	GRADES CHECKED	
	STRUCTURE NOTATIONS CHECKED	
	NOTE BOOK NO.	
	CHECKED BY	
	DATE	

PROFILE	SURVEYED	DATE
	PLOTTED	BY
	GRADES CHECKED	
	STRUCTURE NOTATIONS CHECKED	
	NOTE BOOK NO.	
	CHECKED BY	
	DATE	

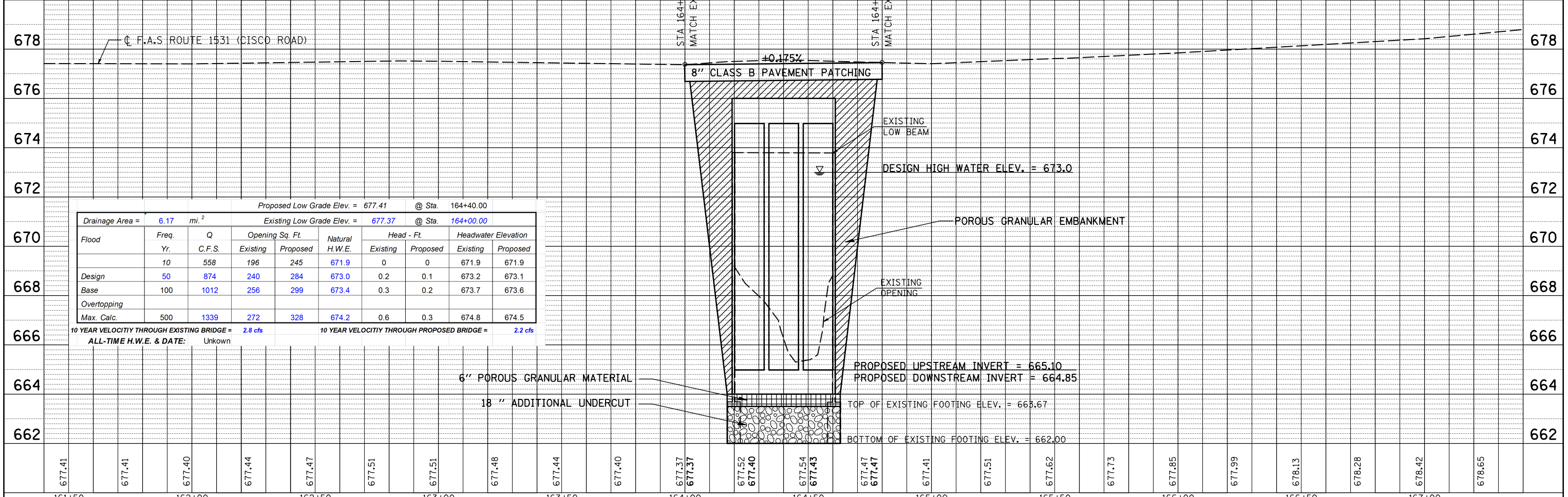
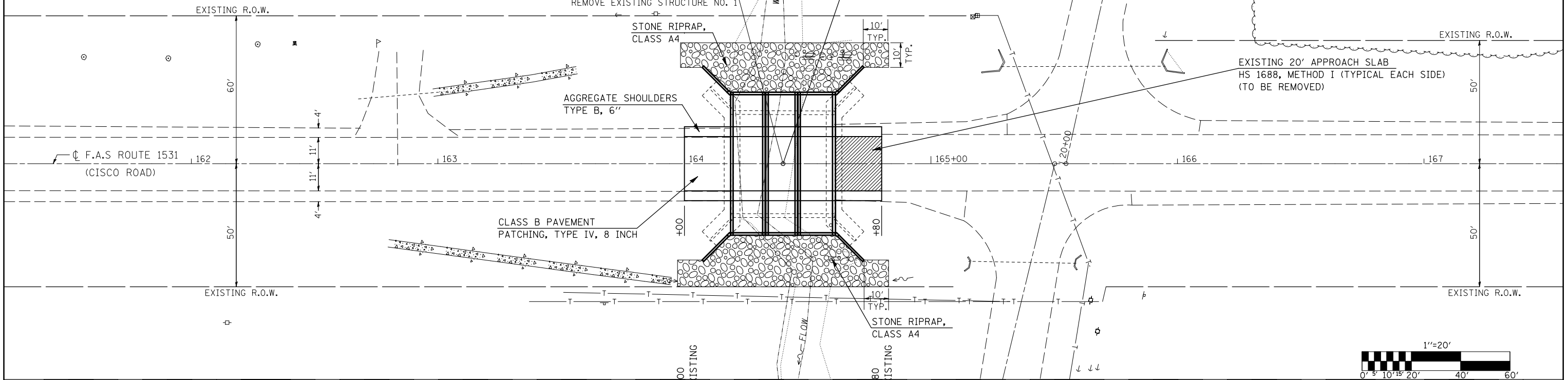

Drainage Area = 6.17 mi. ²		Existing Low Grade Elev. = 677.37 @ Sta. 164+00.00					
Flood	Yr.	Q	C.F.S.	Opening Sq. Ft.	Natural H.W.E.	Head - Ft.	Headwater Elevation
		Existing	Proposed	Existing	Proposed	Existing	Proposed
Design	10	558	196	245	671.9	0	671.9
Base	50	874	240	284	673.0	0.2	673.1
Overtopping	100	1012	256	299	673.4	0.3	673.6
Max. Calc.	500	1339	272	328	674.2	0.6	674.5

10 YEAR VELOCITY THROUGH EXISTING BRIDGE = 2.8 cfs
 ALL-TIME H.W.E. & DATE: Unknown
 10 YEAR VELOCITY THROUGH PROPOSED BRIDGE = 2.2 cfs