

SEC. 10, T. 18 N., R. 5 E., 3rd P.M.

10B-1 & 11B-1

*(COMPLETE REMOVAL OF SUPERSTRUCTURE & PARTIAL REMOVAL OF SUBSTRUCTURE, SEE SPECIAL PROVISIONS)

EXISTING S.N. 074-0018
REINFORCED CONCRETE GIRDER
SINGLE SPAN
CL STATION 352+50
SKEW = 0°
REMOVE EXISTING STRUCTURE NO. 3*

PROPOSED S.N. 074-2006
PRECAST BOX CULVERT WITH
CAST-IN-PLACE END SECTIONS &
SHEET PILE WINGWALLS
DOUBLE 12' x 10' x 67'
CL STATION 352+50

DATE	
BY	
PLAN	
NO. BOOK	
NO.	
DATE	
BY	
PROFILE	
NO. BOOK	
NO.	
DATE	
BY	

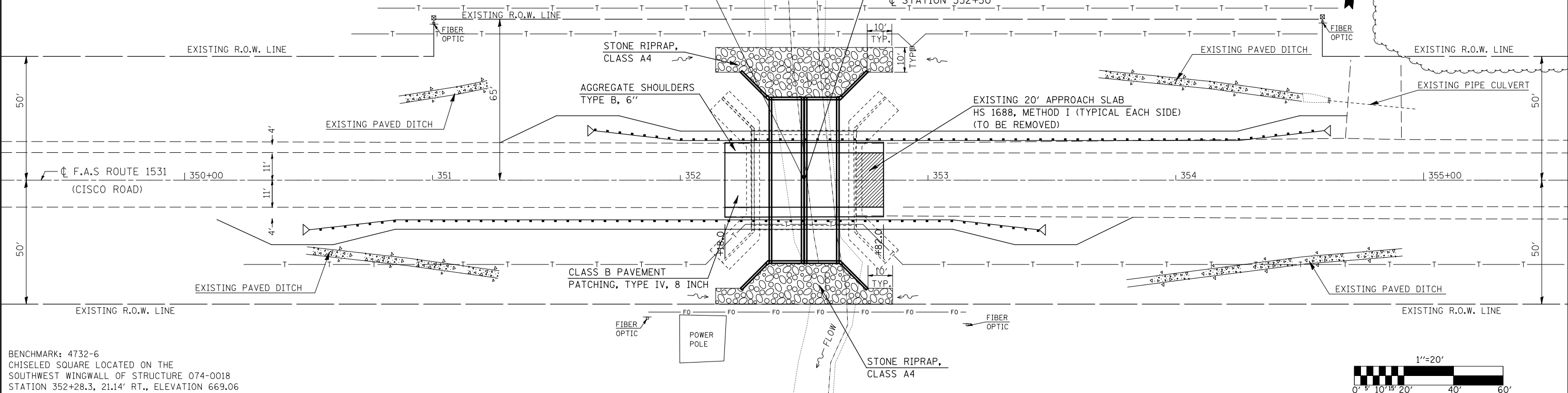

BENCHMARK: 4732-6
CHISELED SQUARE LOCATED ON THE
SOUTHWEST WINGWALL OF STRUCTURE 074-0018
STATION 352+28.3, 21.14' RT., ELEVATION 669.06

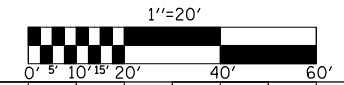

DATE	
BY	
PROFILE	
NO. BOOK	
NO.	
DATE	
BY	

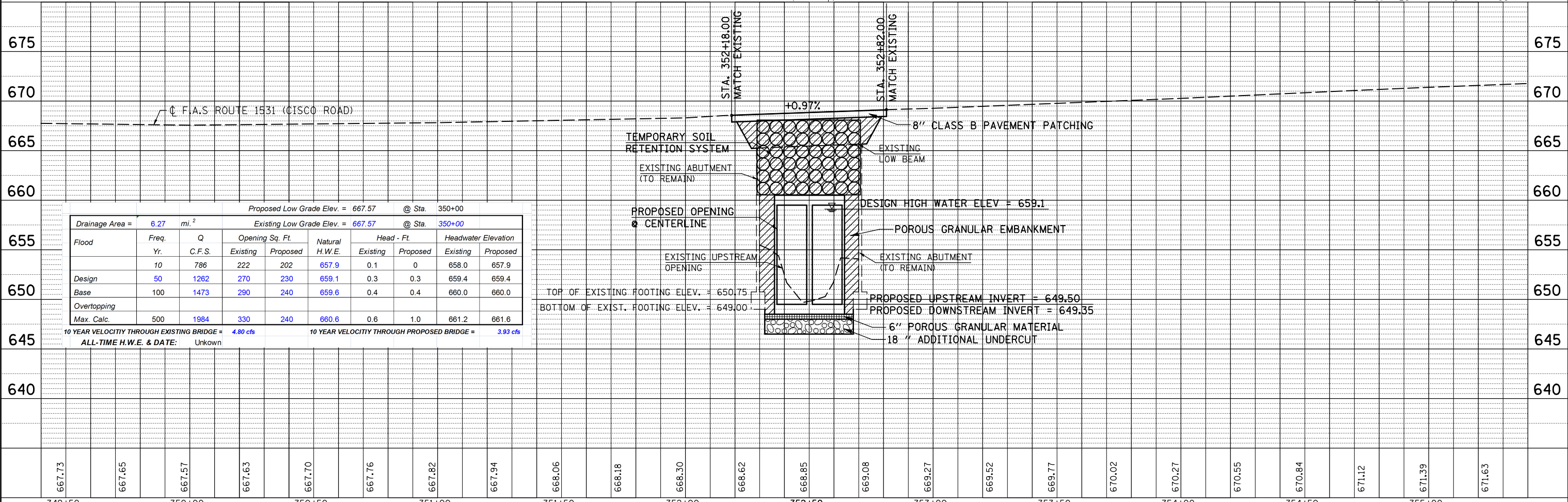

FILE NAME =	USER NAME = coombessf	DESIGNED -	REVISED -
ct:\pwork\pwork\coombessf\d0135397\7045	design.dgn	DRAWN -	REVISED -
	PLOT SCALE = 40.0000' / IN.	CHECKED -	REVISED -
	PLOT DATE = 10/20/2010	DATE -	REVISED -

**STATE OF ILLINOIS
DEPARTMENT OF TRANSPORTATION**

S.N. 074-2006 PLAN & PROFILE

SCALE: SHEET NO. OF SHEETS STA. TO STA.

F.A.S. RTE.	SECTION	COUNTY	TOTAL SHEETS	SHEET NO.
1531	10B-1 & 11B-1	PIATT	88	17
CONTRACT NO. 70458				

ILLINOIS FED. AID PROJECT