

F.A.P. RTE.	SECTION	COUNTY	TOTAL SHEETS	SHEET NO.
704	(LN & TS-1)	McLEAN	497	70
STA. 2+300.000		TO STA. 2+450.000		
FED. ROAD DIST. NO.		ILLINOIS FED. AID PROJECT		
CONTRACT NO. 70514				

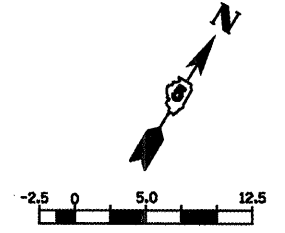

CVSB - 2  
 PI STA = 2+431.834  
 $\Delta = 8^\circ 20' 26''$  (RT)  
 R = 1,000.670 m  
 T = 72.964 m  
 L = 145.670 m  
 E = 2.657 m  
 e = EXISTING  
 T.R. = EXISTING  
 S.E. RUN. = EXISTING  
 P.C. STA = 2+358.871  
 P.T. STA = 2+504.540

- NOTES:
1. ALL STATIONING SHOWN IS BASED UPON  $\phi$  VETERANS PARKWAY (SOUTHBOUND).
  2. ALL PROPOSED COMBINATION CONCRETE CURB & GUTTER SHOWN IS TYPE B-15.45 UNLESS OTHERWISE NOTED.
  3. SEE INTERSECTION DETAILS FOR STATIONS, OFFSET, & RADII AT INTERSECTION.
  4. SAWCUT ALL EXISTING PAVEMENT AS NECESSARY TO OBTAIN CLEAN EDGE.

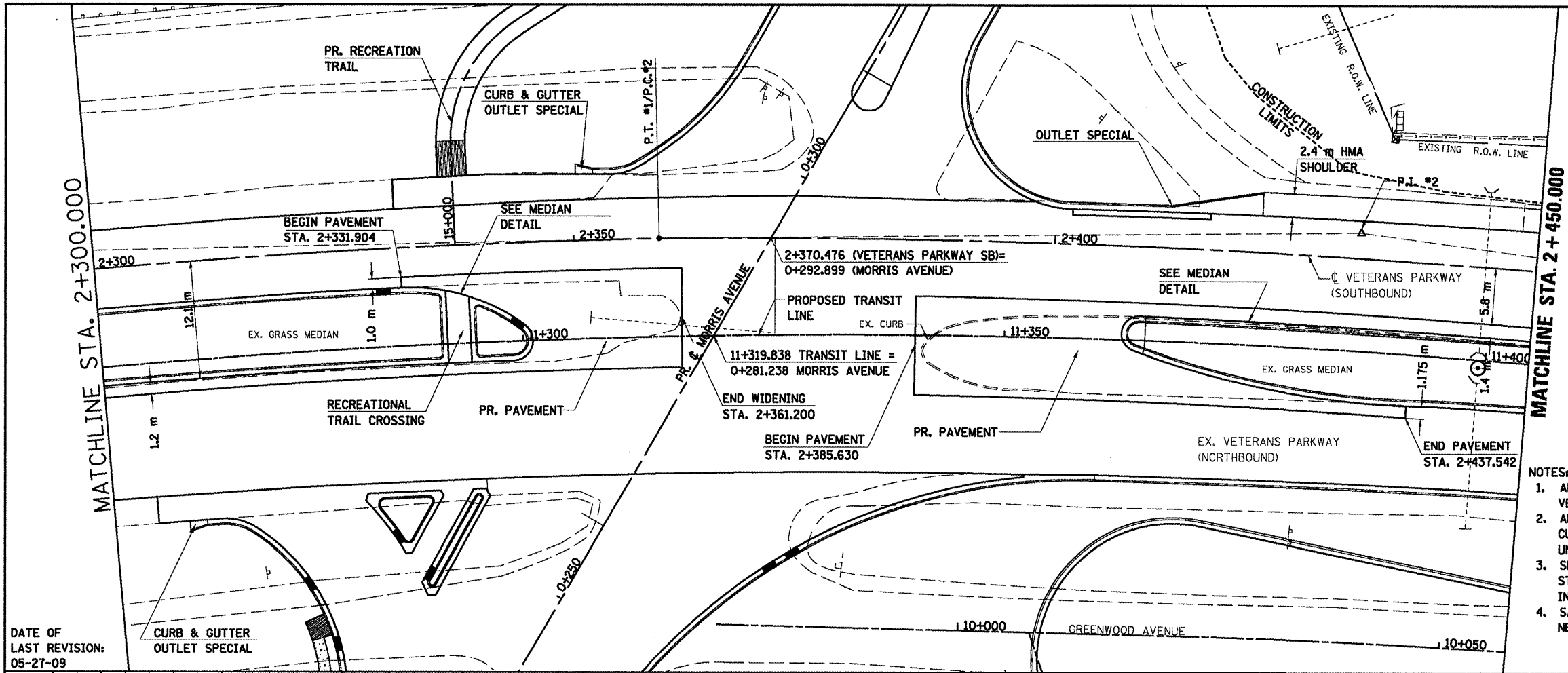

DATE OF LAST REVISION:  
05-27-09

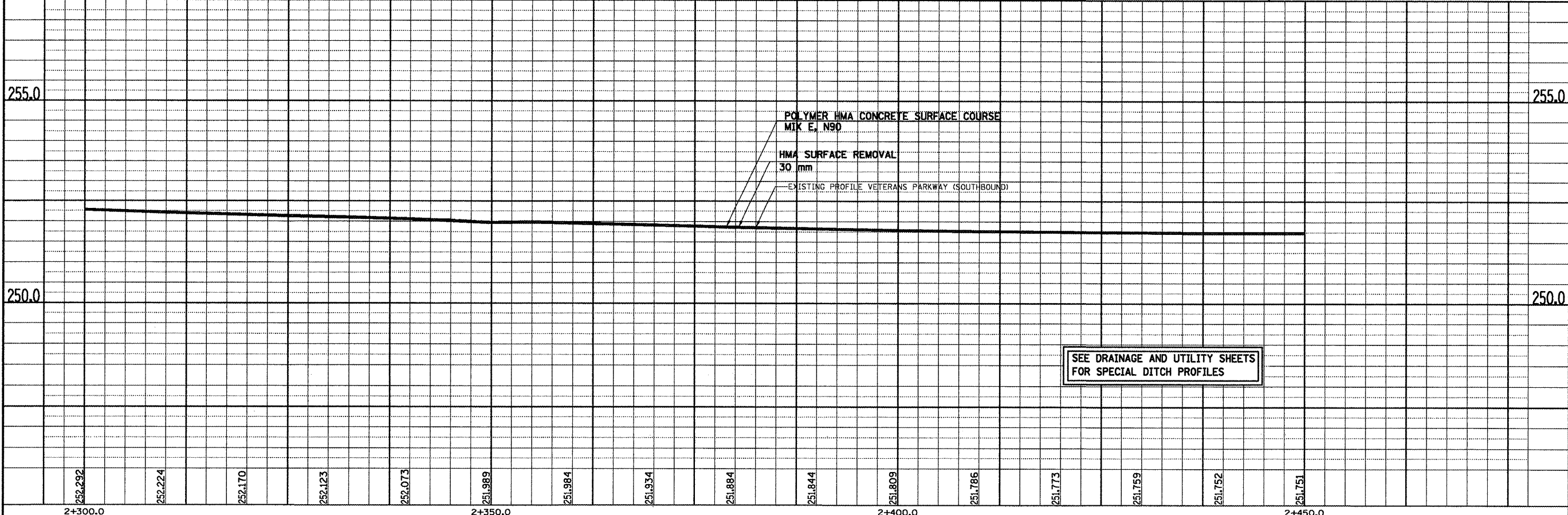

FINAL SURVEY	DATE
SURVEY PLOTTED	
NOTE BOOK TEMPLATE	
AREAS CHECKED	
NO.	

ORIGINAL SURVEY	DATE
SURVEY PLOTTED	
NOTE BOOK TEMPLATE	
AREAS CHECKED	
NO.	

VETERANS PARKWAY, PLAN & PROFILE, STA. 2 + 300.000 TO STA. 2 + 450.000