

F.A.P. RTE.	SECTION	COUNTY	TOTAL SHEETS	SHEET NO.
704	(LN & TS-1)	McLEAN	497	72
STA. 2+600.000		TO STA. 2+750.000		
FED. ROAD DIST. NO.		ILLINOIS FED. AID PROJECT		
		CONTRACT NO. 70514		

CVSB - 3  
 PI STA = 2+682.034  
 $\Delta = 22^\circ 45' 00''$  (RT)  
 R = 882.258 m  
 T = 177.494 m  
 L = 350.312 m  
 E = 17.677 m  
 $e = 1.5\% \pm$   
 T.R. = EXISTING  
 S.E. RUN. = EXISTING  
 P.C. STA = 2+504.540  
 P.T. STA = 2+854.852

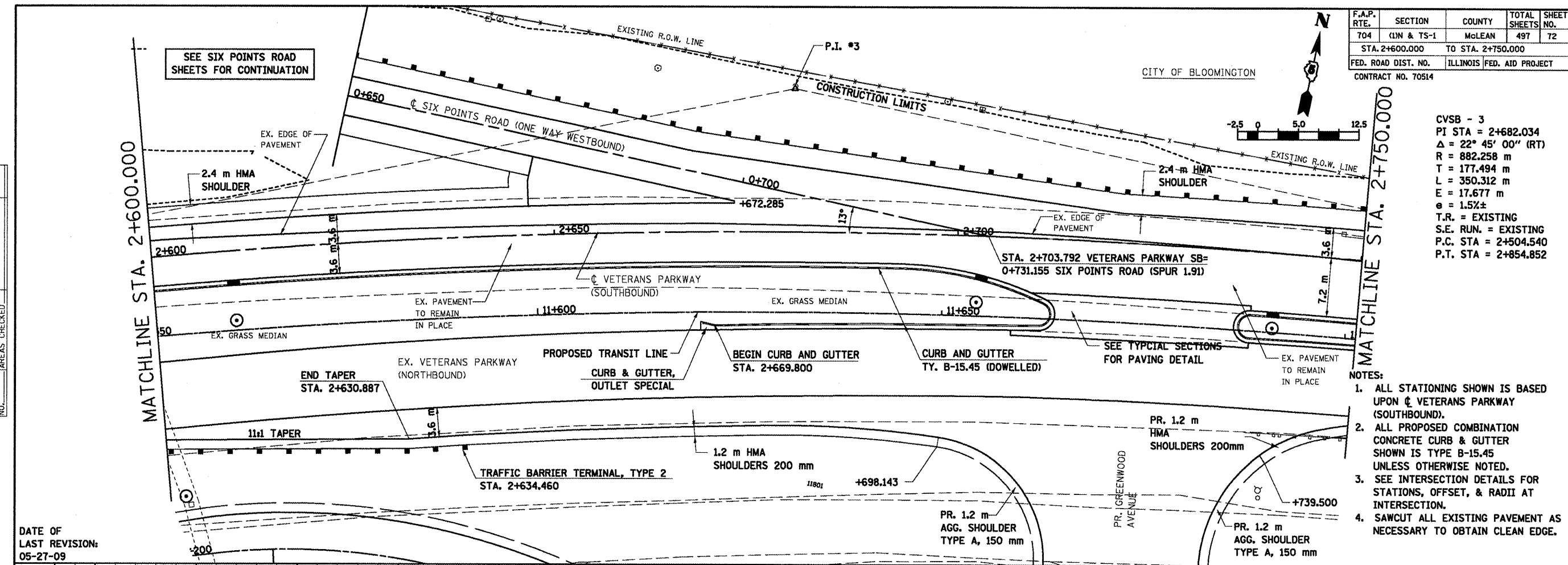

- NOTES:
1. ALL STATIONING SHOWN IS BASED UPON  $\text{\textcircled{C}}$  VETERANS PARKWAY (SOUTHBOUND).
  2. ALL PROPOSED COMBINATION CONCRETE CURB & GUTTER SHOWN IS TYPE B-15.45 UNLESS OTHERWISE NOTED.
  3. SEE INTERSECTION DETAILS FOR STATIONS, OFFSET, & RADII AT INTERSECTION.
  4. SAWCUT ALL EXISTING PAVEMENT AS NECESSARY TO OBTAIN CLEAN EDGE.

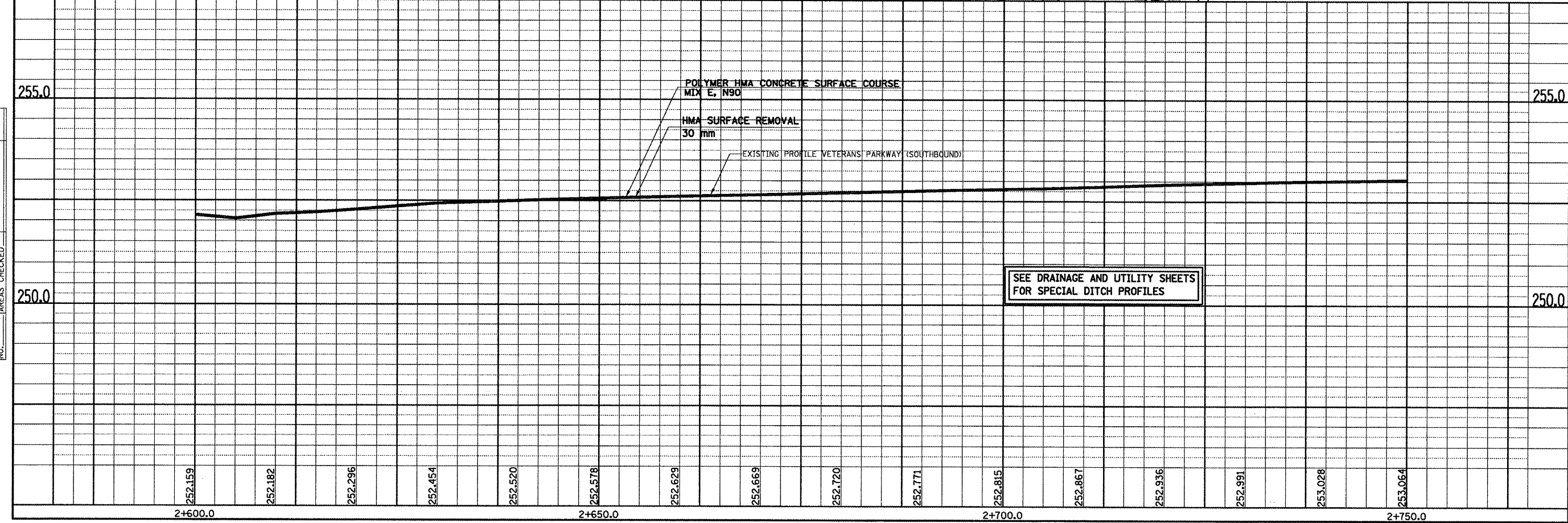

FINAL SURVEY PLOTTED	DATE
NOTE BOOK TEMPLATE AREAS CHECKED	
NO.	

ORIGINAL SURVEY PLOTTED	DATE
NOTE BOOK TEMPLATE AREAS CHECKED	
NO.	

DATE OF LAST REVISION: 05-27-09

VETERANS PARKWAY, PLAN & PROFILE, STA. 2+600.000 TO STA. 2+750.000