

F.A.P. RT.E.	SECTION	COUNTY	TOTAL SHEETS	SHEET NO.
704	(UN & TS-1)	McLEAN	497	93
STA. 10+600.000		TO STA. 10+745.000		
FED. ROAD DIST. NO.		ILLINOIS FED. AID PROJECT		
CONTRACT NO. 70514				

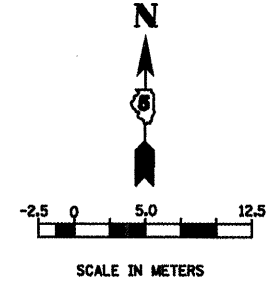

FINAL SURVEY PLOTTED	BY	DATE
NOTE BOOK TEMPLATE AREAS CHECKED		
NO.		

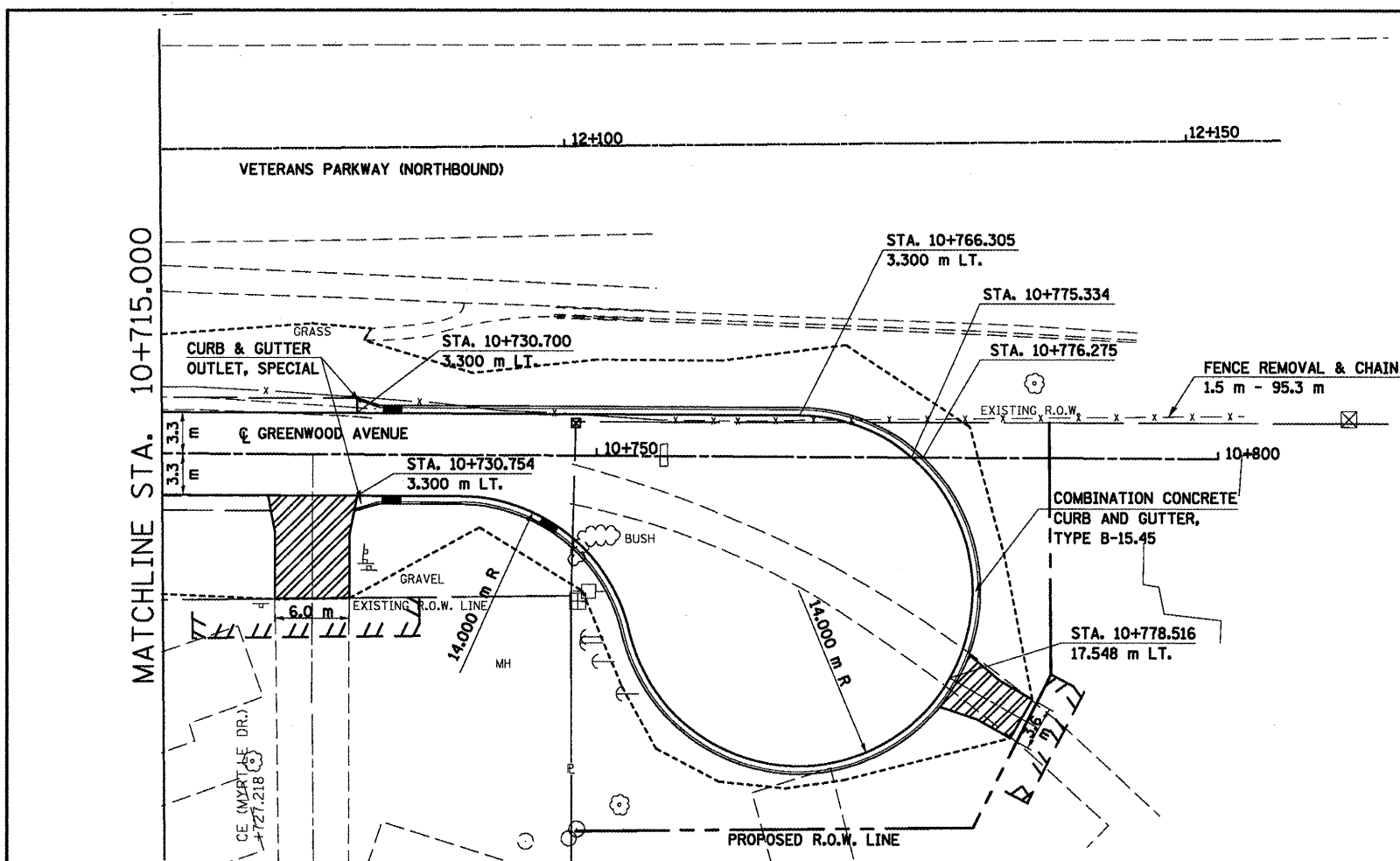

NOTES:  
 1. FOR EXISTING AND PROPOSED OFFSETS SEE R.O.W. PLAN SHEETS.

DATE OF LAST REVISION:  
 05-27-09

ORIGINAL SURVEY PLOTTED	BY	DATE
NOTE BOOK TEMPLATE AREAS CHECKED		
NO.		

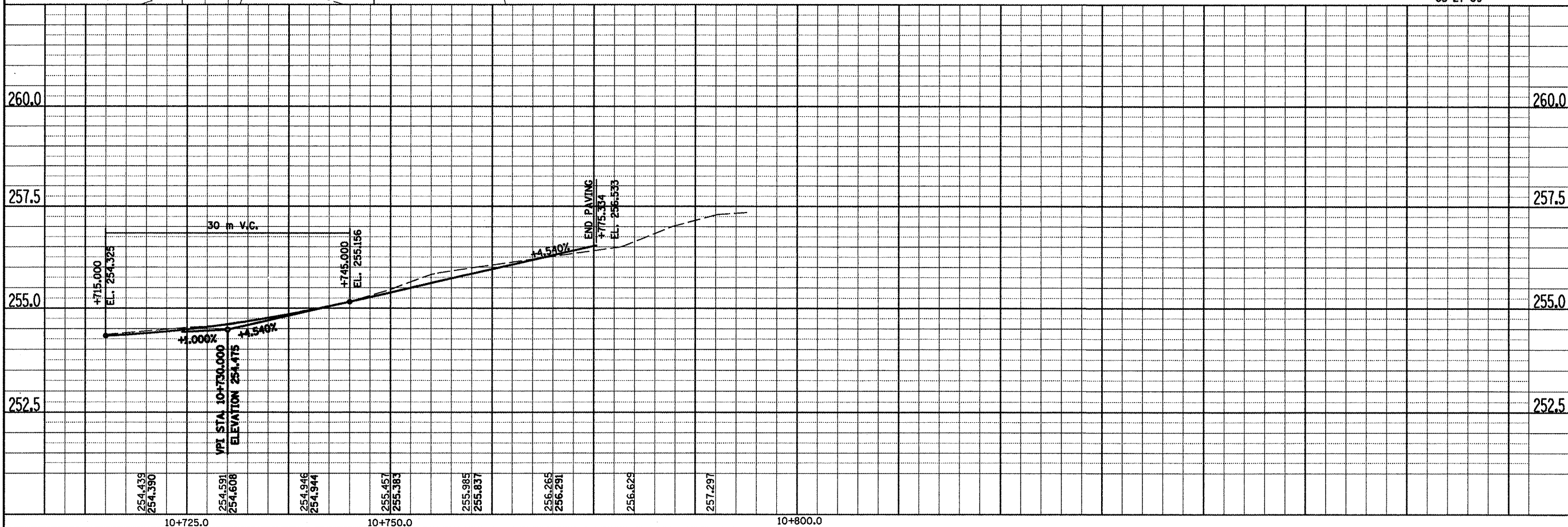

GREENWOOD AVENUE, PLAN & PROFILE, STA. 10 + 715.000 TO STA. 10 + 800.000