

F.A.P. RTE.	SECTION	COUNTY	TOTAL SHEETS	SHEET NO.
704	(LN & TS-1)	McLEAN	497	97
STA. 16+150.000		TO STA. 16+238.730		
FED. ROAD DIST. NO.		ILLINOIS FED. AID PROJECT		
CONTRACT NO. 70514				

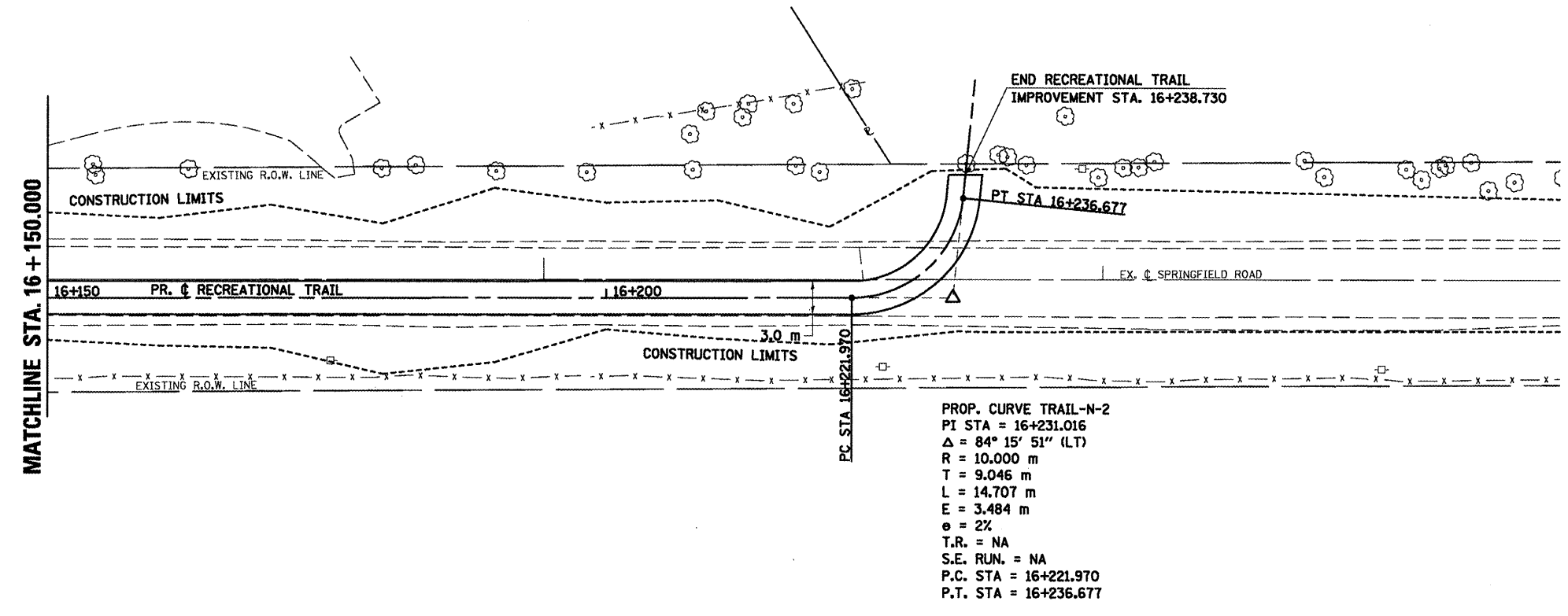
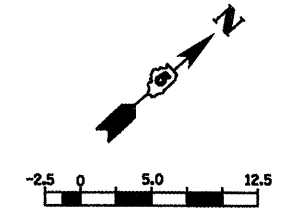

PROP. CURVE TRAIL-N-2  
 PI STA = 16+231.016  
 $\Delta = 84^\circ 15' 51''$  (LT)  
 R = 10.000 m  
 T = 9.046 m  
 L = 14.707 m  
 E = 3.484 m  
 $e = 2\%$   
 T.R. = NA  
 S.E. RUN. = NA  
 P.C. STA = 16+221.970  
 P.T. STA = 16+236.677

FINAL SURVEY PLOTTED	BY	DATE
NOTE BOOK TEMPLATE AREAS CHECKED		
NO.		

DATE OF LAST REVISION: 05-27-09

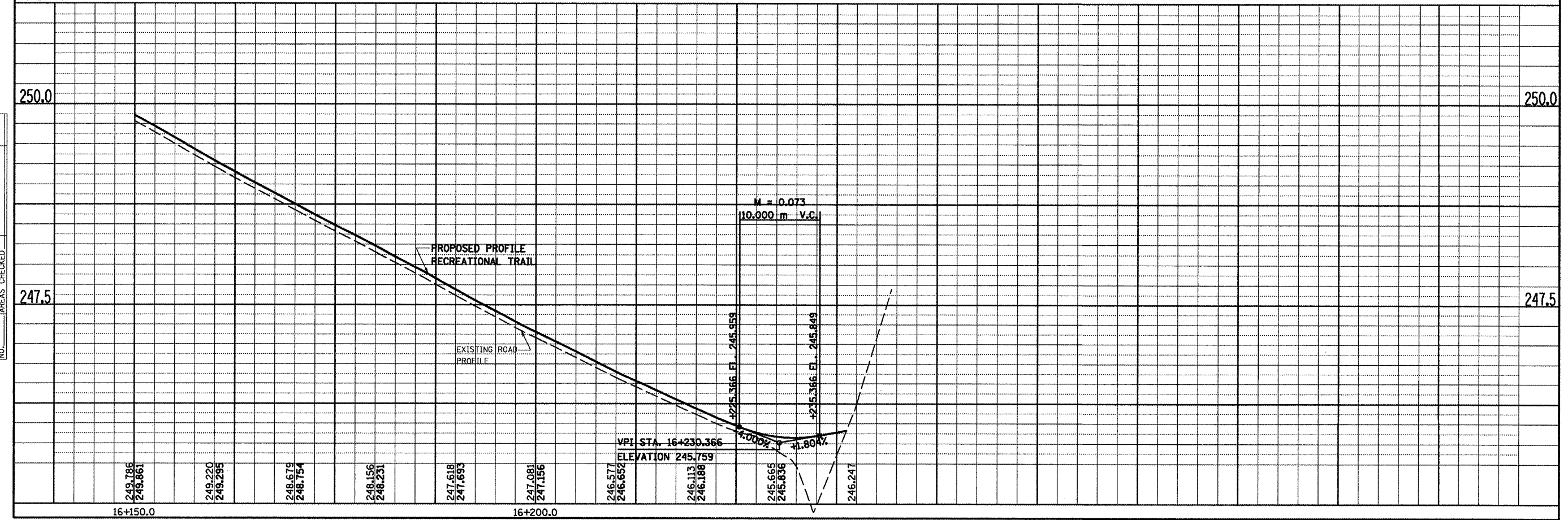

ORIGINAL SURVEY PLOTTED	BY	DATE
NOTE BOOK TEMPLATE AREAS CHECKED		
NO.		

RECREATIONAL TRAIL, PLAN & PROFILE, STA. 16 + 150.000 TO STA. 16 + 238.730